

Installation Instructions



C 32
C 32A

Contura

EC Declaration of conformity

Contura www.contura.eu

MANUFACTURER

Name NIBE AB/Contura
Address Box 134, Skulptörvägen 10, SE-285 23 Markaryd
Place of manufacture Markaryd, Sweden

PRODUCT

Product type Stove fired by solid fuel
Type designation Contura
Standard EN 13240 annex ZA
Intended for use Heating of living accommodation
Fuels Wood logs
Special conditions None

CE-MARKING

| | C32 | C32A |
|----------------------|-----------|-----------|
| Issued | 2009 | 2009 |
| Nominal output | 5 kW | 5 kW |
| Fuel type | Wood logs | Wood logs |
| Flue gas temperature | 270° C | 270° C |
| Energy efficiency | 80% | 80% |
| Emission of CO | 0,05% | 0,05% |

Appendix

Lighting and installation instructions



Niklas Gunnarsson
Business area manager NIBE STOVES



Manufacturer's declaration

The stove is approved by the Swedish National Testing and Research Institute, SP SITAC and fulfils the applicable rules for CE labelling. Manufacture of the product has taken place in accordance with those documents that are the basis for the relevant type approval certification and the required manufacturing checks.



Contura 32/32A is a Swan-labelled wood burning stove.

NIBE was the first stove manufacturer in Sweden to commit to Swan labelling stoves. The Swan label is one aspect of our vision to be a company of the future, setting high quality standards regarding the environment. Certification number 378-001.

A warm welcome to Contura.

A warm welcome to the Contura family. We hope you will get a great deal of pleasure from your new stove. As a new owner of a Contura stove, you have secured a product with timeless design and long service life. Contura also has a combustion process that is both environmentally friendly and efficient, for the best heat production.

Read through these installation instructions carefully before installation. Read how to best light your stove in the lighting instructions.

List of Contents

| | |
|--|----|
| Technical details | 68 |
| Installation distance to walls and ceiling | 69 |
| Supply of combustion air | 70 |
| Self-closing door | 71 |
| Connection to chimney | 72 |
| Installation of surround | 74 |
| Installing accessories · base | 76 |
| Installing accessories · drawer | 77 |
| Installing accessories · log box | 79 |

NOTE!

Report the installation of a stove to your local authority.

The owner of the house is personally responsible for ensuring compliance with the mandatory safety requirements and must have the installation approved by a qualified inspector. Your local chimney sweep must also be informed of the installation, as this will affect the routines for regular chimney-sweeping services.

WARNING!

The stove becomes very hot

During operation, certain surfaces of the stove become very hot and can cause burn injuries if touched. Also, take heed of the strong heat radiated through the door glass. Placing flammable material closer than the safe distance indicated may cause a fire. Smoulder combustion can cause quick gas ignition with the risk of damage to property and personal injury.

Technical details

| | |
|----------------|--------|
| Output | 3-7 kW |
| Nominal effect | 5 kW |
| Efficiency | 80% |

| Model | 32 | 32A |
|-------------|------|------|
| Weight (kg) | 128 | 128 |
| Width (mm) | 480 | 480 |
| Depth (mm) | 450 | 450 |
| Height (mm) | 1025 | 1025 |

Type approved in accordance with:
European standard EN-13240
Swedish environmental and quality labelling,
P-labelling cert. no. 0112/07
Norwegian standard NS 3059,
SINTEF 110-0275
German standard DIN 18.891,
RRF-40 07 13 90

Important to remember!

Installation by authorised technician

This manual contains instructions about how the stoves must be assembled and installed. To ensure the function and safety of the stove, we recommend that the installation is carried out by an authorised technician. Contact one of our dealers who can recommend suitable fitters.

Building permission

These main instructions may give guidance which would contravene national building regulations. Please refer to supplementary instructions or ask your local authority for advice regarding building regulations. Before installing a stove or erecting a chimney it is necessary for you to make a building permission application to your local authority.

Structural support

Check that the wood joists are strong enough to bear the weight of the stove and chimney. The stove and chimney can usually be placed on a normal wooden joist in a single occupancy house, if the total weight does not exceed 400 kg.

Floor plate

Due to the risk of falling embers, a flammable floor must be protected by a hearth plate. It must extend 300 mm in front of the stove and 100 mm on each side of the stove, or have a 200 mm extension on each side of the opening. The hearth plate can consist of natural stone, concrete, metal plate or glass. A painted metal or glass hearth plate is available as an accessory for these models.

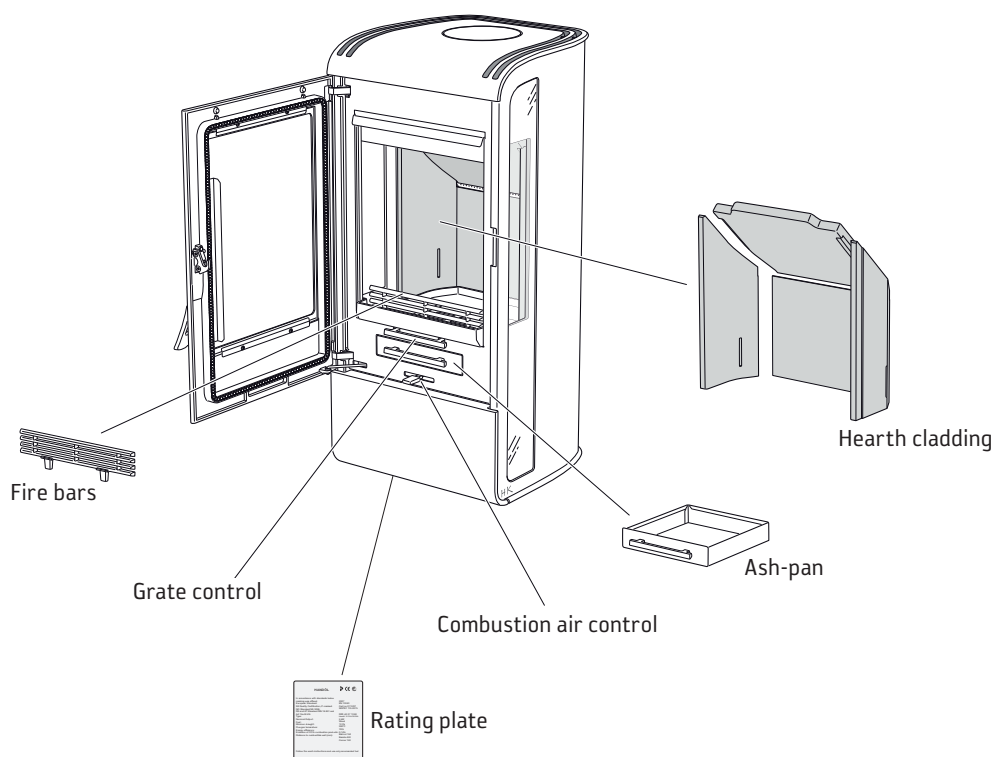

Installation distance to walls and ceiling

C32/C32A

Combustible roof

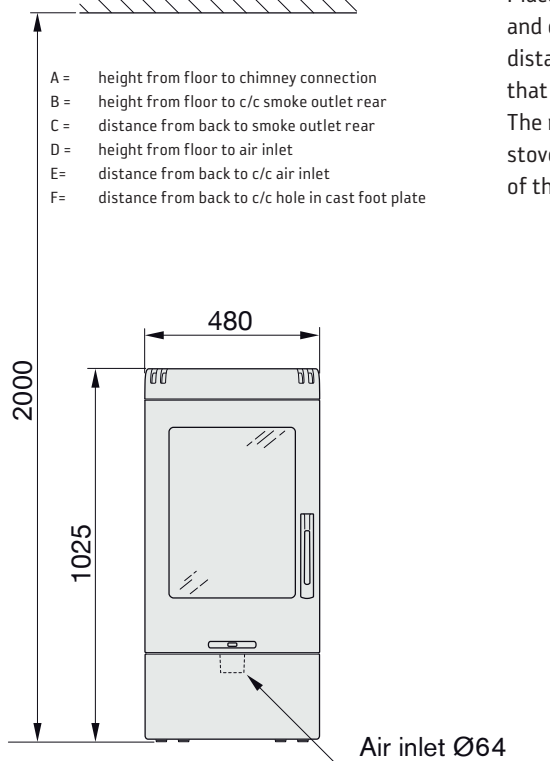

Place the stove on the hearth plate and check that the installation distances are not less than those that are given in the figures below. The minimum distance in front of the stove opening to combustible parts of the building or interior decoration

must be at least 1 m. When top connecting a steel flue, please refer to the particular manufacturer's installation instructions. Observe the safety distance to combustible material that the steel flue requires.

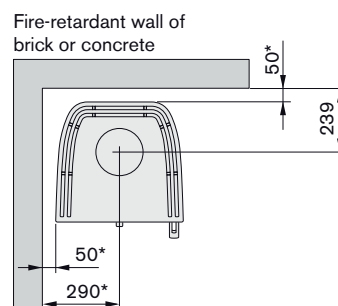
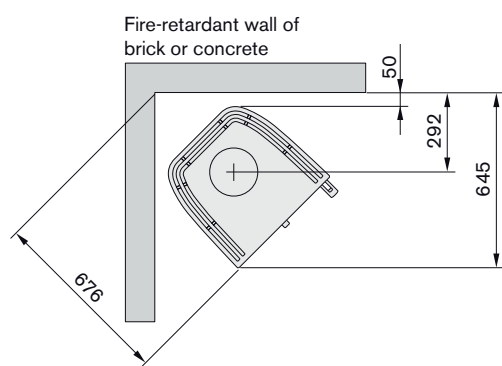
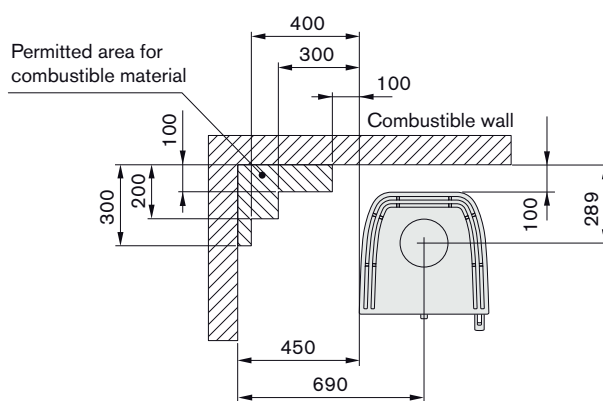
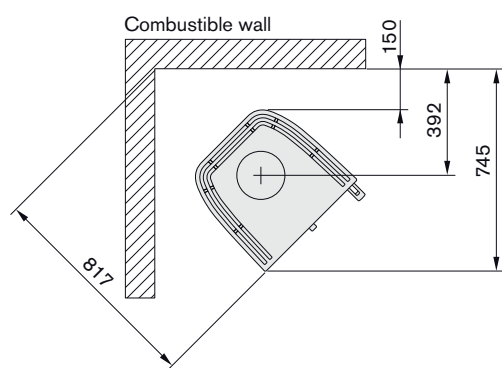
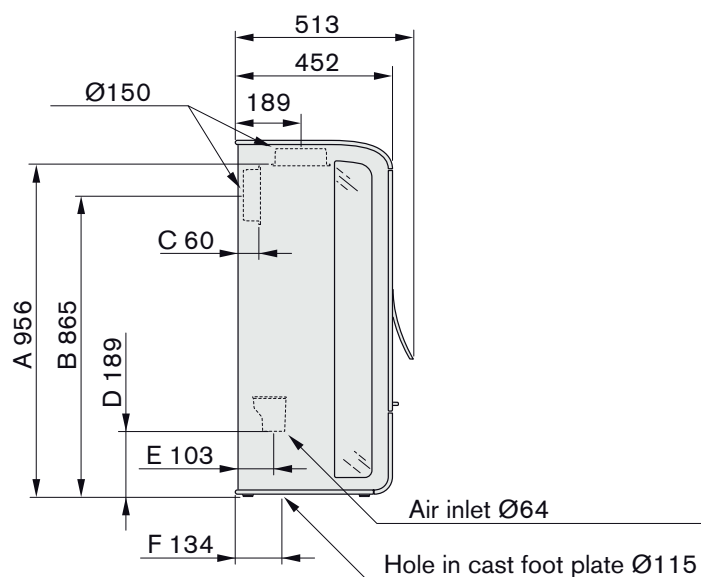

*To prevent discolouration of painted fire walls, we recommend the same side distance as to combustible walls.

Supply of combustion air

Combustion air can be provided directly via a duct from outside, or indirectly via a vent in the outer wall of the room where the stove is placed. The amount of combustion air that is used for combustion is approx. 25 m³/h.

Some installation alternatives are shown to the right. The air duct connector on the stove has an external diameter of Ø64 mm.

In hot areas, the duct has to be insulated with 30 mm mineral wool covered with a moisture barrier (plastic). It is important that the lead-in, between the pipe and the wall (or floor), is sealed using jointing compound. When duct routing for further than 1 m, the pipe diameter must be increased to 100 mm and a correspondingly larger wall vent must be selected.

A 1 m length of condensation-insulated ducting for combustion air is available as an accessory.

Knockout

To insert the combustion air hose, tap out the knockout from the floor panel and leg using a hammer, remember to protect the floor.

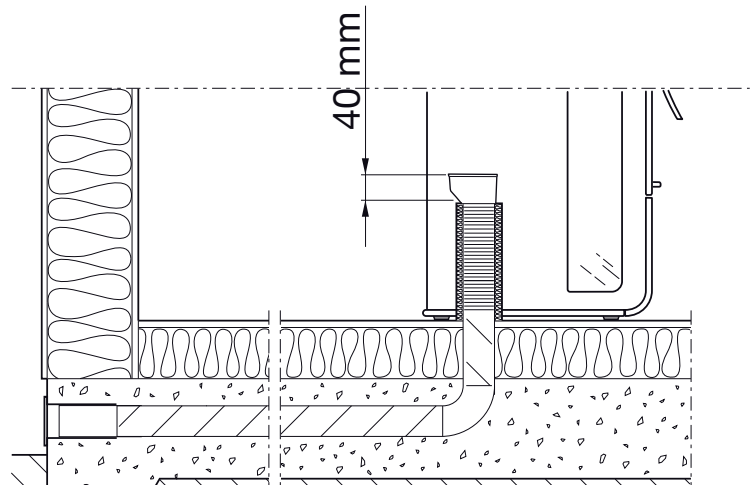
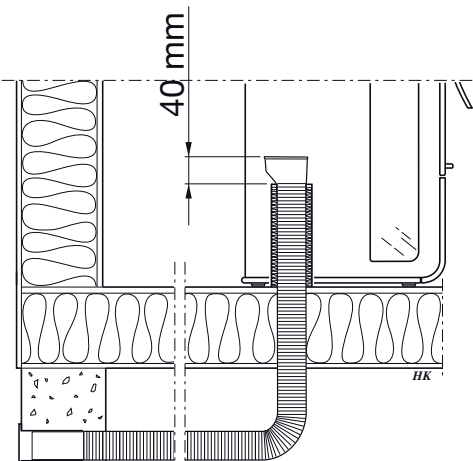
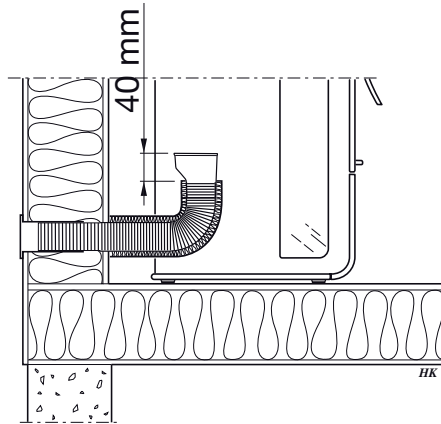
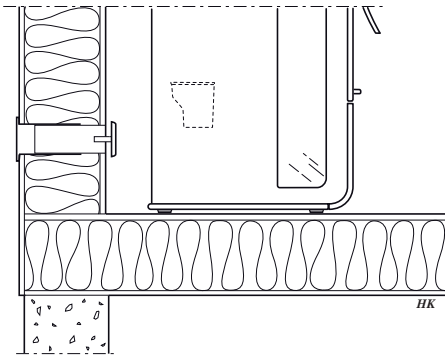
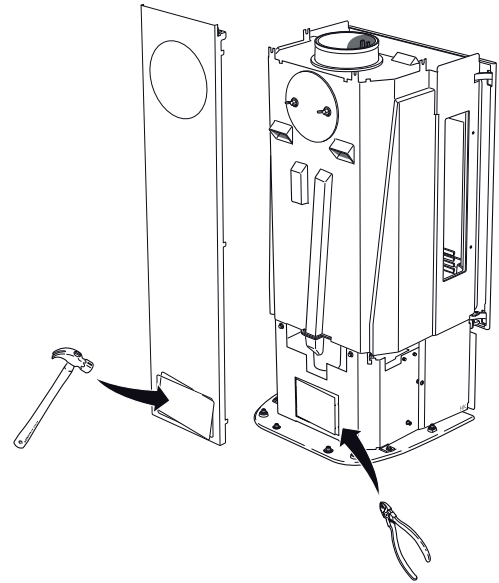

Self-closing door

The stove is equipped with a spring to close the door automatically. The spring is situated above the heat deflector. The closing force of the hatch can be adjusted by moving the spring between the three notches on the lever. After adjustment, the heat deflector must be reinstalled. The angle of the stove also affects the closing force of the spring.

If the spring force seems weak despite the spring being mounted at the end of the lever, the angle of the stove should be checked.

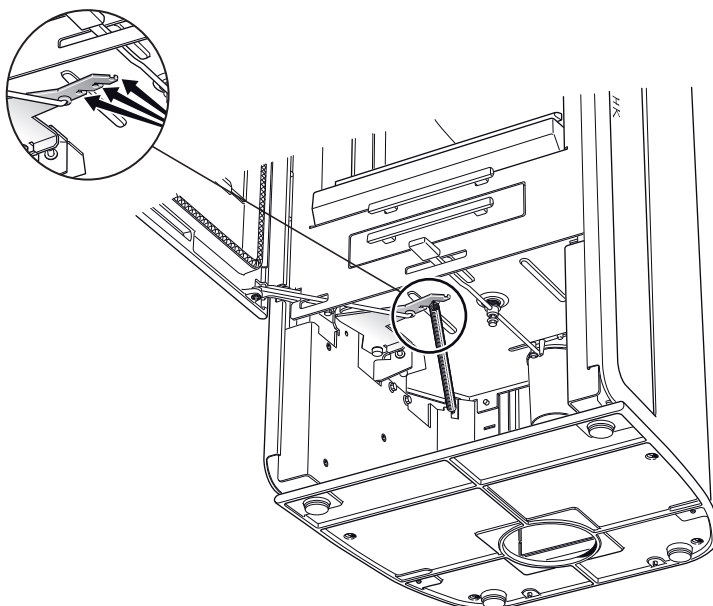
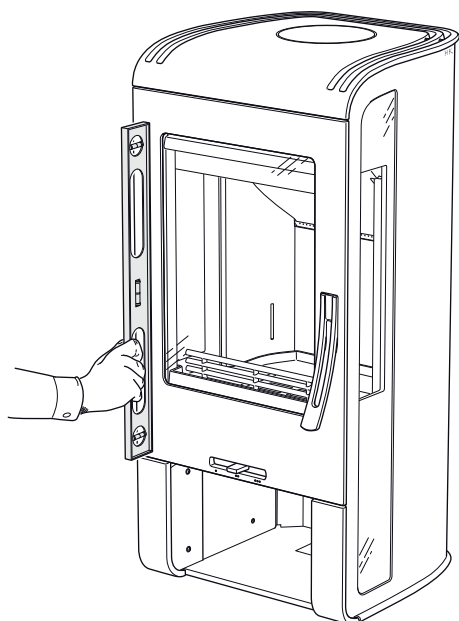

Heat deflector

The heat deflector is removed by lifting the front edge and then pulling it out slightly. Lower it so that it is below the insert and then withdraw it. Assembly takes place in the reverse order. Ensure that the rear lugs are secured in the slits on the upper leg as illustrated above.

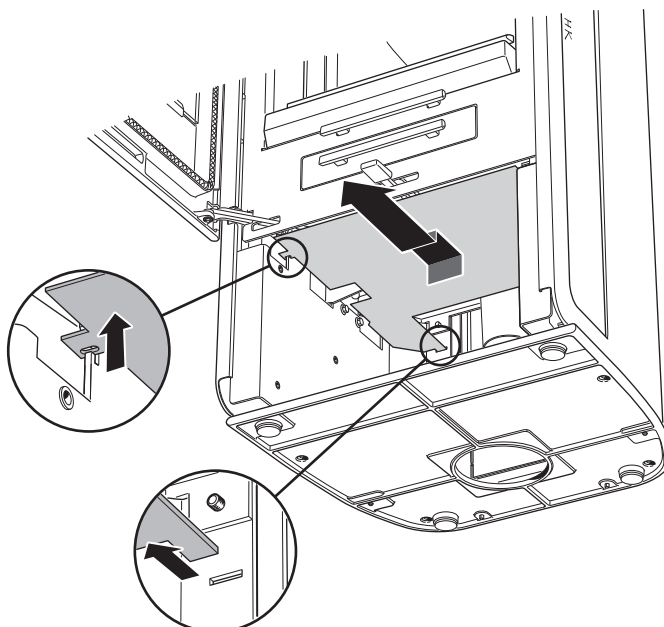

Connection to chimney

- The stove meets the requirements for connecting to chimneys dimensioned for flue gas temperatures of 350°C.
- The external diameter of the connection sleeve is 150 mm.
- The stove requires a draft in the chimney of at least -12 Pa. The draft is affected both by the length and area of the chimney, and by how well sealed it is. The minimum recommended chimney length is 3.5 m and suitable cross-sectional area is 150-200 cm² (140-160 mm in diameter).
- A flue with sharp bends and horizontal routing reduces the draught in the chimney. The maximum horizontal flue is 1 m, on the condition that the vertical flue length is at least 5 m.
- It must be possible to sweep the full length of the flue and the soot doors must be easily accessible.
- Carefully check that the chimney is sealed and that there is no leakage around soot doors and flue connections.

Rear connection to a masonry chimney

The back panel must be installed before the stove is connected at the rear.

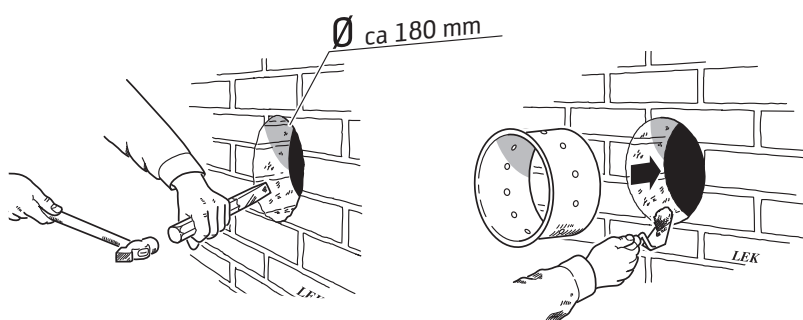

In the bag with these installation instructions are two wing screws for the lid.

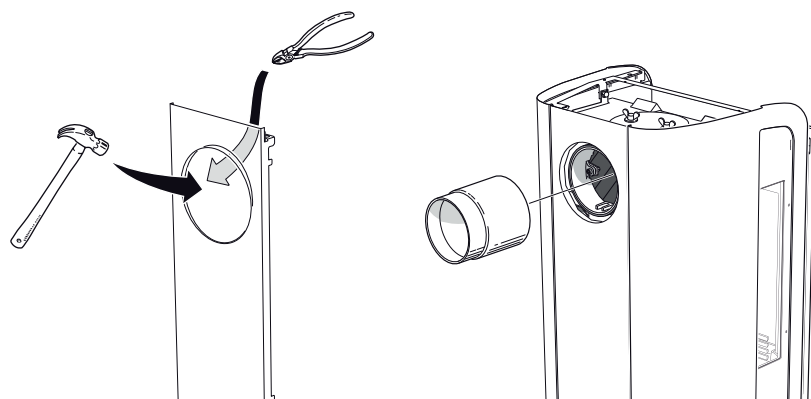
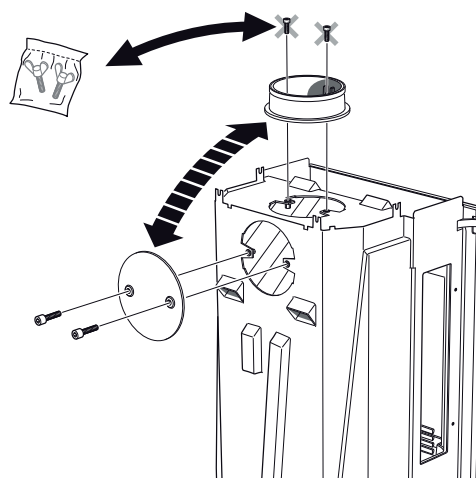

Make sure that the connector gasket does not work loose when the connection pipe is placed on the connector. If further sealing material is required, heat-resistant sealant may be used.

Top connection to the chimney

The hot air grille must be installed before chimney top connection.

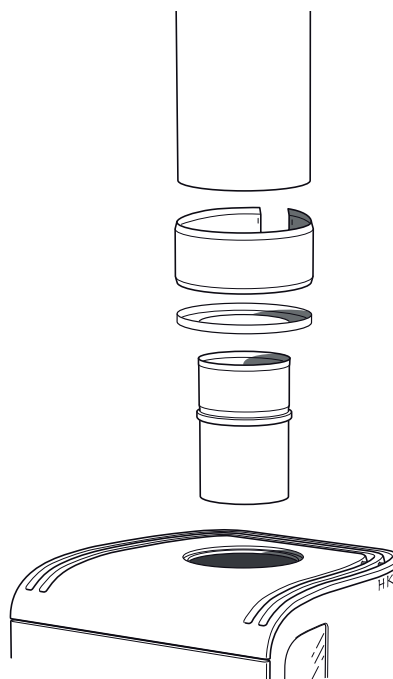

Sweeping

When sweeping, the smoke baffle must be removed; on the Contura 30 series this can be done by lifting the smoke baffle and removing the side piece. Lift the smoke baffle out and remove the remaining sections. Handle the parts with care.

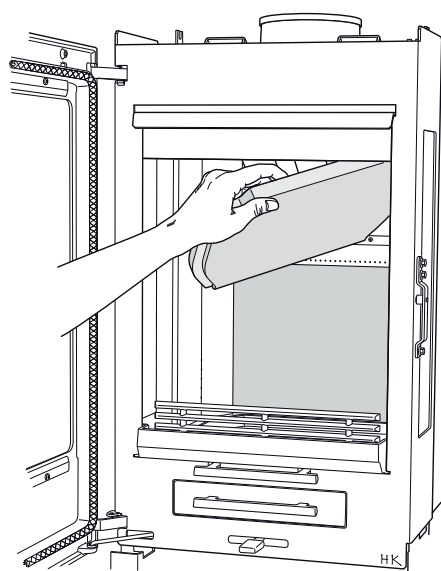
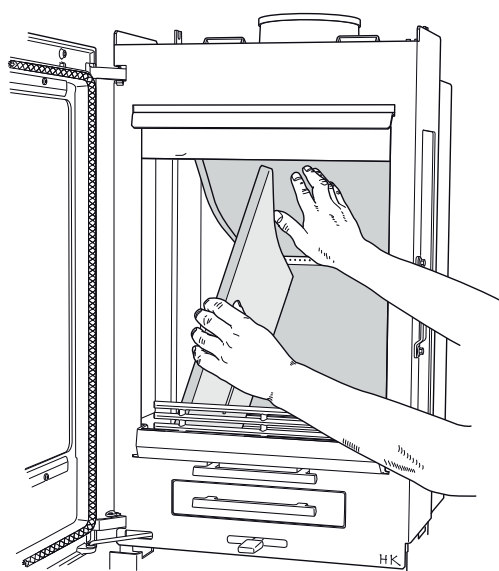

Installation of surround

Rating plate

Place the rating plates on the lower heat deflector as illustrated. On the model with the drawer, the type plates can be mounted inside the drawer.

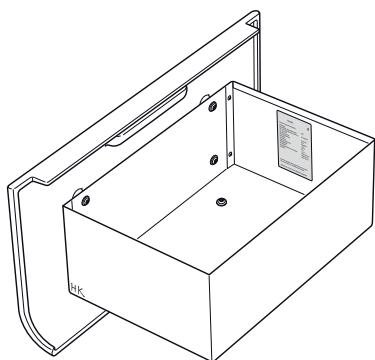
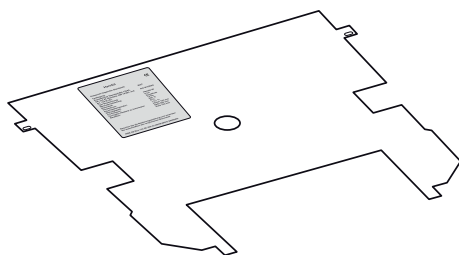

Clean the side glass thoroughly before installing the side panels

1

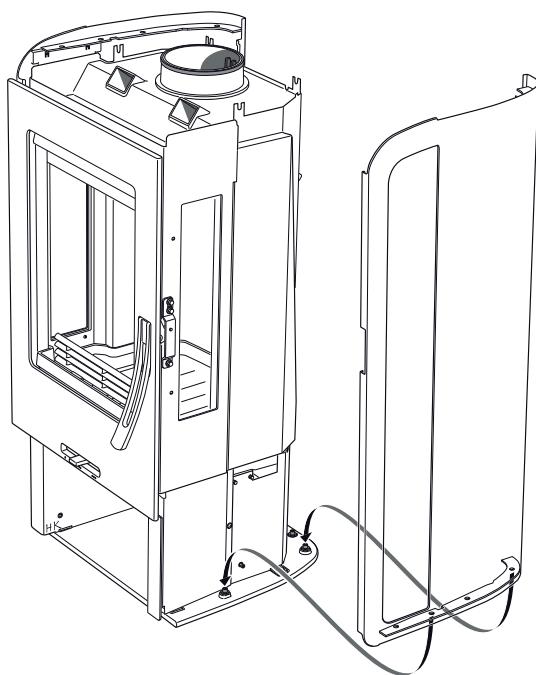

Hold the plates so that they do not tip and become damaged.

The aluminium model

Important: Remove the protective plastic from along the bent edge before installing the back panel.

Remove the protective plastic when the stove is assembled. It is important to remove all the protective plastic.

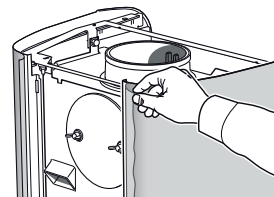

Ensure that your hands are clean to avoid leaving marks on the aluminium sides.

Cleaning

Cleaning must always be carried out with care and on cold panels. Wipe with a damp cloth and dishwashing detergent and wipe dry using a clean and dry cotton cloth. For tougher marks, stainless steel cleaning agent can be used.

2

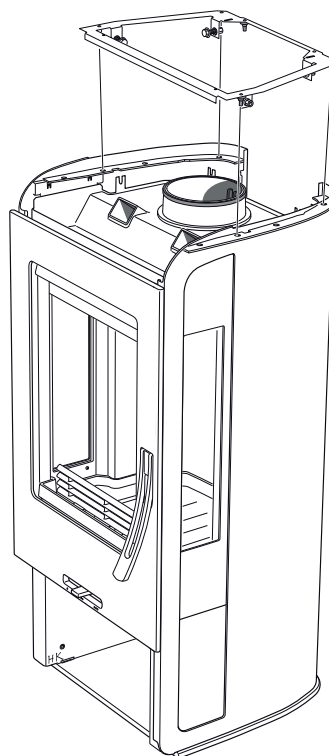

3

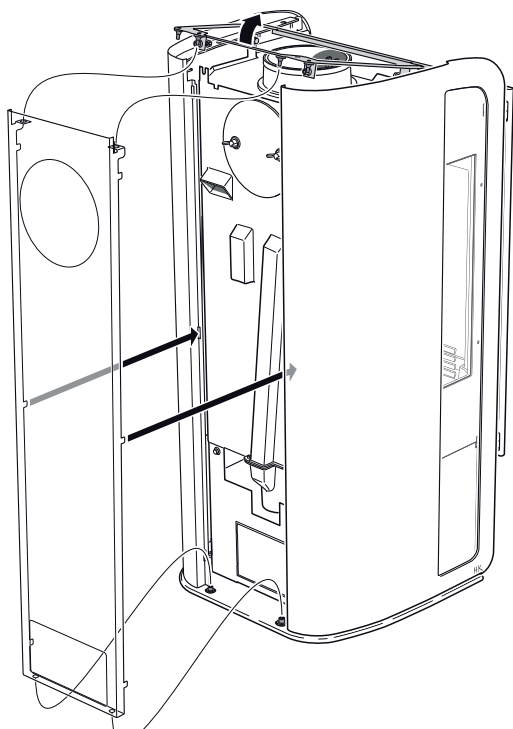

4

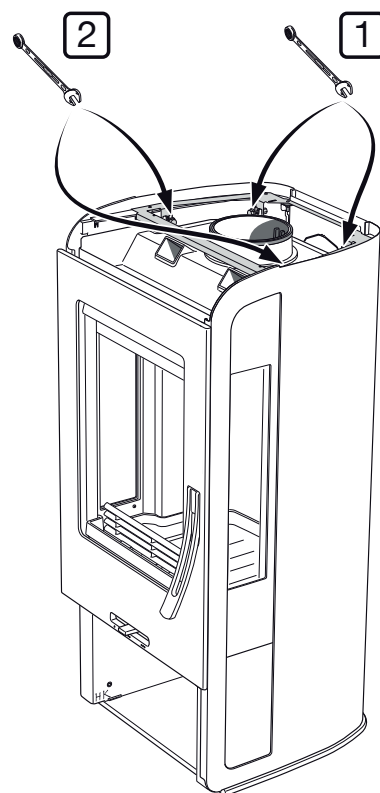

5

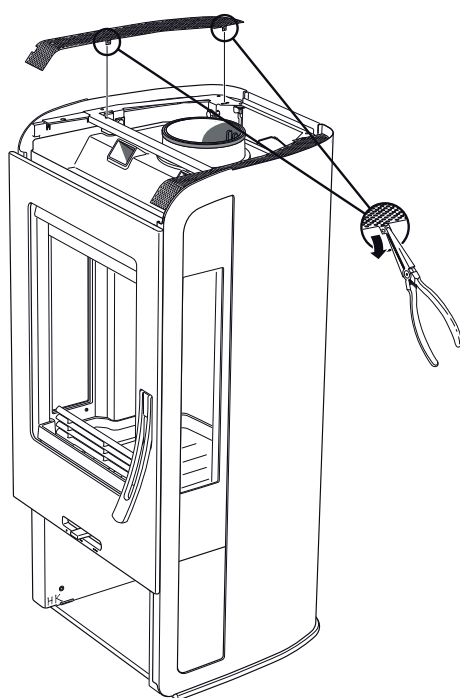

6

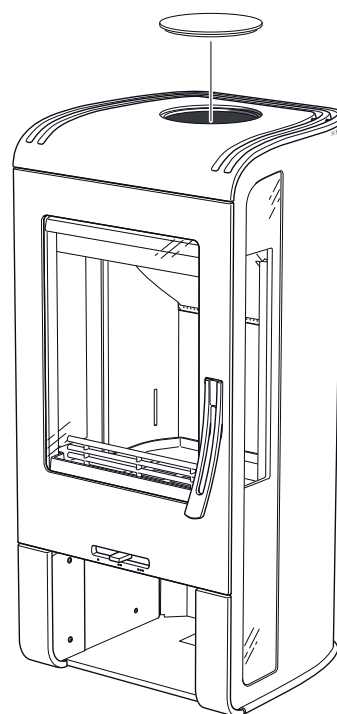

Final inspection of the installation



It is extremely important that the installation is inspected by an authorised chimney sweep before the stove is used. Also read the "Lighting instructions", before lighting for the first time.

Installing accessories · Base

Base

1

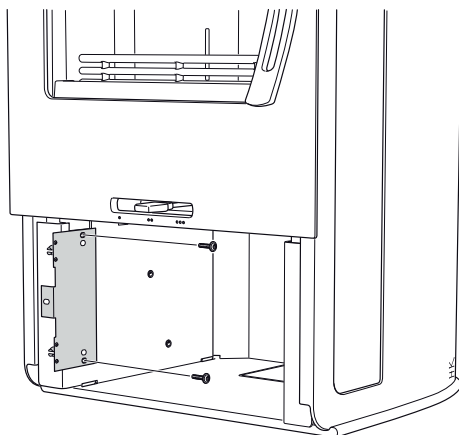

2

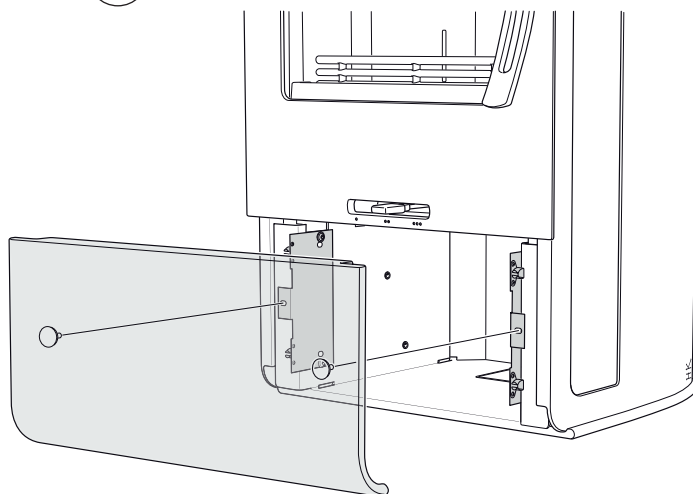

When installing the base, the lower knockout in the back panel must always be removed for the supply of convection air.

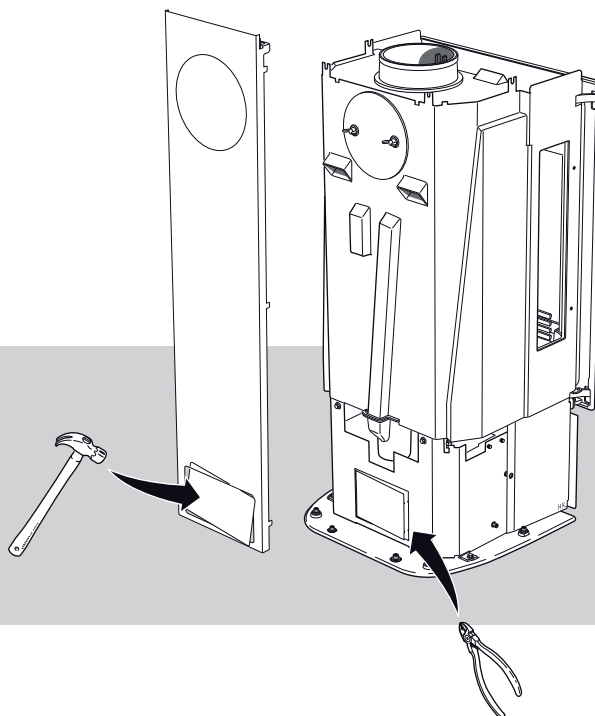

Installing accessories · Drawer

Drawer

1

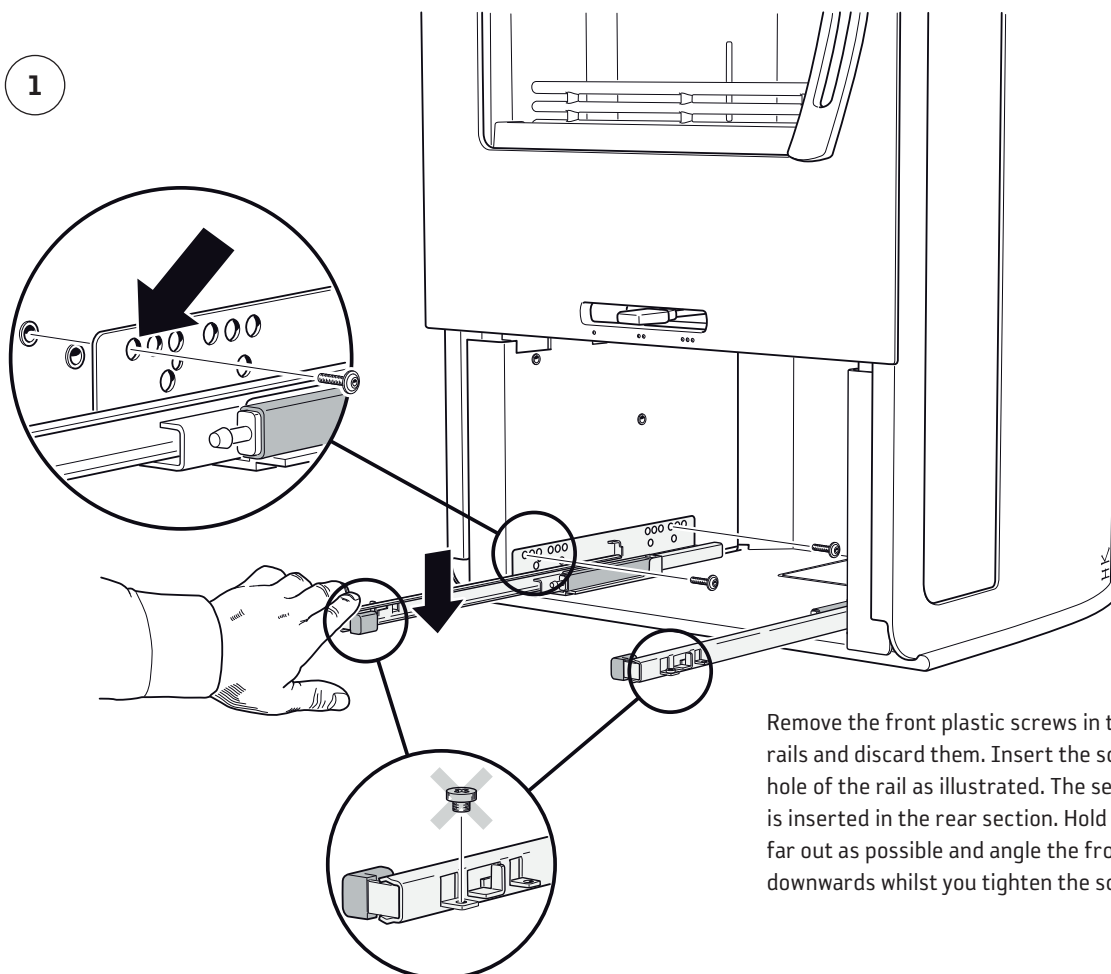

Remove the front plastic screws in the drawer rails and discard them. Insert the screws in the hole of the rail as illustrated. The second screw is inserted in the rear section. Hold the rail as far out as possible and angle the front section downwards whilst you tighten the screws.

When installing the drawer, the lower knockout in the back panel must always be removed for the supply of convection air.

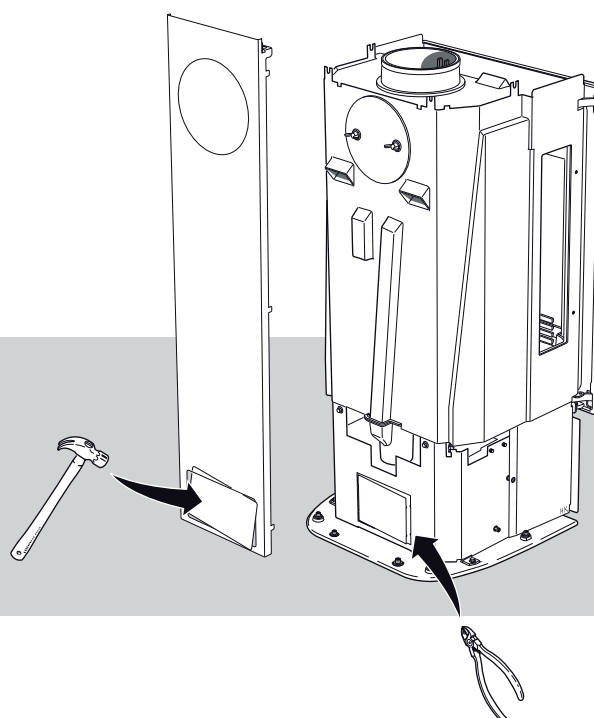

2

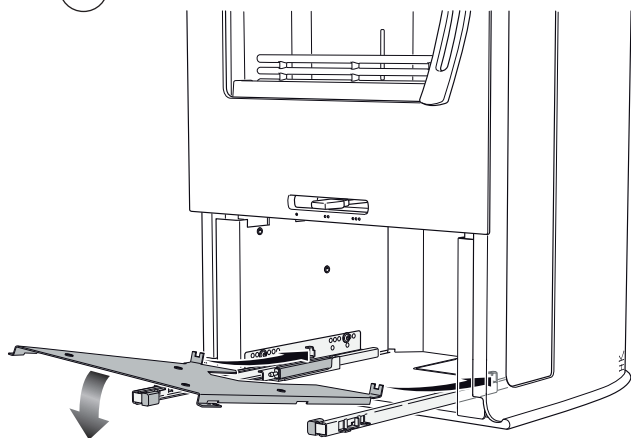

3

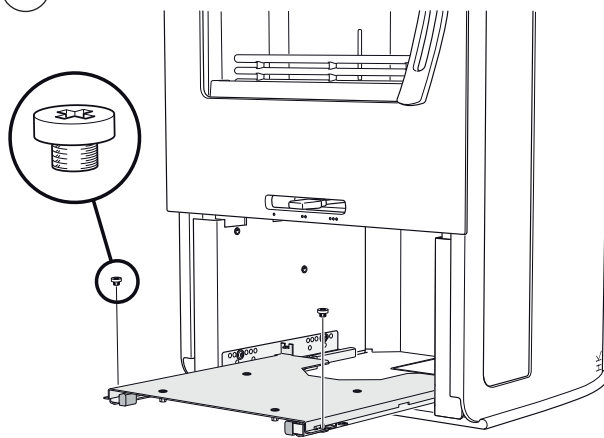

4

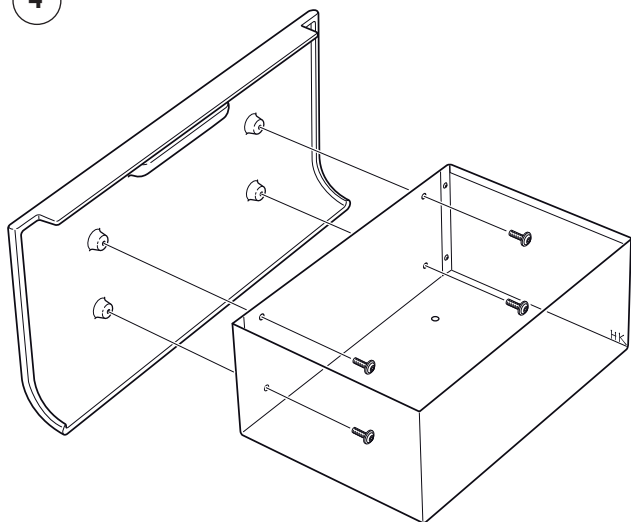

5

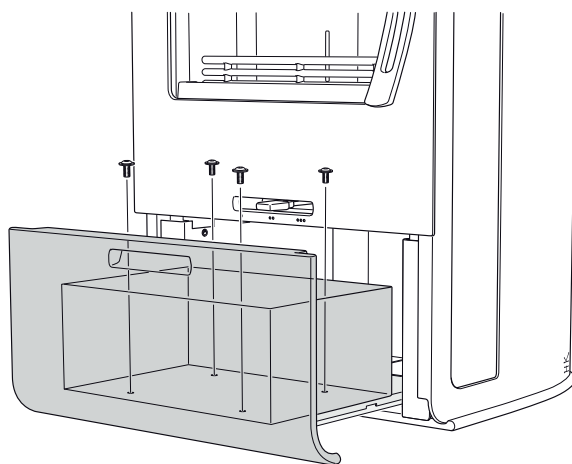

Adjust the drawer so that it is centrally positioned in relation to the hatch and then tighten the screws.

Installing accessories · Log box

Log box

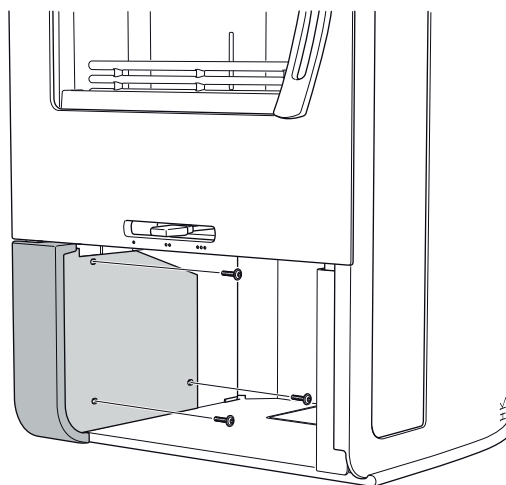
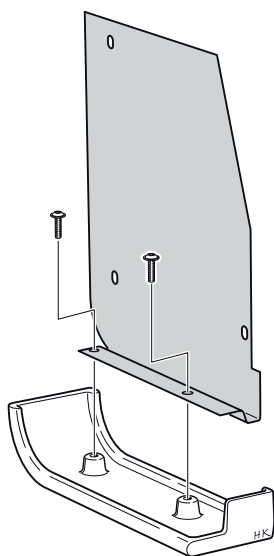

Adjust the pieces with the Allen screws so that they are in line with the hatch.

Contura

NIBE AB · Box 134 · 285 23 Markaryd · Sweden
www.contura.eu

Contura reserves the right to change colours, materials,
dimensions and models at any time without special notice.
Your dealer can provide you with the latest information.