

Installation instruction

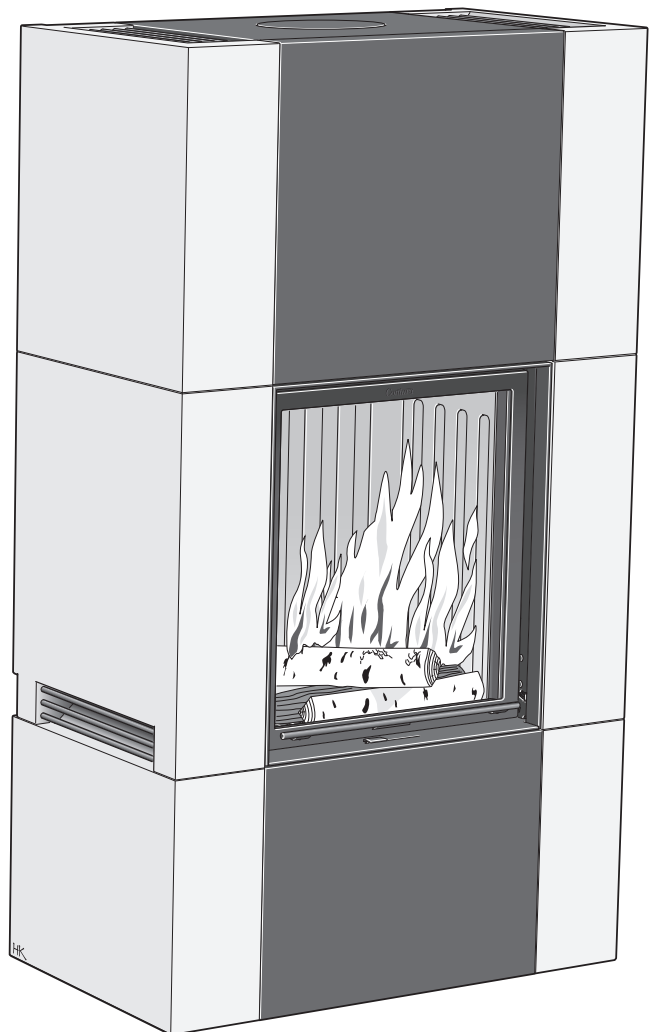
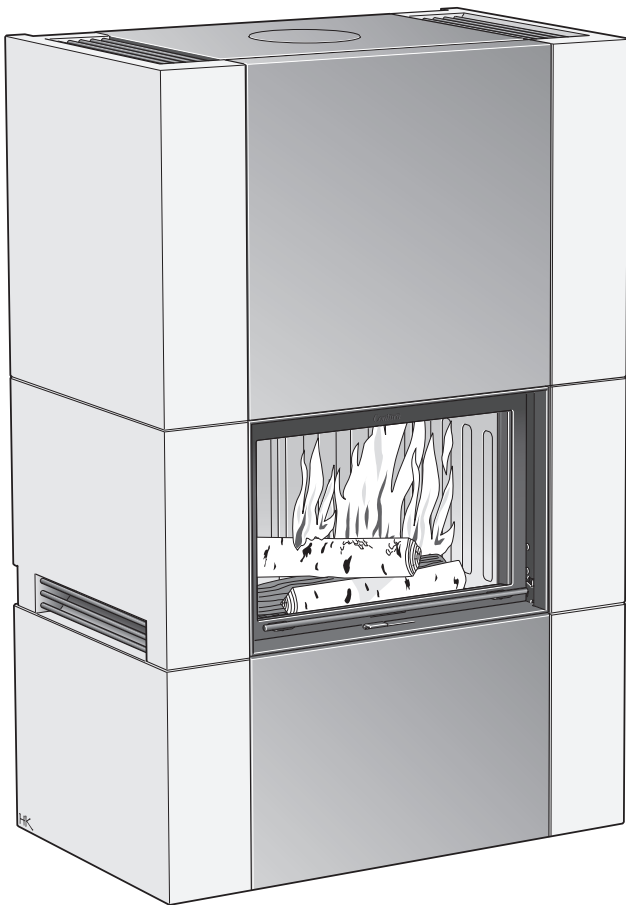

Surround C 11
Surround C 21

Contura

PERFORMANCE DECLARATION

No. C11-CPR-130614-SE-1

Contura

PRODUCT

Product type Stove lit with solid biofuels
 Type designation Contura 11
 Manufacturing number See rating plate on the stove
 Intended area of use Heating of rooms in residential buildings
 Fuel Wood

MANUFACTURER

Name NIBE AB / Contura
 Address Box 134, Skulptörvägen 10
 SE-285 23 Markaryd, Sweden

CHECKS

According to AVCP System 3
 European standard EN 13240:2001 / A2:2004
 Test institute Rein-Ruhr Feuerstätten Prüfstelle, NB 1625,
 has checked declared performance and issued test report no. RRF-40 09 2080

DECLARED PERFORMANCE

Essential characteristics	Performance	Harmonised technical specification
Reaction to fire	A1 WT	EN 13240:2001 / A2:2004
Minimum distance to combustible material	No minimum distance to rear 400 mm to side Other safety distances according to the installation instructions	
Risk of falling embers	Approved	
Emissions from combustion	CO 0.09% NOx 109 mg/m ³ OGC 50 mg/m ³ PM 29 mg/m ³	
Surface temperatures	Approved	
Cleaning options	Approved	
Mechanical durability	Approved	
Emissions of hazardous substances	Approved	
Nominal output	9 kW	
Efficiency	81%	
Flue gas temperature in connector at nominal output	290°C	

The undersigned is responsible for the manufacture and conformity with the declared performance.



Niklas Gunnarsson, Business area manager NIBE STOVES
 Markaryd, 1st July 2013



PERFORMANCE DECLARATION

No. C21-CPR-130614-SE-1

Contura

PRODUCT

Product type Stove lit with solid biofuels
 Type designation Contura 21
 Manufacturing number See rating plate on the stove
 Intended area of use Heating of rooms in residential buildings
 Fuel Wood

MANUFACTURER

Name NIBE AB / Contura
 Address Box 134, Skulptörvägen 10
 SE-285 23 Markaryd, Sweden

CHECKS

According to AVCP System 3
 European standard EN 13240:2001 / A2:2004
 Test institute Rein-Ruhr Feuerstätten Prüfstelle, NB 1625,
 has checked declared performance and issued test report no. RRF-40 09 1081

DECLARED PERFORMANCE

Essential characteristics	Performance	Harmonised technical specification
Reaction to fire	A1 WT	EN 13240:2001 / A2:2004
Minimum distance to combustible material	No minimum distance to rear 400 mm to side Other safety distances according to the installation instructions	
Risk of falling embers	Approved	
Emissions from combustion	CO 0.07% NOx 99 mg/m ³ OGC 42 mg/m ³ PM 29 mg/m ³	
Surface temperatures	Approved	
Cleaning options	Approved	
Mechanical durability	Approved	
Emissions of hazardous substances	Approved	
Nominal output	10 kW	
Efficiency	81%	
Flue gas temperature in connector at nominal output	330°C	

The undersigned is responsible for the manufacture and conformity with the declared performance.



Niklas Gunnarsson, Business area manager NIBE STOVES
 Markaryd, 1st July 2013



A warm welcome to Contura

A warm welcome to the Contura family. We hope you will get a great deal of pleasure from your new stove. As a new owner of a Contura stove you have secured a product with timeless design and long service life. Contura also has combustion that is both environmentally friendly and efficient for the best heat production.

Read through these installation instructions carefully before installation. Read how to best light your stove in the lighting instructions.

Table of contents

Technical details	41
Supply of combustion air	42
Installation distance to walls and ceiling	43
Installation alternatives	45
Installing the surround	47
Installing the height extension	58
Flammable wall and accompanying protective screen	
Installing the height extension	62
Non-flammable wall and chimney connection straight back or straight up	
Installing the height extension	65
Non-flammable wall and connection with angle back	
Installing the woodbox	69

NOTE!

Report the installation of a stove to your local authority

The owner of the house is personally responsible for ensuring compliance with the mandatory safety requirements and must have the installation approved by a qualified inspector. Your local chimney sweep must also be informed about the installation as this will affect the routines for regular chimney-sweeping services.

WARNING!

The stove becomes very hot

During operation, certain surfaces of the stove become very hot and can cause burn injury if touched. Be aware of the strong heat radiated through the hatch glass. Placing flammable material closer than the safe distance indicated may cause a fire. Pyre lighting can cause quick gas ignition with the risk of damage to property and personal injury.

Technical details

	C11	C21	
Power output	6-12 kW	6-12 kW	
Nominal output	9 kW	10 kW	
Efficiency	81%	81%	
Model	C11C	C11A/S	Woodbox
Weight (kg)	470	450	135
Width (mm)	1050	1050	610
Depth (mm)	620	620	620
Height (mm)	1620	1620	465
Model	C11C extended	C11A/S extended	
Weight (kg)	575	550	
Height (mm)	2305	2305	
Model	C21C	C21A/S	Woodbox
Weight (kg)	495	480	110
Width (mm)	950	950	465
Depth (mm)	620	620	620
Height (mm)	1755	1755	465
Model	C21C extended	C21A/S extended	
Weight (kg)	585	560	
Height (mm)	2305	2305	

Connector diameter Ø200 mm ext.

Tested in accordance with:

European standard EN-13240

DIN plus

Bauart 1

Art. 15a B-VG

Test report no.

C11: RRF 40 09 2080

C21: RRF 40 09 2081

General

This manual contains instructions about how the Contura 11 and 21 must be constructed and installed. More information about the insert is available in the separate installation instructions. To ensure the function and safety of the hearth, we recommend that installation is carried out by an authorised technician. Our Contura dealers can recommend suitable technicians, information about our dealers can be found at www.contura.eu

Instructions for lighting are also supplied with the insert. Read them carefully and keep them safe for future use.

The hearth is type approved in accordance with EN 13240 and must be connected to a chimney dimensioned for a flue temperature of 350°C, the external connection diameter is Ø200 mm. Supply of combustion air from the outside must be arranged, see page 42.

Building application

Before installing a stove or erecting a chimney it is necessary for you to make a building application permission to your local authority. Ask your local authority for advice regarding building regulations and the application.

Structural support

If the hearth is to be positioned on a wooden joist, a structural engineer should evaluate the load capacity of the floor. When the gross weight exceeds 400 kg, reinforcement of the wooden joists is usually necessary.

Hearth plate

If the floor under the hearth is flammable, it must be protected by a non-flammable material which covers at least 300 mm to the front and 100 mm on each side.

The hearth plate can consist of natural stone, concrete or 0.7 mm thick metal. A painted metal or glass hearth plate is available as an accessory.

Chimney

The insert requires a draft in the chimney of at least -12 Pa. The draft is affected both by the length and area of the chimney, and by how well sealed it is.

- Once the lighting phase is complete, this insert must be operated with the door closed because of the risk of smoke entering the room. Always open the door carefully and slowly to prevent blow back because of the changing pressure in the stove.
- Carefully check that the chimney is sealed and that there is no leakage around soot hatches and flue connections.

Note that a flue with sharp bends and horizontal routing reduces the draught in the chimney. Maximum horizontal flue is 1 m, on the condition that the vertical flue length is at least 5 m. It must be possible to sweep the full length of the flue and the soot hatches must be easily accessible.

Wall behind

If your Contura 11 / 21 is to be installed against a flammable wall the wall must be protected by a firewall or by the integrated protective screen that is sold as an accessory for these models. A firewall must be at least the same width and height as the surround. More information about the requirements made of the fire wall material is available in the separate instructions for the insert. Remember that non-flammable walls can also require protection if they are bearing walls or have flammable material behind them.

Concrete

The surface of concrete, by its nature, is not free of defects. In order to achieve a neat end result some of the concrete may need to be filled and sanded. If greater damage occurs to the concrete it can be repaired by mixing water with the cement powder supplied and filling the holes.

Because of the settling in buildings and the fact that concrete shrinks, cracks may occur in the grouting between the blocks in the first few months. Scrape out the grout and brush the surfaces clean. Fill with new grout and paint over when dry.

Supply of combustion air

Combustion air can be provided directly via a duct from outside, or indirectly via a vent in the outer wall of the room where the stove is to be placed. The amount of combustion air used for combustion is approximately 30 m³/h (applies with closed hatch), Some installation alternatives are shown to the right. The air duct connection on the stove has an external diameter of Ø100 mm. In hot areas the duct should be insulated with 30 mm mineral wool covered with a moisture inhibitor (aluminium tape). It is important that the lead-in between the pipe and the wall (or floor) is sealed using jointing compound.

A 1 m length of condensation insulated ducting for combustion air is available as an accessory.

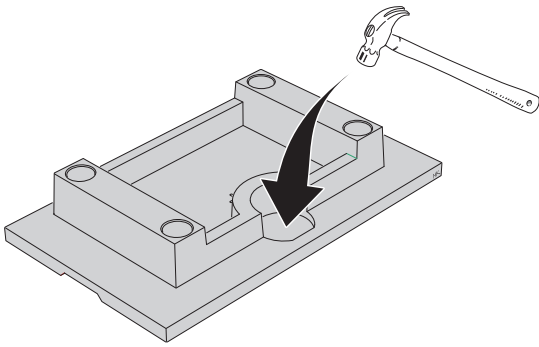

Knockout

To insert the combustion air hose through the base plate, tap out the knockout from the concrete using a hammer, remember to protect the floor.

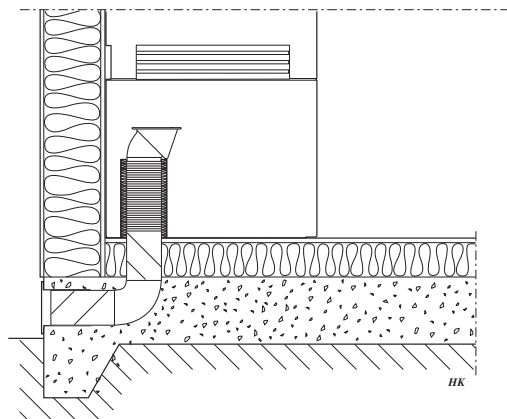
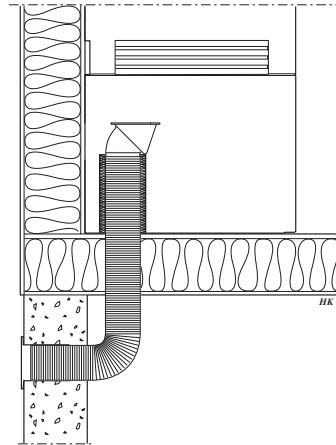
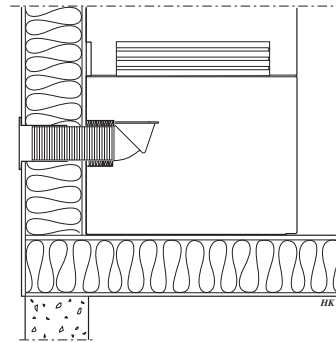
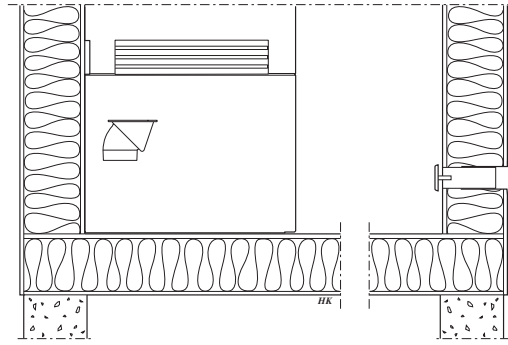
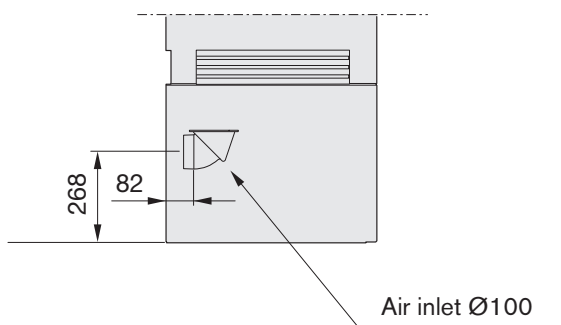
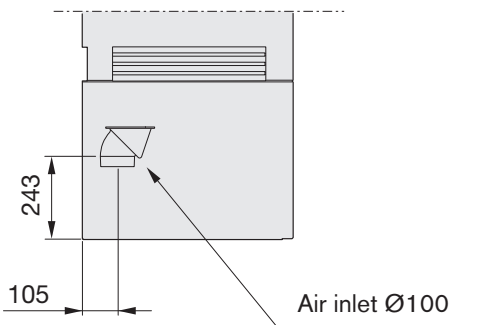

Installation distance to walls and ceiling

C11

Important!

The dimension diagrams only show the minimum permitted installation distances for the insert. When connecting to a steel flue, also note the safety distance requirements of the flue. The safety distance between an

uninsulated flue and a combustible part of the building should be at least 300 mm. The minimum distance to combustible parts of the building or interior decoration in front of the insert must be at least 1.5 m.

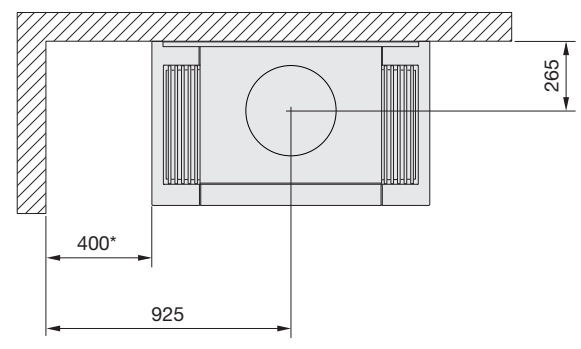
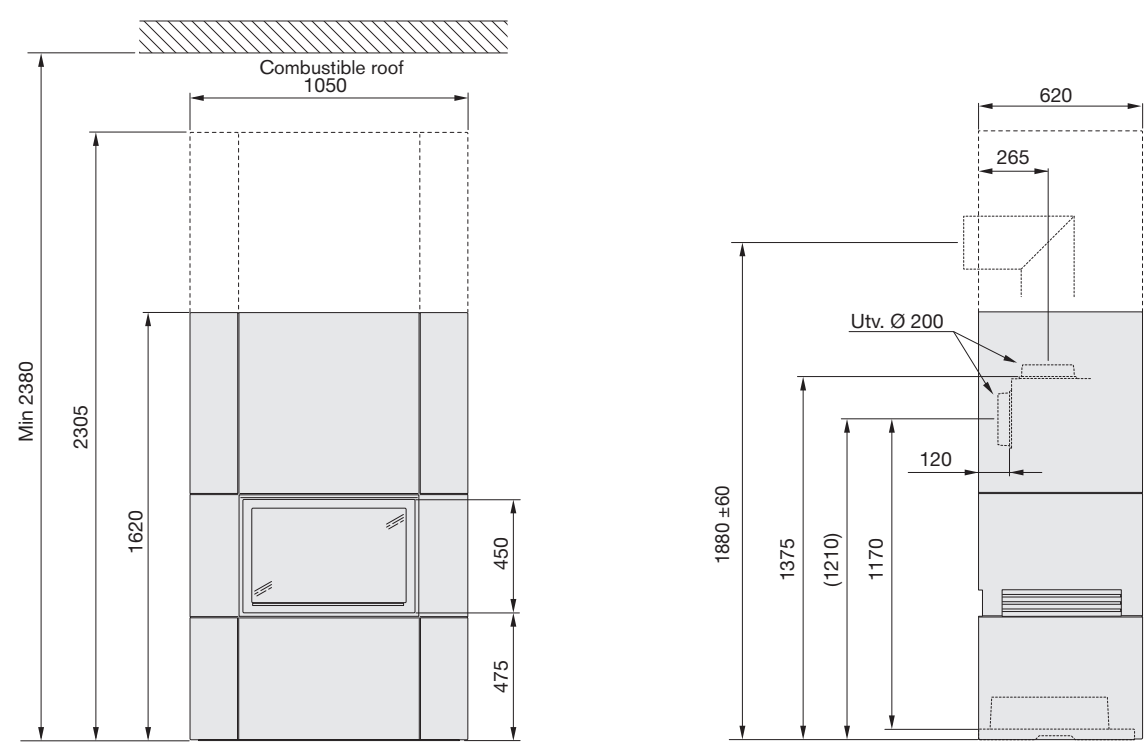

*If the wood compartment is to be placed between the surround and the wall at least 465 / 610 mm is required.

Installation distance to walls and ceiling

C21

Important!

The dimension diagrams only show the minimum permitted installation distances for the insert. When connecting to a steel flue, also note the safety distance requirements of the flue. The safety distance between an

uninsulated flue and a combustible part of the building should be at least 300 mm. The minimum distance to combustible parts of the building or interior decoration in front of the insert must be at least 1.5 m.

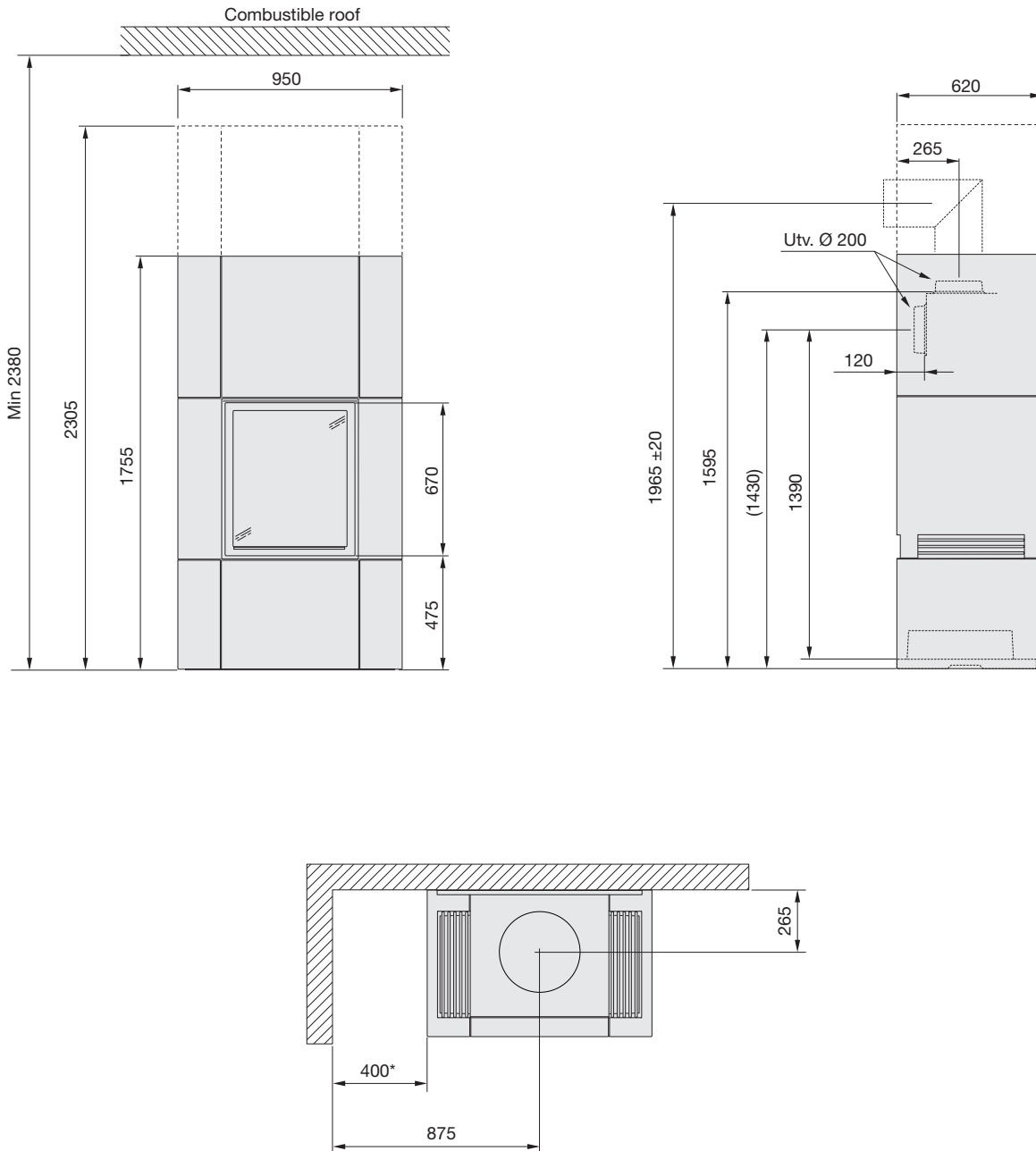

*If the wood compartment is to be placed between the surround and the wall at least 465 / 610 mm is required.

Installation alternatives

Selection of chimney connection and material in the wall behind mean that different requirements are made of installation. Note that a non-flammable wall or firewall must meet the requirements stated on page 41. In other cases the accompanying protective screen must be used.

Standard surround

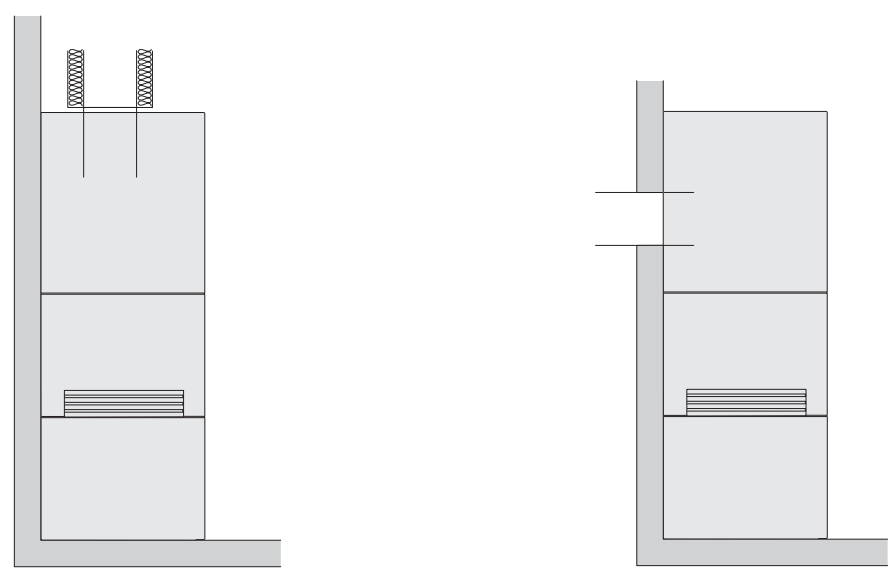

Non-flammable wall / Firewall

If the wall behind is non-flammable or protected by a firewall the surround can be installed directly against it. The small, 100x15 mm, air intakes in the protective screen on the surround sides can be filled if so desired. Top and rear connection can be made without any extra insulation or screening of connection pipes.

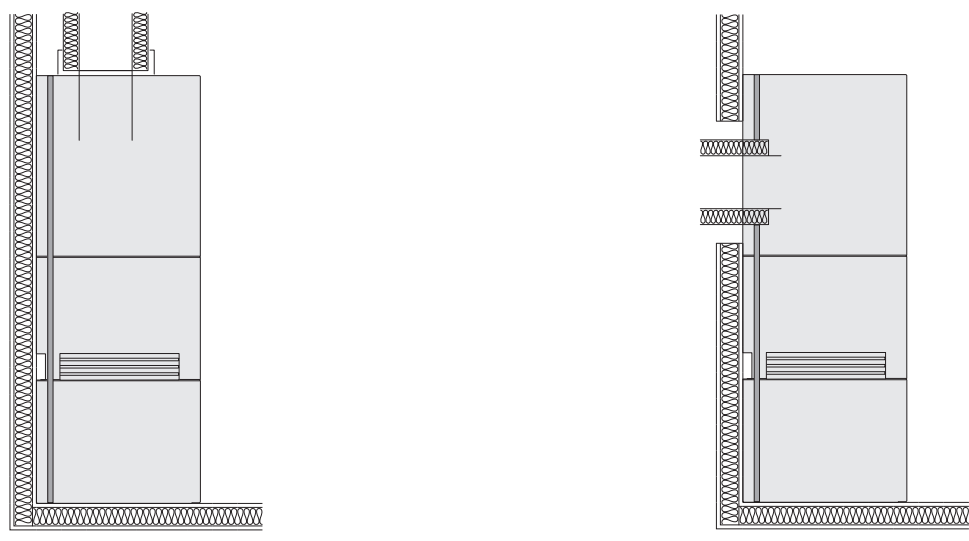

Protective screen

When the surround is installed together with the integrated protective screen it is important that the airflow is not blocked. For top connection, the gap between the top of the surround and the chimney insulation must be covered by a cuff to shield the radiant heat from the start pipe. It is also possible to connect to the rear through the protective screen, on the condition that a fully insulated chimney is used and the necessary safety distances observed. Ensure that there is a seal between the chimney and the protective screen.

Raised surround

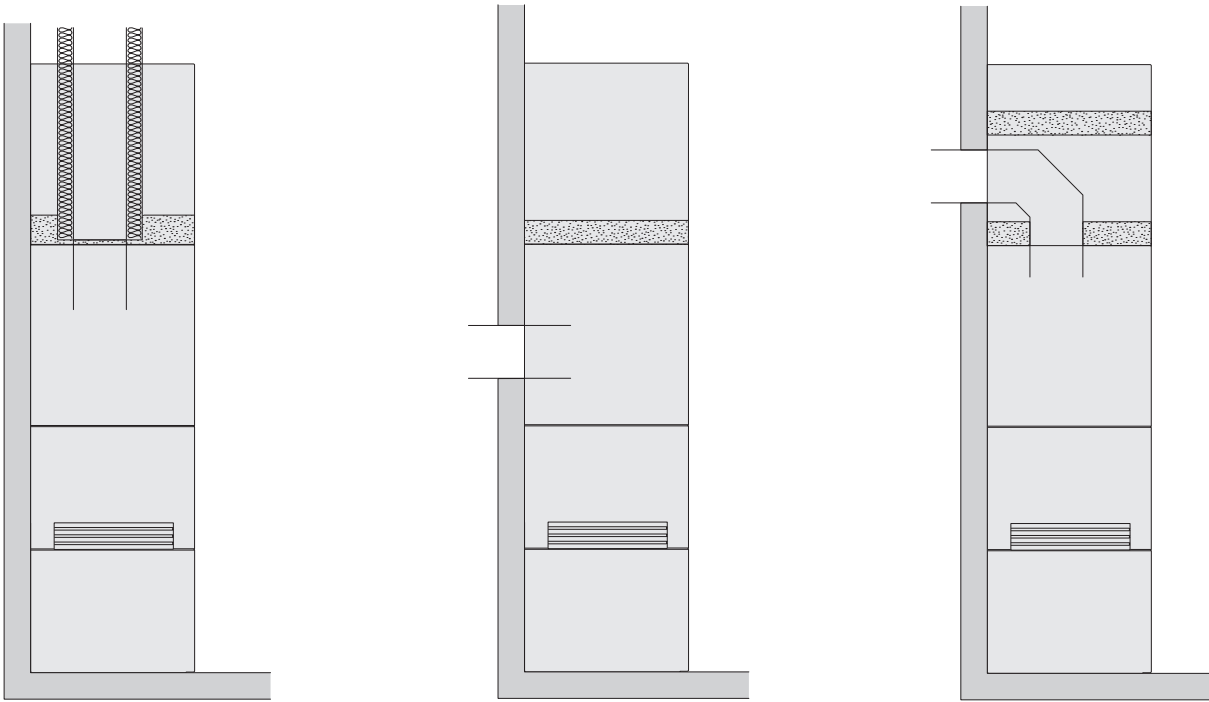

Non-flammable wall / Firewall

When the height extension section is installed in the integrated protective screen, the air outlet at the top of the surround nearest to the wall must be sealed and the whole top surface insulated. It is also possible to connect the chimney with a backward angle through the height extension section that requires a seal above the angle.

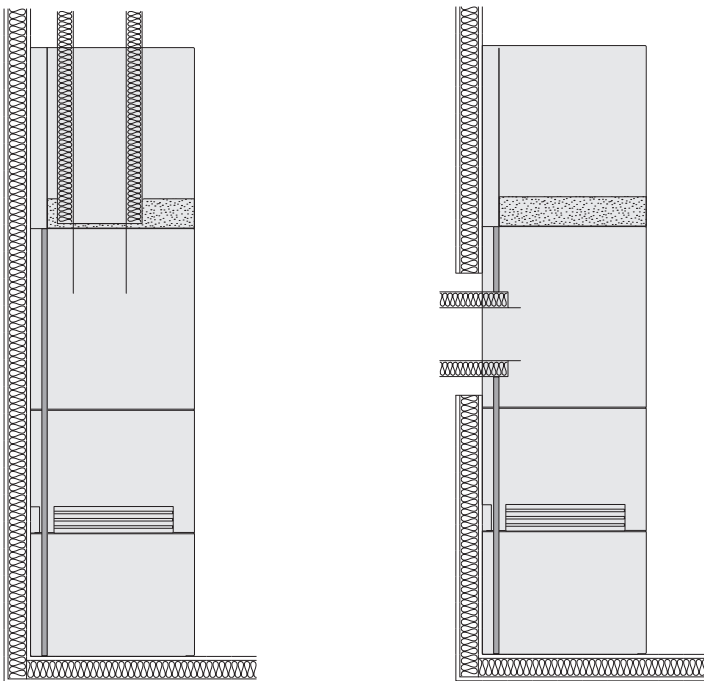

Protective screen

When the height extension section is installed the protective screen must be extended with a heat deflector through the height extension section. Ensure that the heat deflector is also ventilated. The top of the surround is also insulated using the insulation sheet provided.

Installation instructions surround C11, C21

Installation of the surround is the same for Contura 11 respectively 21. Contura 11 is illustrated.

Position the base plate against the wall.
Ensure that it is level, add steel shims to the thickest sections of the base plate if possible. If the accompanying protective screen is to be installed, install it now. See the separate instructions.

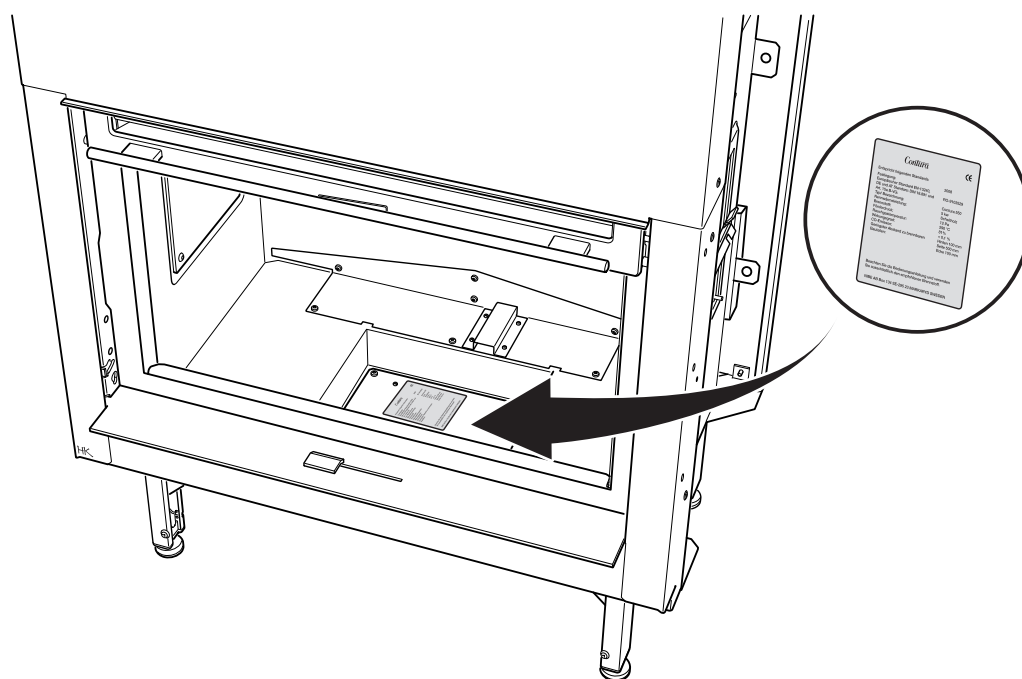
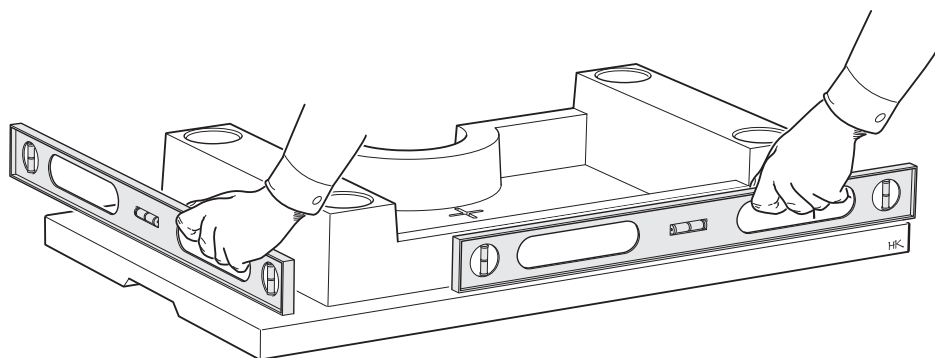

The type plate must be positioned under the bottom insulation of the ash-pan.

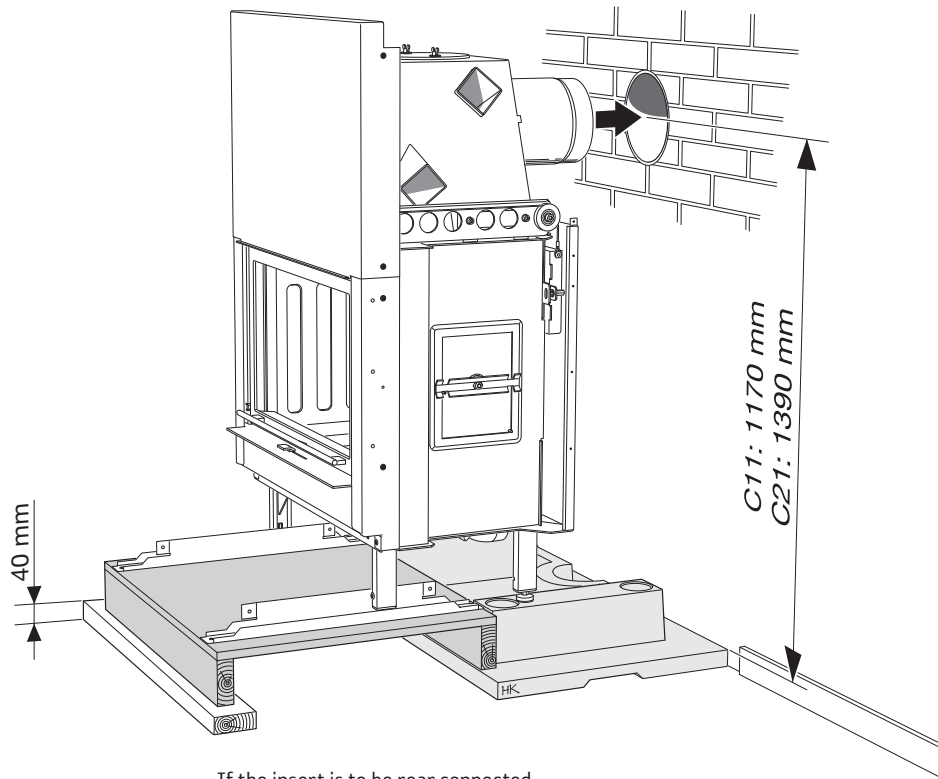

If the insert is to be rear connected,
connect it now.

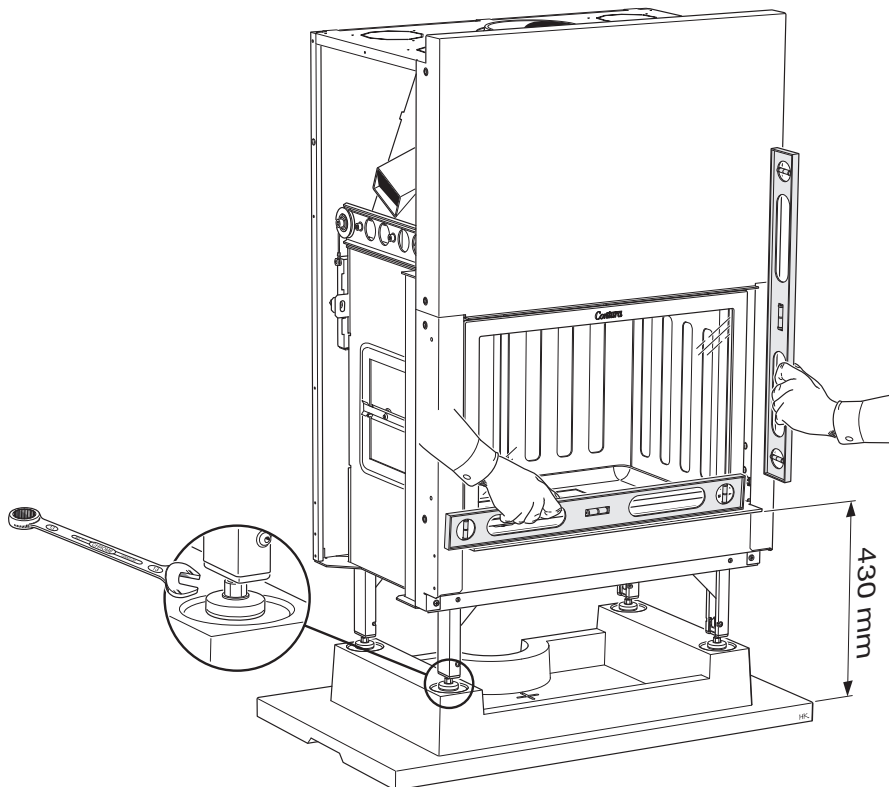

Lift the insert on to the base plate and adjust the feet so that the
distance from the floor to the underside of the shelf is 469 mm.
Check that it is straight and stable.

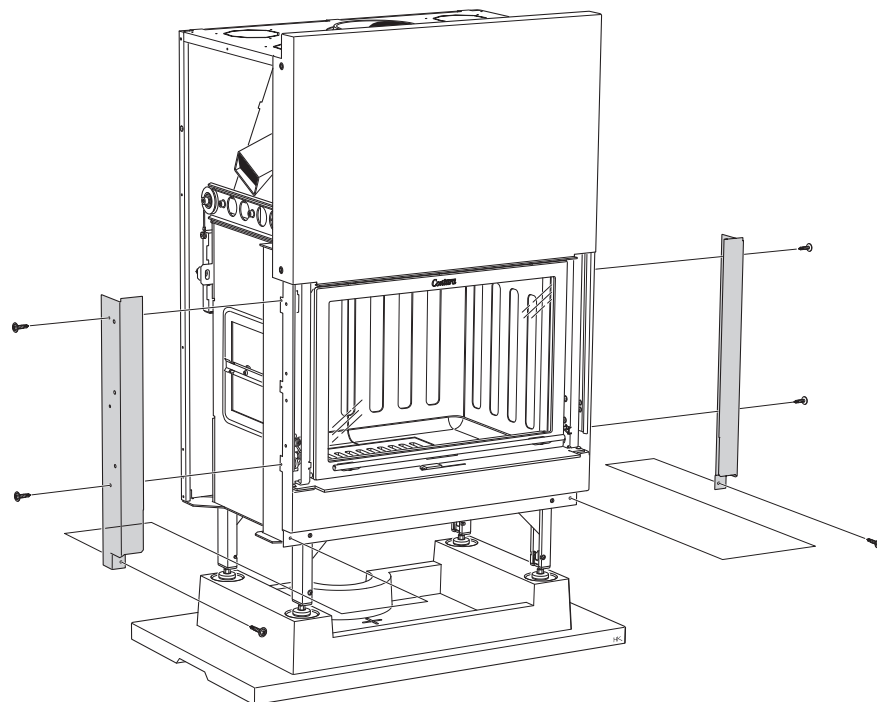

Loosen the screws holding the side panels and remove them. Use the same screws and screw holes to instead screw the hatch frame into place. Check that the bottom corners line up with the shelf.

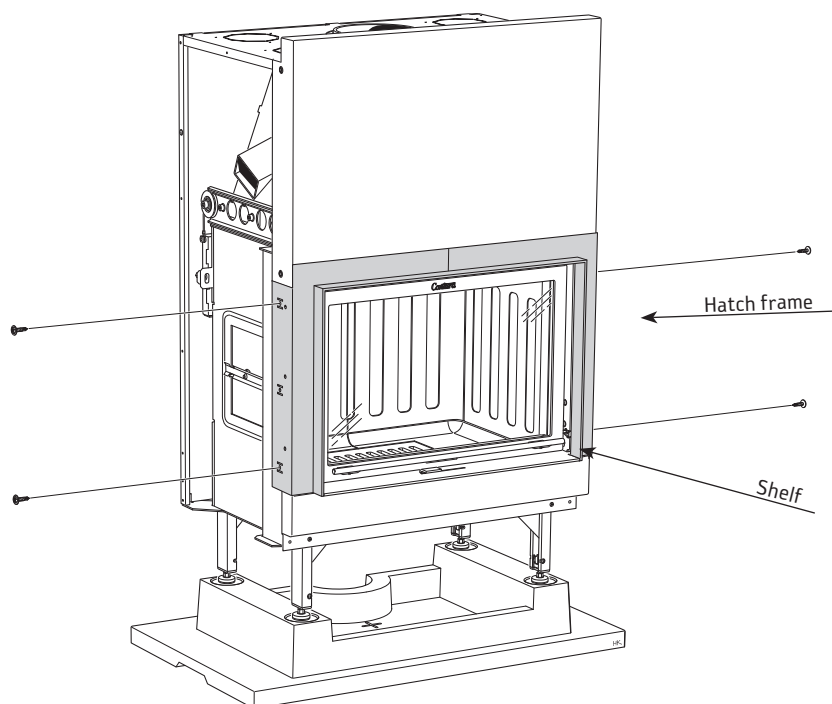

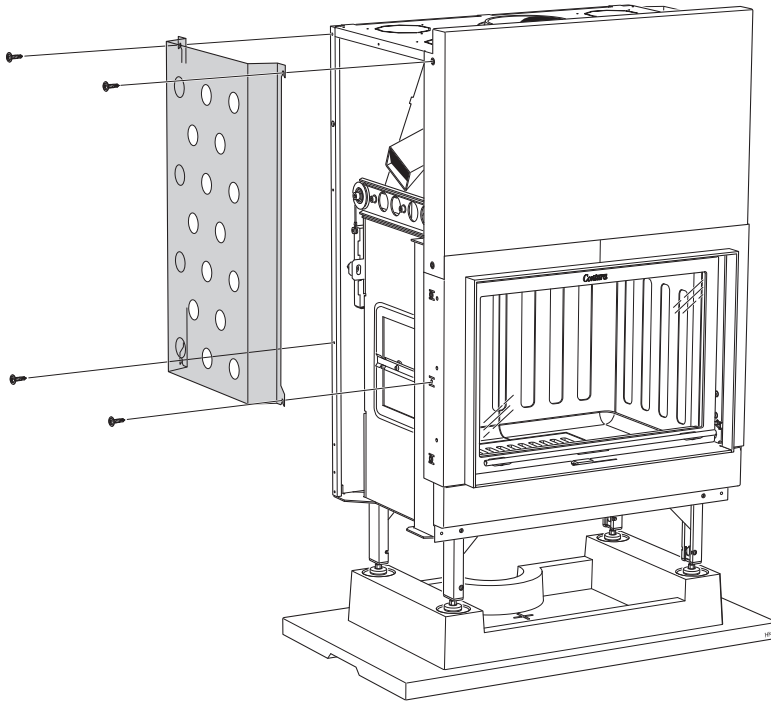

Install the heat deflectors on the sides of the insert. Use the six installation screws supplied in the screw bag, and the screws that are already in the upper corner of the insert.

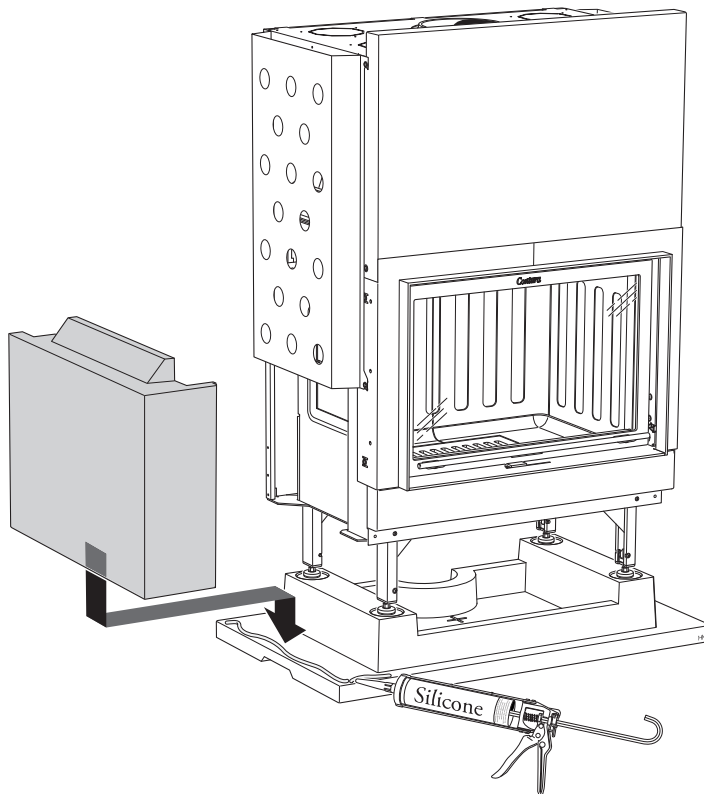

Apply a bead of silicone on the base plate and then lift in the lower section sides.

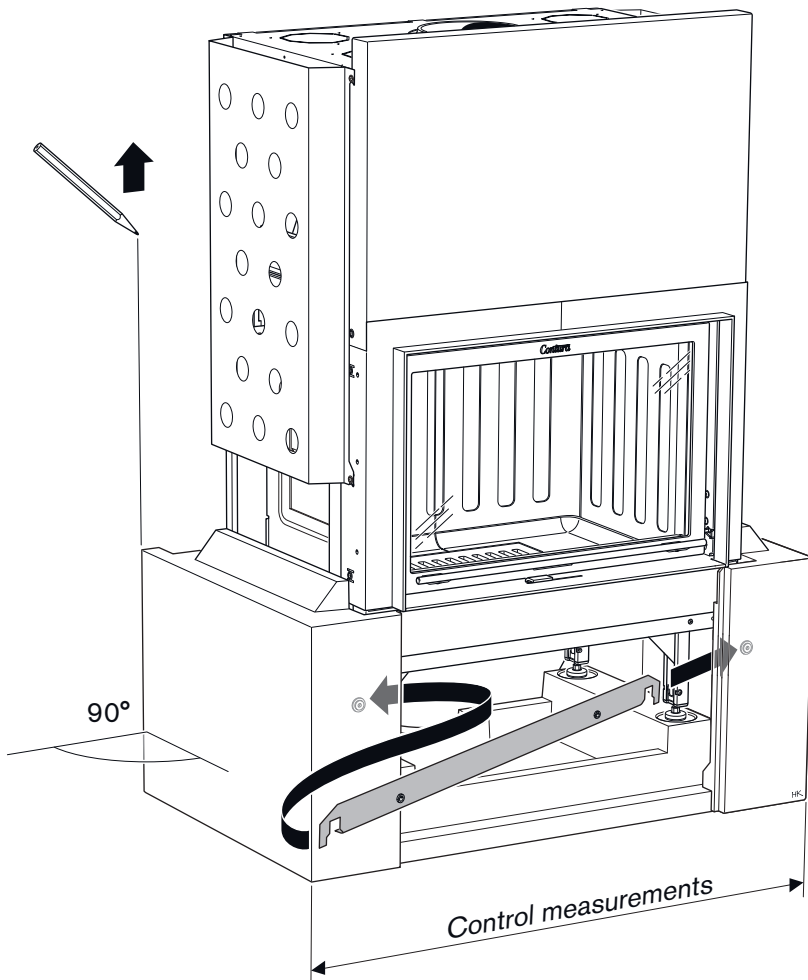

When both the sides are in position the safety rail is hung from the side washers to prevent them falling out to the sides.

Check measure that the distance between the sides is the same at the front edge as at the rear edge and check that the sides are straight. Draw a horizontal check line on the wall to simplify further installation. Also check that the front edge of the hatch surround aligns with the inner edge of the concrete edges.

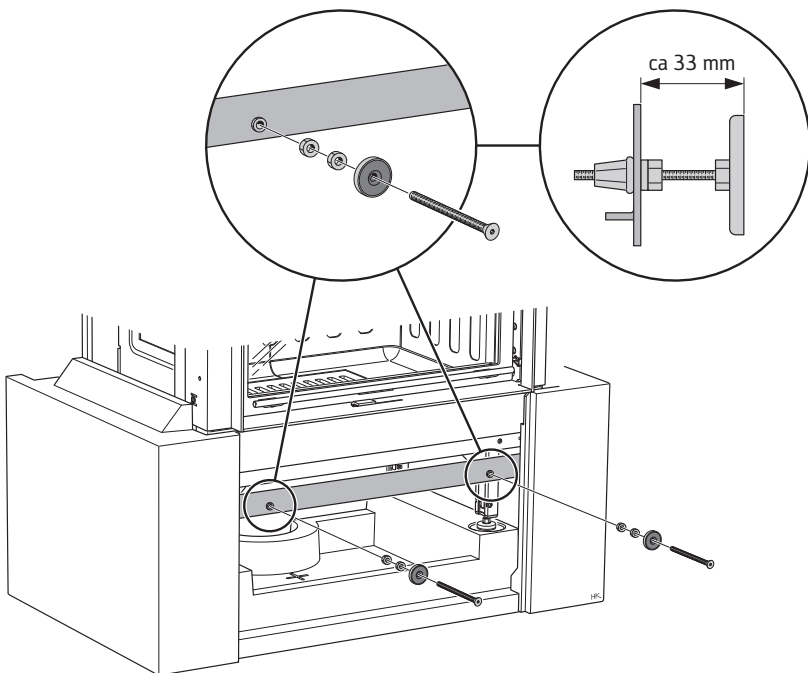

Applies to C 11A, C 11S, C 21A, C21S (Sheet metal)

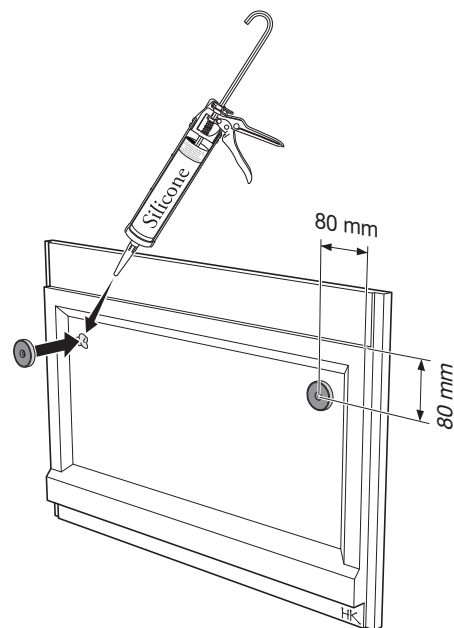

Applies to C 11C and C 21C (Concrete)

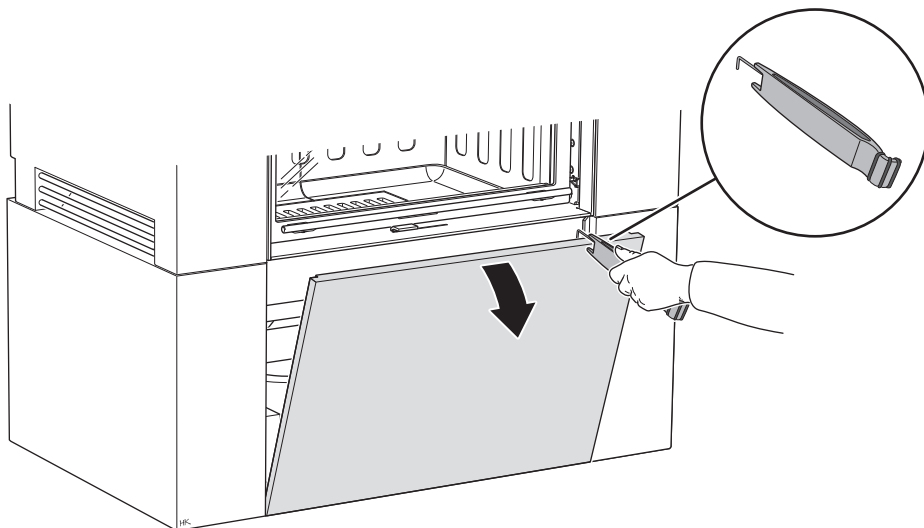

In the event of removal and height adjustment, use the following hook and pull out the lower door.

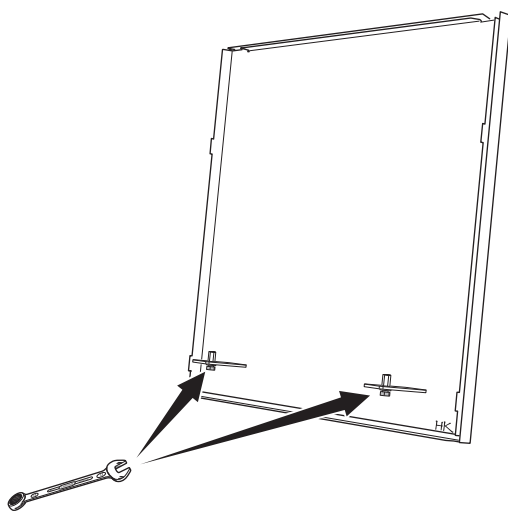

The panel variants' front are adjusted for height using two adjustment screws

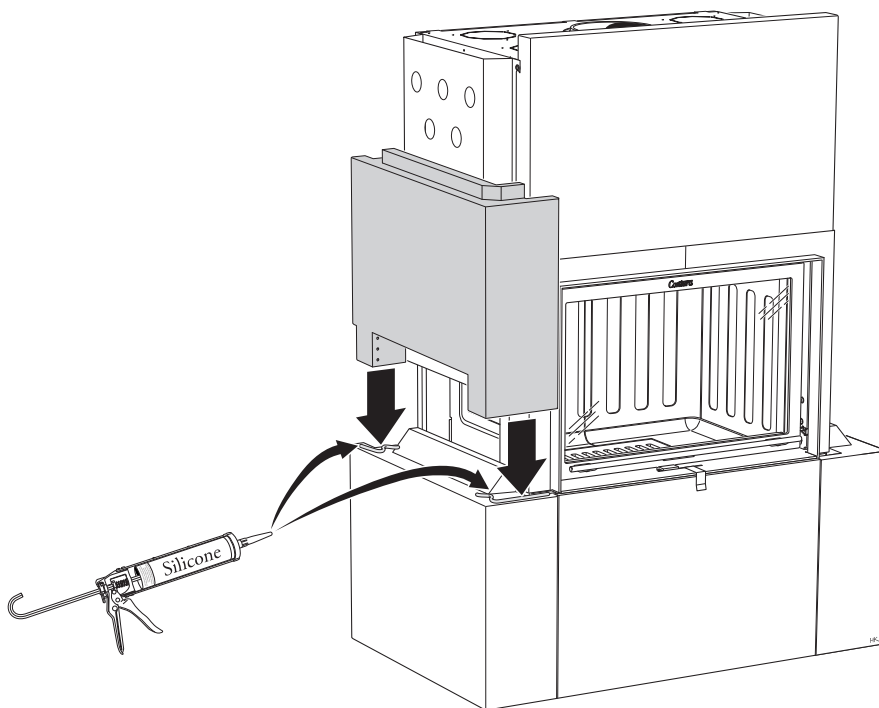

Continue with the second section's sides and bond them with silicone.

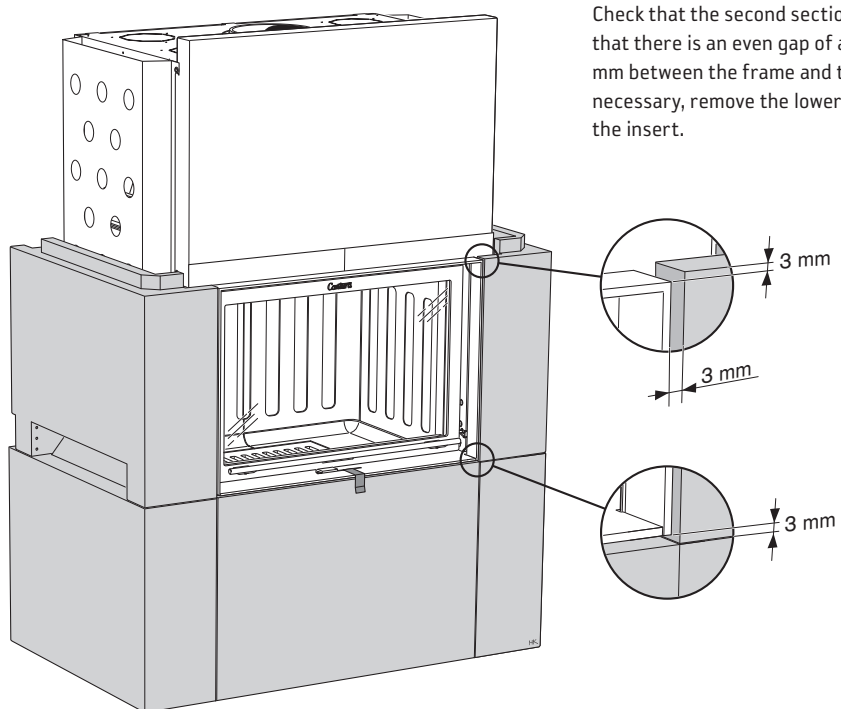

Check that the second section is straight and that there is an even gap of approximately 3 mm between the frame and the concrete. If necessary, remove the lower front and adjust the insert.

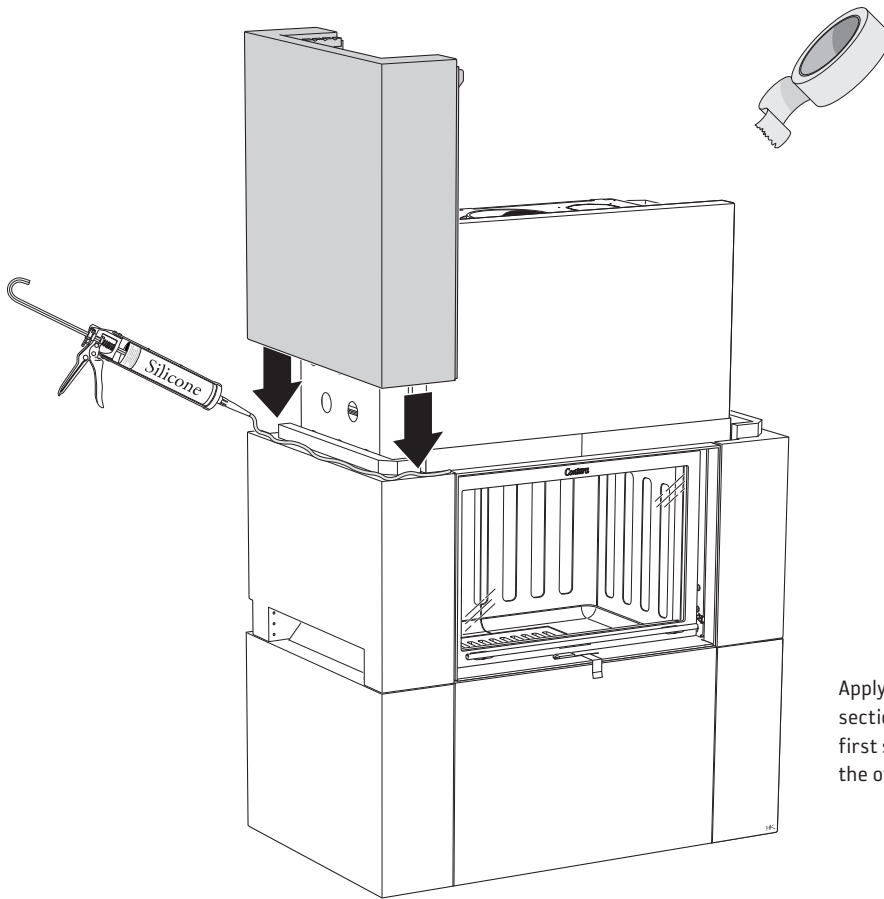

Apply a bead of silicone on the upper edge of the second section and then lift in the third section sides. Support the first side using a piece of tape so that it does not fall while the other side is installed.

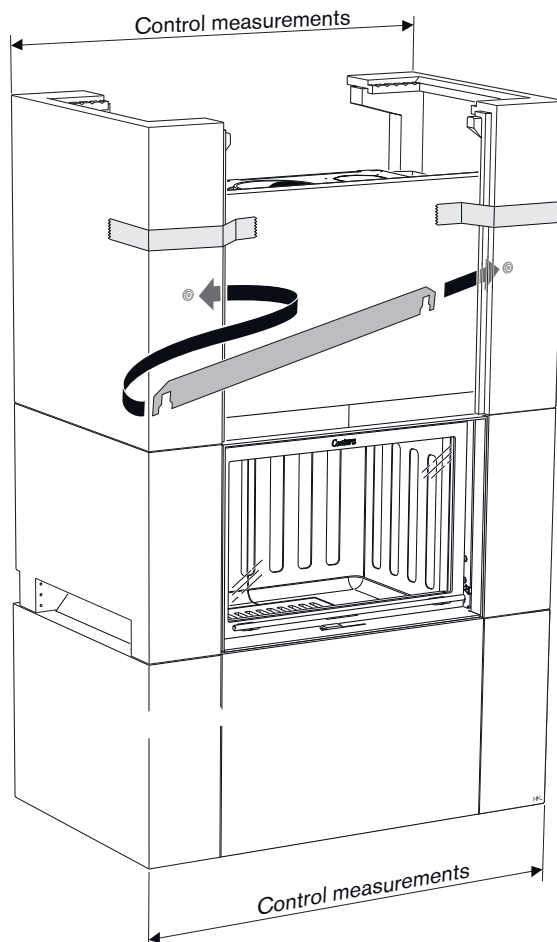

Hang the safety rail between the third section sides and ensure that they are straight. Check that the width is the same as section 1 at the front and rear edges.

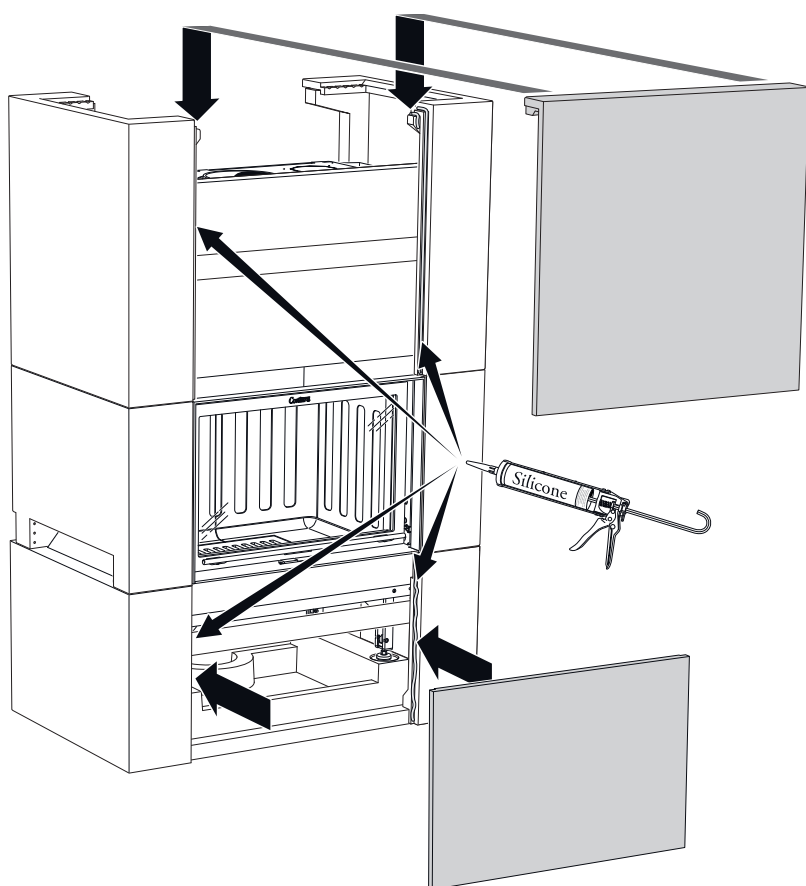

Apply silicone beads along the front edge of the sides and bond the upper front.

Bond the lower front with silicone. Use the supplied installation angle to keep the front panel in position while the silicone cures.

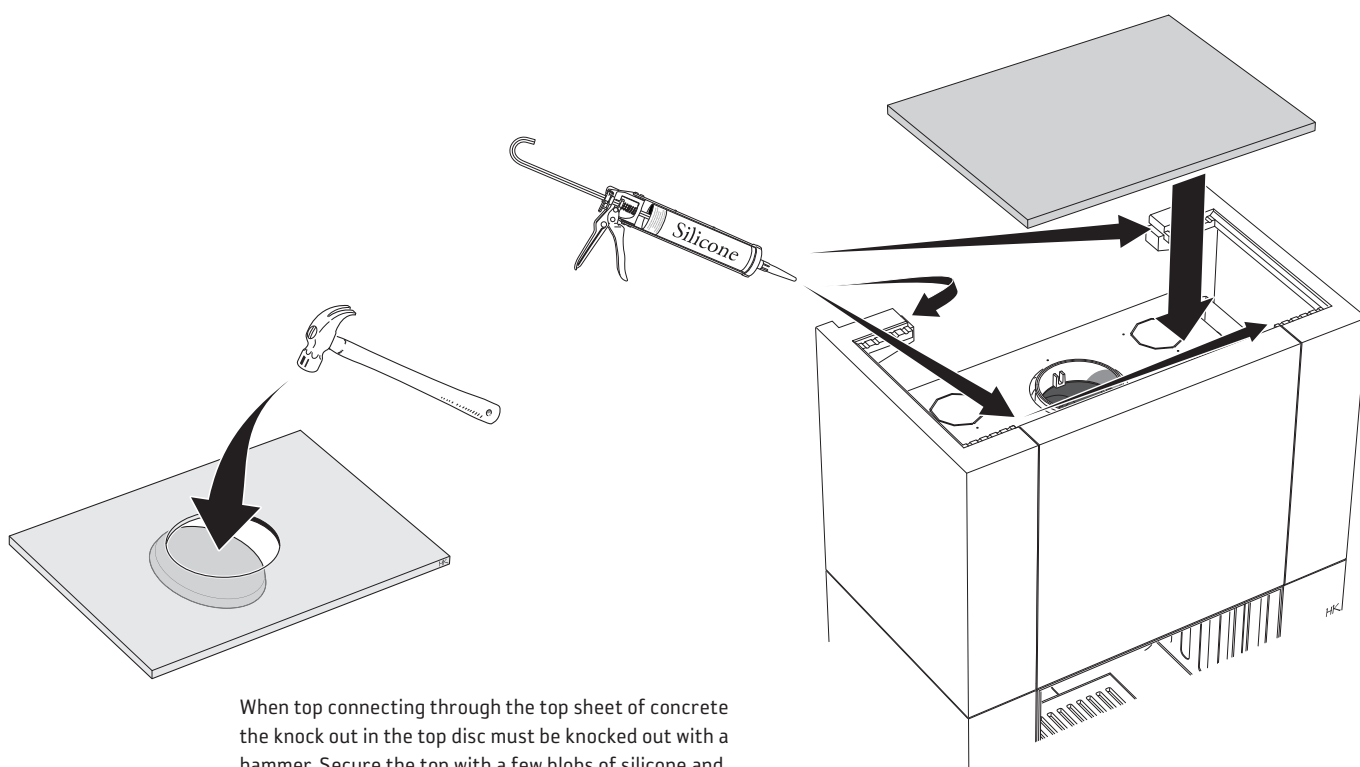

When top connecting through the top sheet of concrete the knock out in the top disc must be knocked out with a hammer. Secure the top with a few blobs of silicone and press it forward so that it is tight to the front panel.

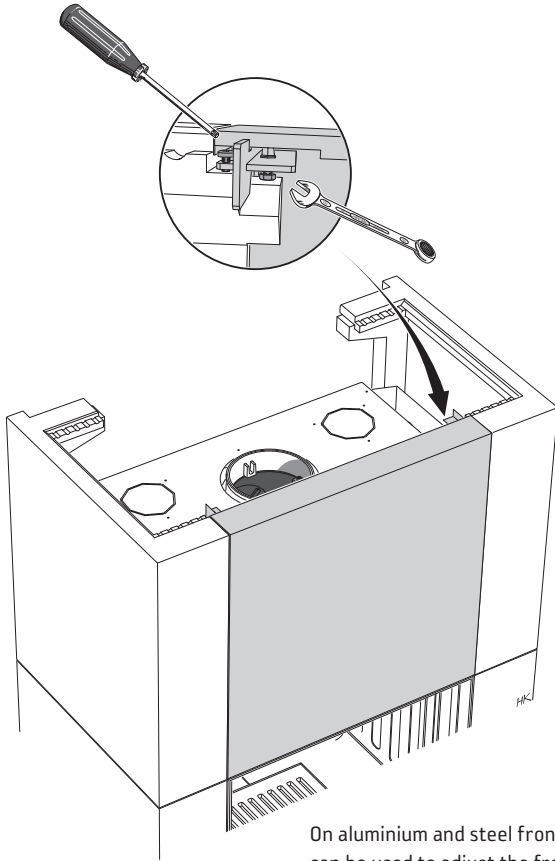

On aluminium and steel fronts there are adjustment screws that can be used to adjust the front panel by height. When the front panel is set the outer Torx screws are screwed until they support against the concrete. The top rests on the turned down angles at the rear edge, these can be adjusted to get the top to the level of the concrete.

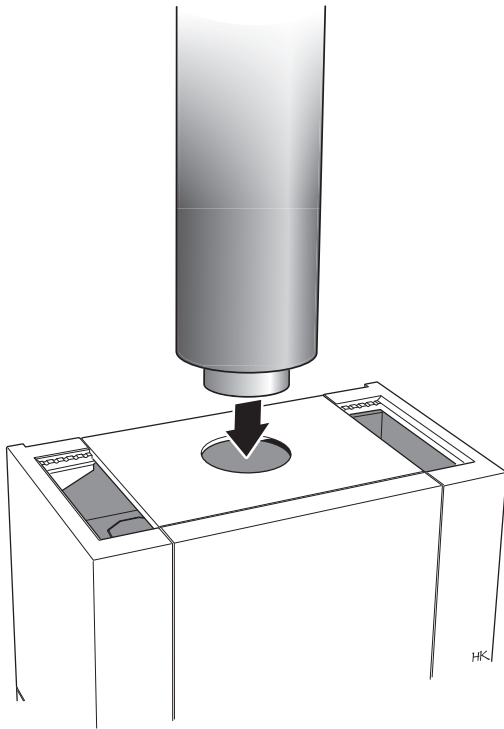
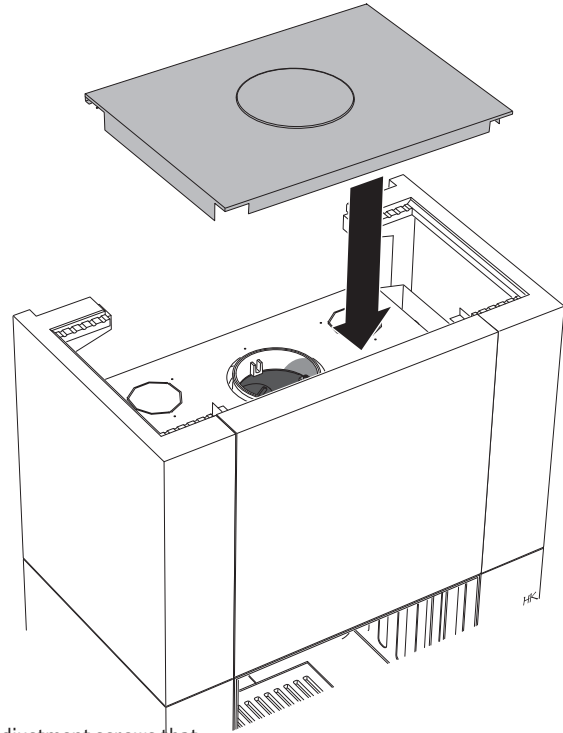

For installations without height extensions, top connection to stainless steel flues is now possible; follow the chimney manufacturer's instructions. Then continue on page 57 with joining and painting.

When installing the height extension section:

- with an integrated protective screen, go to page 58.
- in combination with a non-flammable wall and chimney connection straight backwards, go to page 62.
- in combination with a non-flammable wall and chimney connection angled backwards through the height extension section, go to page 65.

Final inspection of the installation

Before the stove is used, it must be inspected by an authorised chimney sweep. Read the "Instructions for Lighting the CI 10 / CI 20 series" before lighting the fire for the first time.



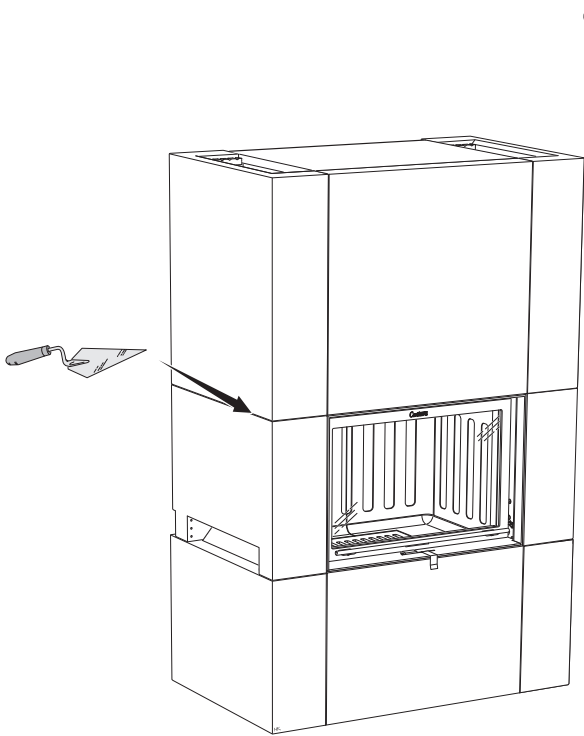

Even off the edges between the concrete blocks by applying a little grout in the joints and then using the corner of a filling knife to scrape out the excess and retain the marked edges.

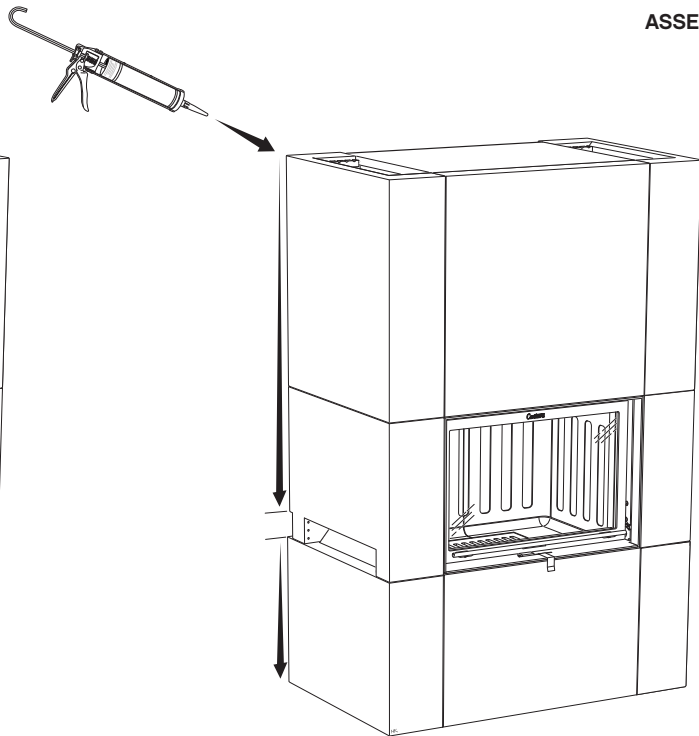

The gap between the concrete and the wall behind can be grouted if so desired. It is important that the air inlet, 100x15 mm, at the bottom of the section two is not blocked if the integrated protective screen is installed. If the surround is installed against a normal firewall the air intake can be blocked if so desired.

Fill and sand small scratches and pores in the concrete. As soon as the silicone, grout and any repairs to the concrete are dry the surround can be painted with a silicate paint.

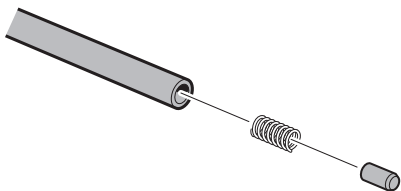

When the paint is dry the grilles can be installed. The top grilles* are placed in position on the upper side, and the lower grille pins are installed using the springs and lugs supplied.

* (not used when installing the height extension section).

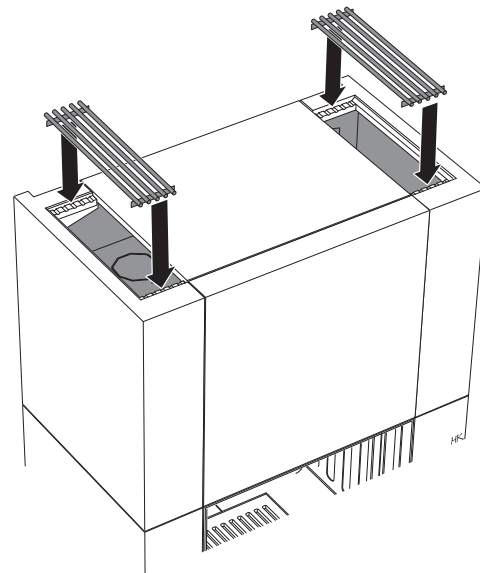
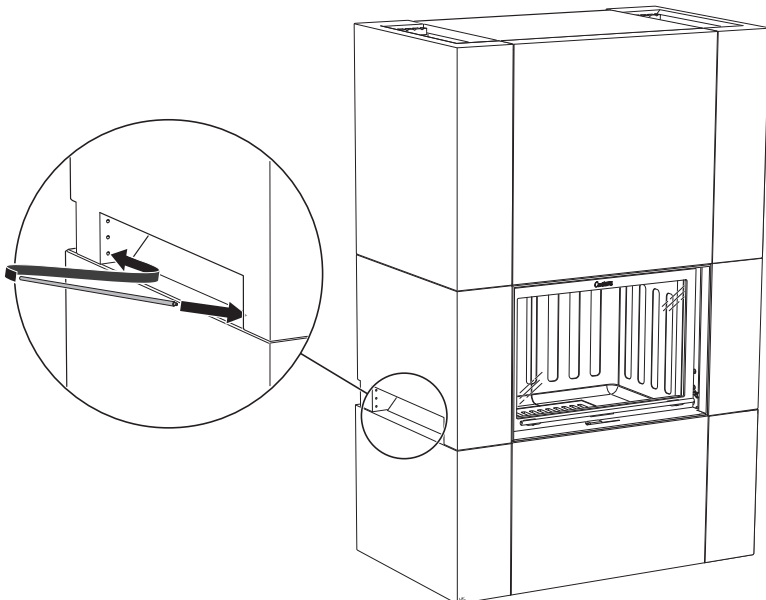

Installation height extension sections C11, C21

In combination with flammable wall and accompanying protective screen



Note the different installation methods of the height extension section. When using a protective screen the airflow must not be restricted at any point.

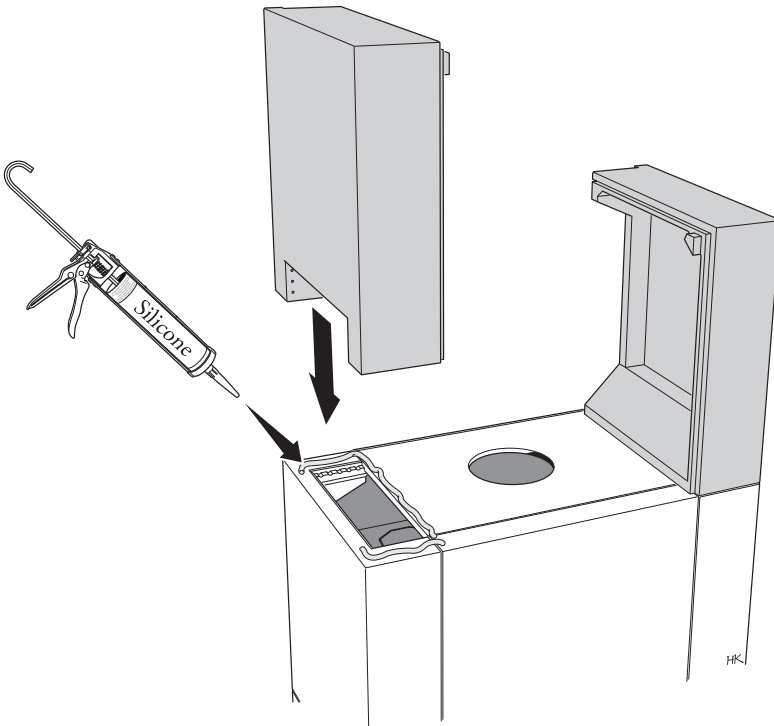

Install the protective screen according to the separate instruction and the surround at ordinary height according to page 47-56. Then apply silicone to the top of the surround and lift up the concrete sides of the height extension section. Support the first side so that it does not fall while the other side is installed.

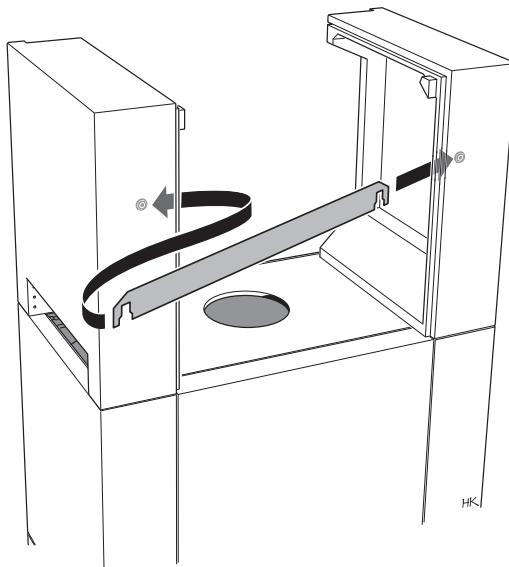

Hang the safety rail between the sides and ensure that they are straight. Check that the width is the same as section 1 at the front and rear edges.

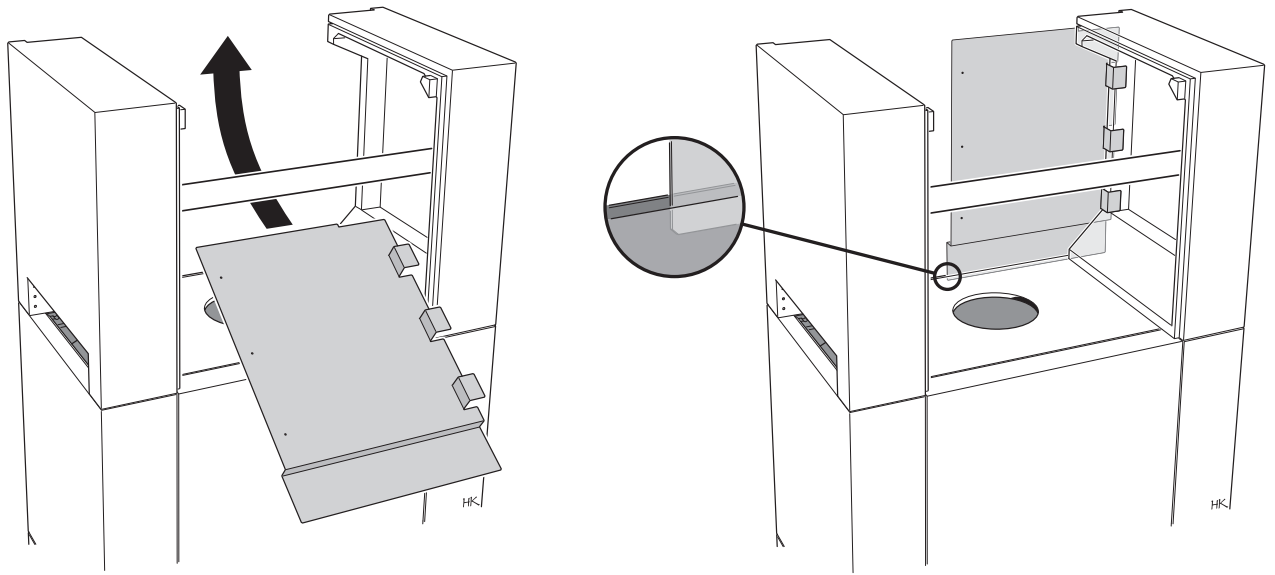

Install the right half of the heat deflector by inserting sideways and hooking the tabs around the concrete. Note that the heat deflector at the bottom edge must be positioned in front of the protective screen's heat deflector.

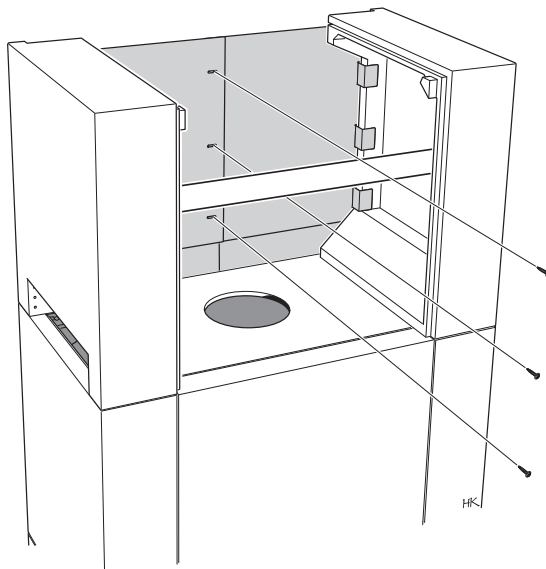

Install the left half of the heat deflector in the same way, and screw the two halves together.

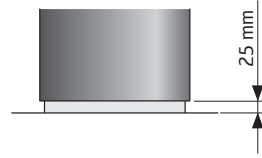
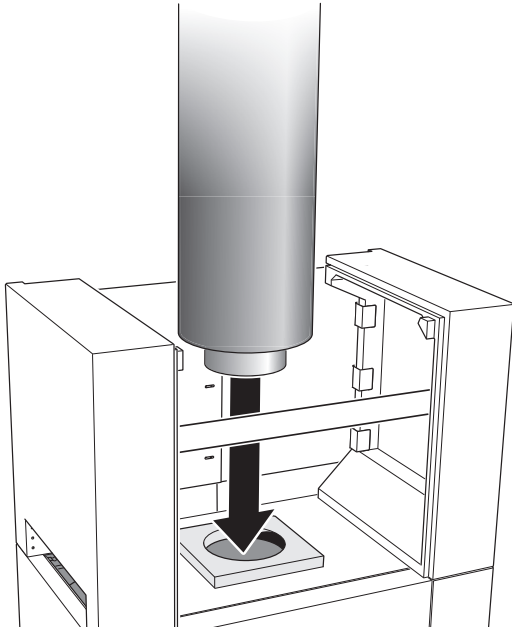

For top connection

Check that the measurement between the top and the chimney mantle is 25-30 mm. Then position the small insulation plate over the chimney hole in the top and connect the chimney. The chimney must press the insulation together approx 5 mm so that it is tight, but the weight must be on the insert and not the top panel. If the start pipe has a diameter greater than 150 mm the hole in the insulation must be cut out to fit.



- The joint between the top and the chimney mantel must be tight to prevent convection air from the surround leaking out at the change height.
- The weight of the chimney must be on the insert, not the surrounding.
- If the chimney is designed in another way the seal must be adapted to it.

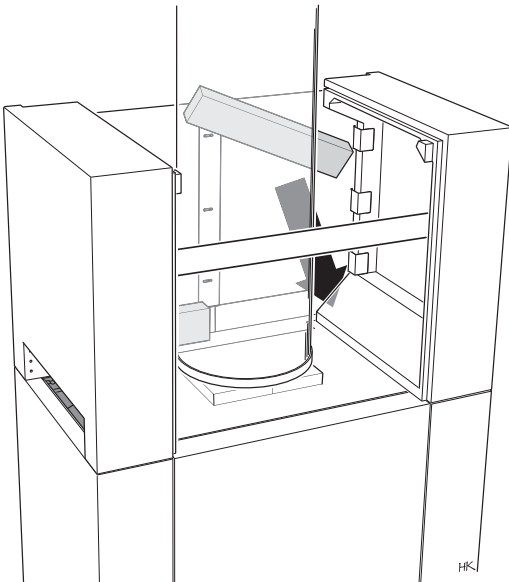

Press in the rectangular insulation pieces at the rear edge and seal carefully to prevent convection air leaking out at the height extension section.

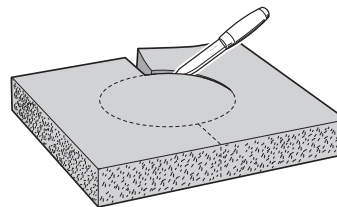
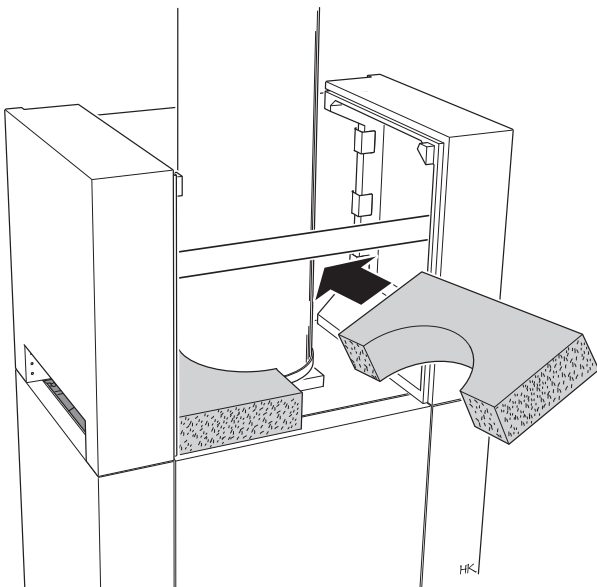

Cut the large sheet of insulation so that it fits around the chimney mantle and position it so that it covers the whole of the top of the surround.

To avoid gaps in the panel lines of the front area, the height extension panel must be hung first without silicone. Adjust the components so that the joints between them look good, use shims where necessary.

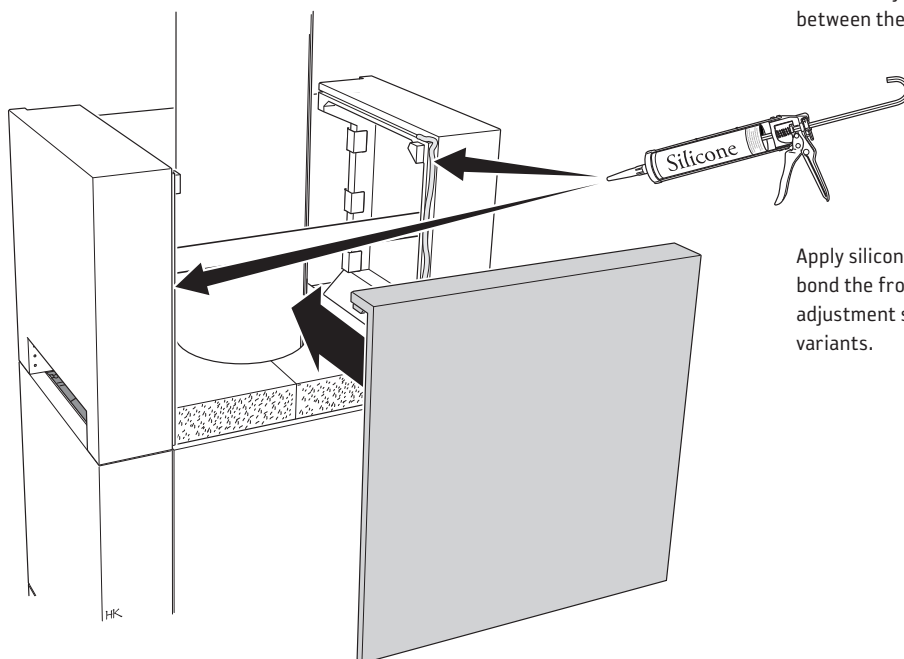

Apply silicone along the front edge of the sides and bond the front in position. If necessary, use the adjustment screws to adjust the height of the panel variants.

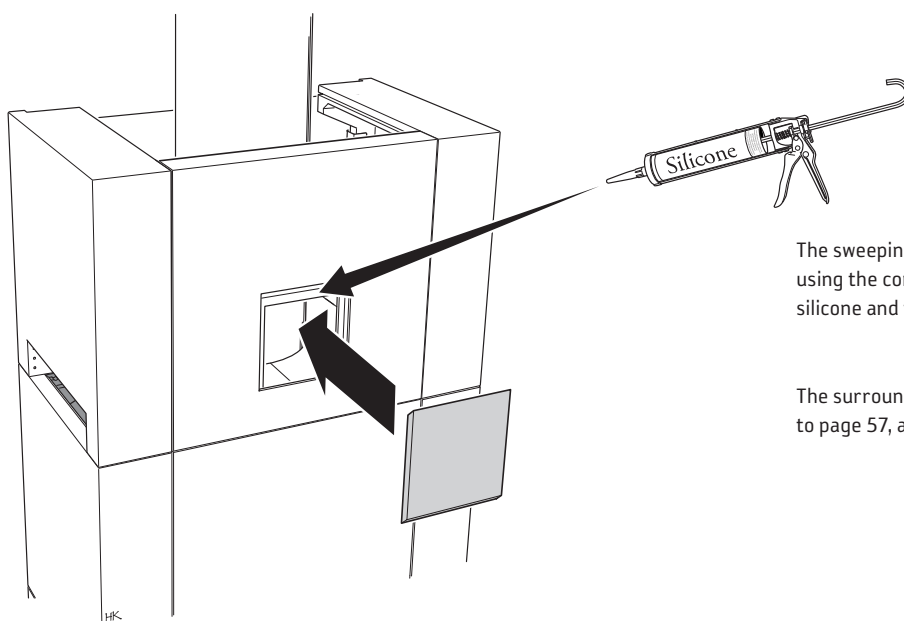

The sweeping hole in the concrete front is plugged using the concrete plug. Bond it into place using silicone and fill it before painting.

The surround can now be joined and painted according to page 57, after which the grilles can be put in place.

Final inspection of the installation

Before the stove is used, it must be inspected by an authorised chimney sweep. Read the "Instructions for Lighting the CI 10 / CI 20 series" before lighting the fire for the first time.



Installation height extension sections C11, C21

In combination with non-flammable wall and chimney connection straight back or straight up



Note the different installation methods of the height extension section. When the protective screen provided is not used the air outlet at the rear edge of the top panel must be plugged.

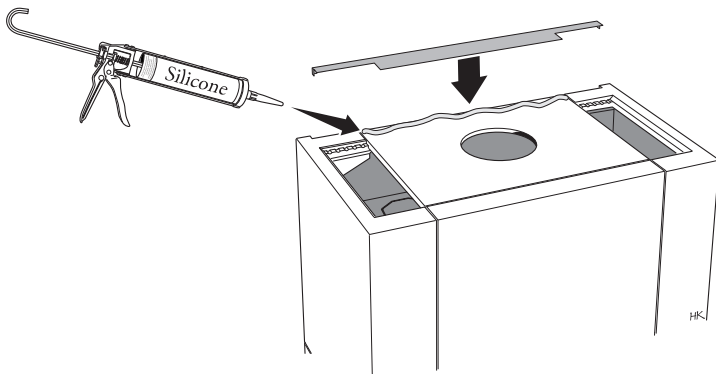

Install the surround at ordinary height according to page 47-56 in the instructions. Block the air outlet at the rear edge of the top panel using the seal plate that is bonded into position using silicone.

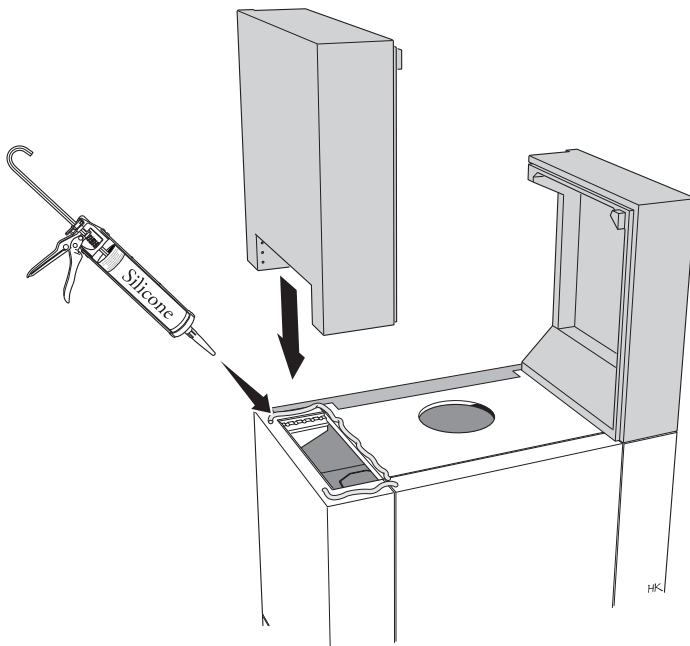

Then apply silicone to the top of the surround and lift up the concrete sides of the height extension section. Support the first side so that it does not fall while the other side is installed.

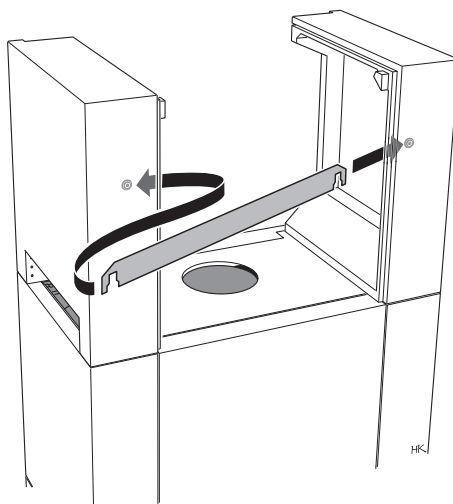

Hang the safety rail between the sides and ensure that they are straight. Check that the width is the same as section 1 at the front and rear edges.

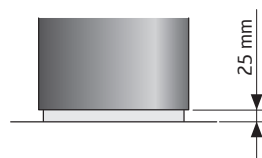
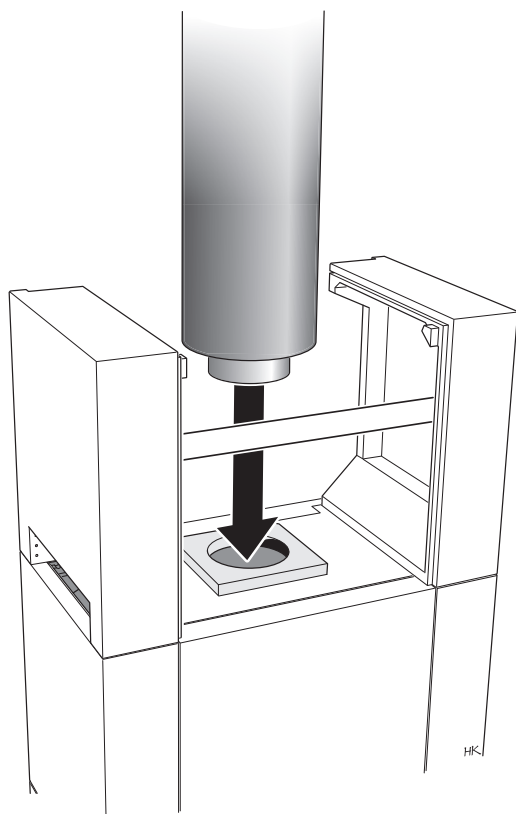

For top connection

Check that the measurement between the top and the chimney mantle is 25-30 mm. Then position the small insulation plate over the chimney hole in the top and connect the chimney. The chimney must press the insulation together approx 5 mm so that it is tight, but the weight must be on the insert and not the top panel. If the start pipe has a diameter greater than 150 mm the hole in the insulation must be cut out to fit.



- The joint between the top and the chimney mantle must be tight to prevent convection air from the surround leaking out at the change height.
- The weight of the chimney must be on the insert, not the surrounding.
- If the chimney is designed in another way the seal must be adapted to it.

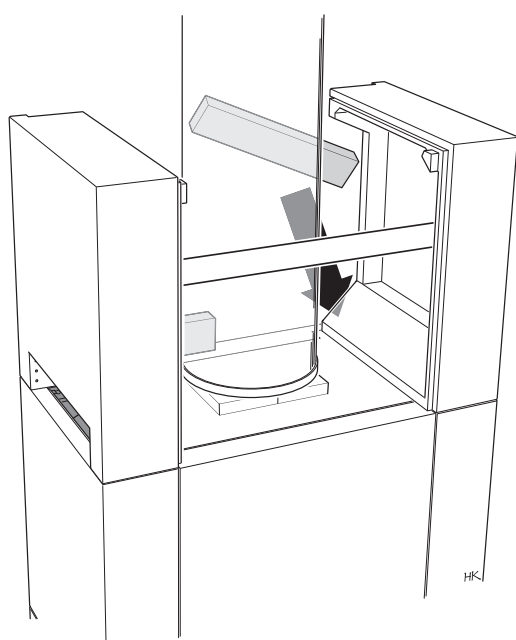
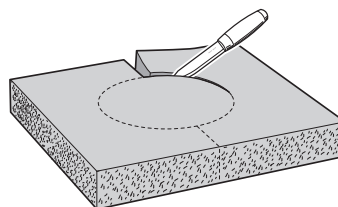

Press in the rectangular insulation pieces at the rear edge and seal carefully to prevent convection air leaking out at the height extension section.

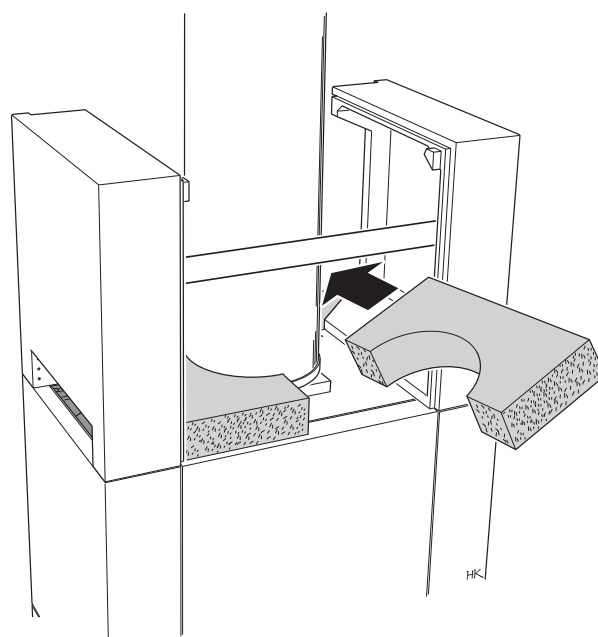

Cut the large sheet of insulation so that it fits around the chimney mantle and position it so that it covers the whole of the top of the surround.

To avoid gaps in the panel lines of the front area, the height extension panel must be hung first without silicone. Adjust the components so that the joints between them look good, use shims where necessary.

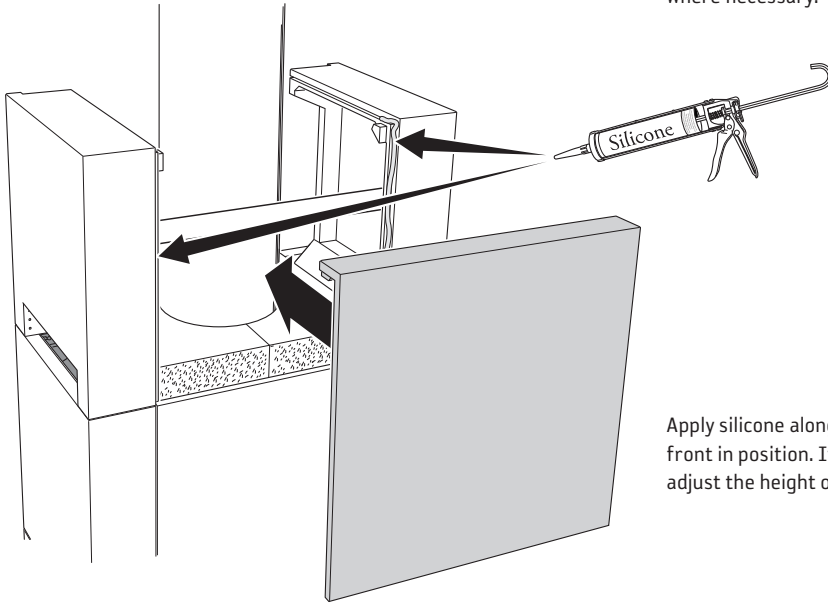

Apply silicone along the front edge of the sides and bond the front in position. If necessary, use the adjustment screws to adjust the height of the panel variants.

The sweeping hole in the concrete front is plugged using the concrete plug. Bond it into place using silicone and fill it before painting.

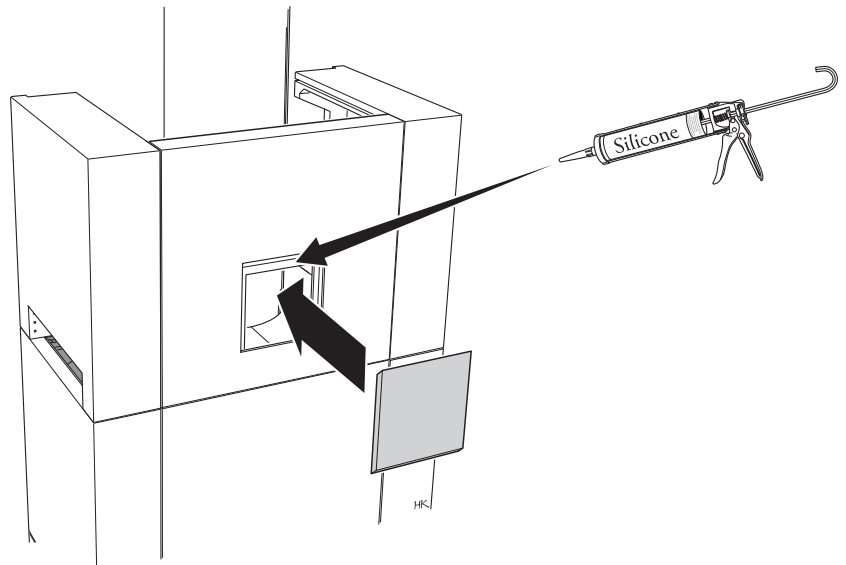

The surround can now be joined and painted according to page 57, after which the grilles can be put in place.

Final inspection of the installation

Before the stove is used, it must be inspected by an authorised chimney sweep. Read the "Instructions for Lighting the CI 10 / CI 20 series" before lighting the fire for the first time.



Installation height extension sections C11, C21

In combination with non-flammable wall and chimney connection angled back through the height extension section.



Note the different installation methods of the height extension section. When the protective firewall provided is not used the air outlet at the rear edge of the top panel must be plugged.

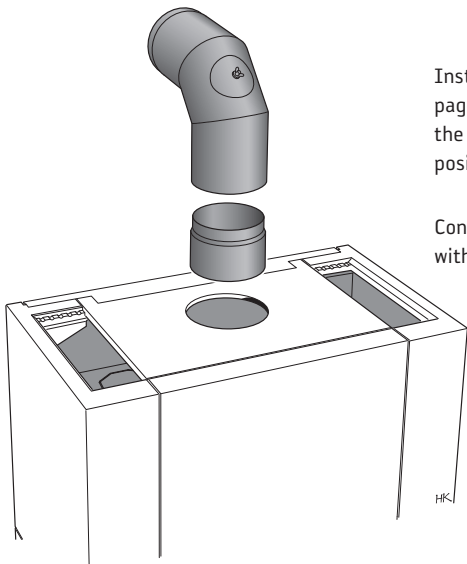

Install the surround at ordinary height according to page 47-56. Block the air outlet at the rear edge of the top panel using the seal plate that is bonded into position using silicone.

Connect the insert upwards and backwards within the given heights.

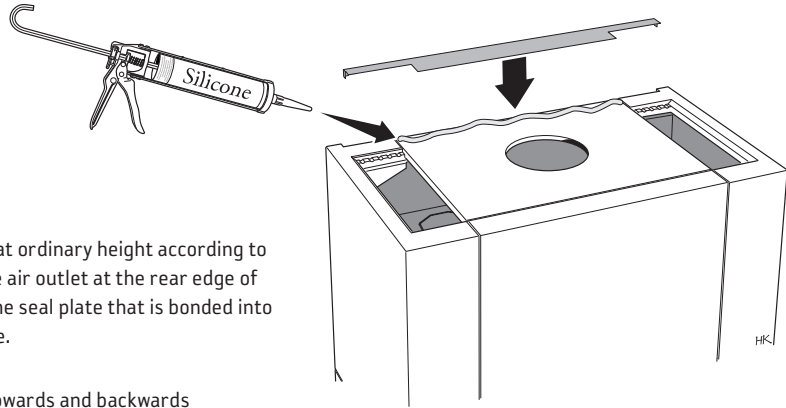

Apply silicone to the top of the surround and lift up the concrete sides of the height extension section. Support the first side so that it does not fall while the other side is installed.

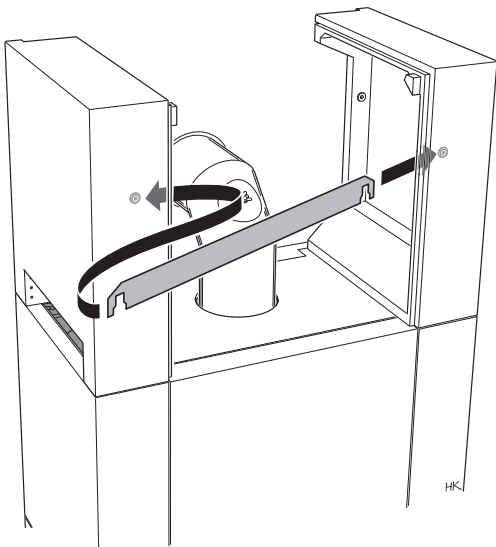
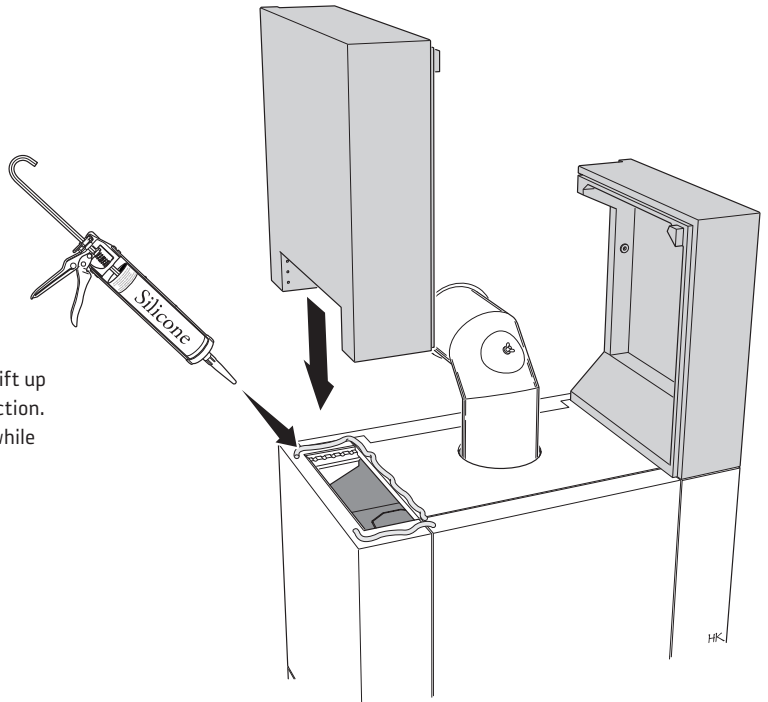

Hang the safety rail between the sides and ensure that they are straight. Check that the width is the same as section 1 at the front and rear edges.

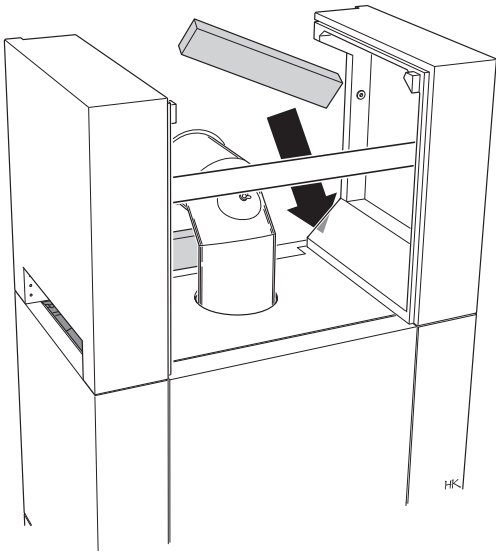

Insulate the rear edge of the top surface using one of the two smaller insulation pieces.

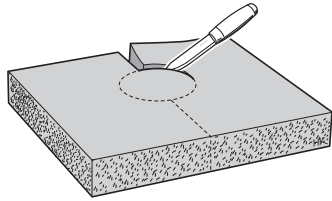

Cut the large sheet of insulation so that it fits around the chimney flue and position it so that it covers the whole of the top surface.

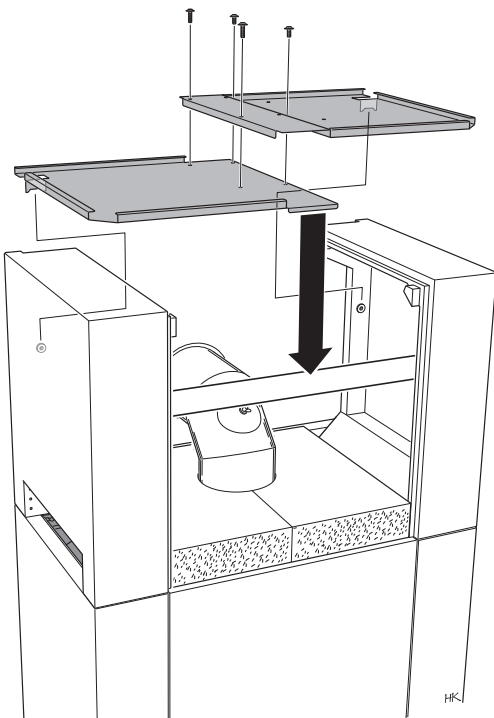
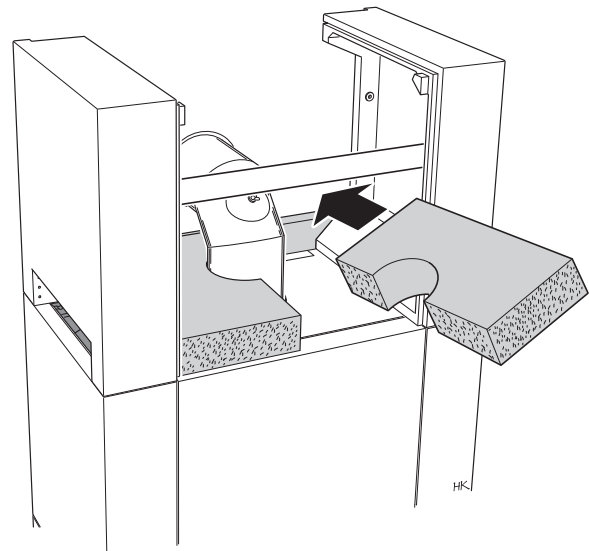

Place the left sealing plate so that it rests on the washer at the rear edge, and the lock rail at the front.

Lift in the right sealing plates and screw them into place in each other. Which holes are used depends on whether it is a Contura 11 or 21.

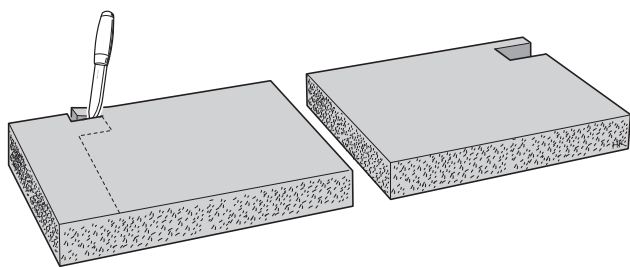

Cut the insulation sheets and seal above the seal plates.

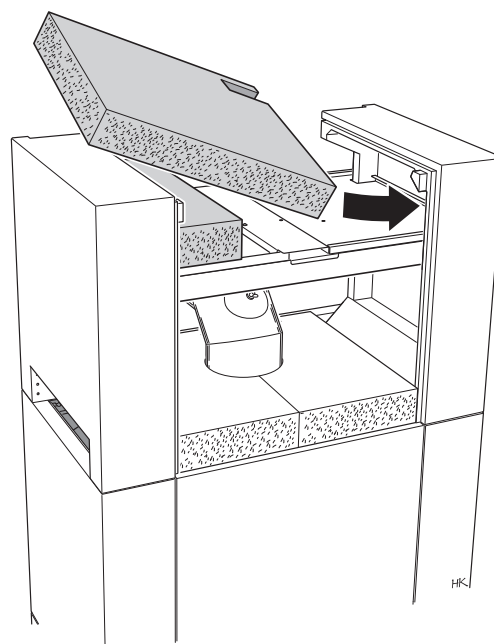
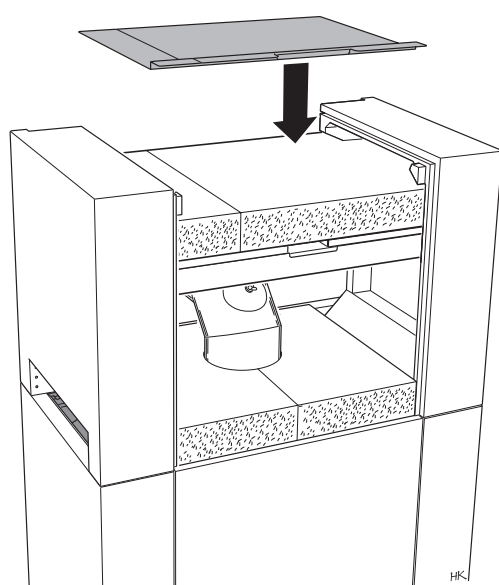

Place the top plate in position between the concrete sides. For the top panel to fit the Contura 2.1 the breakouts in the side must be removed.

To avoid gaps in the panel lines of the front area, the height extension panel must be hung first without silicone. Adjust the components so that the joints between them look good, use shims where necessary.

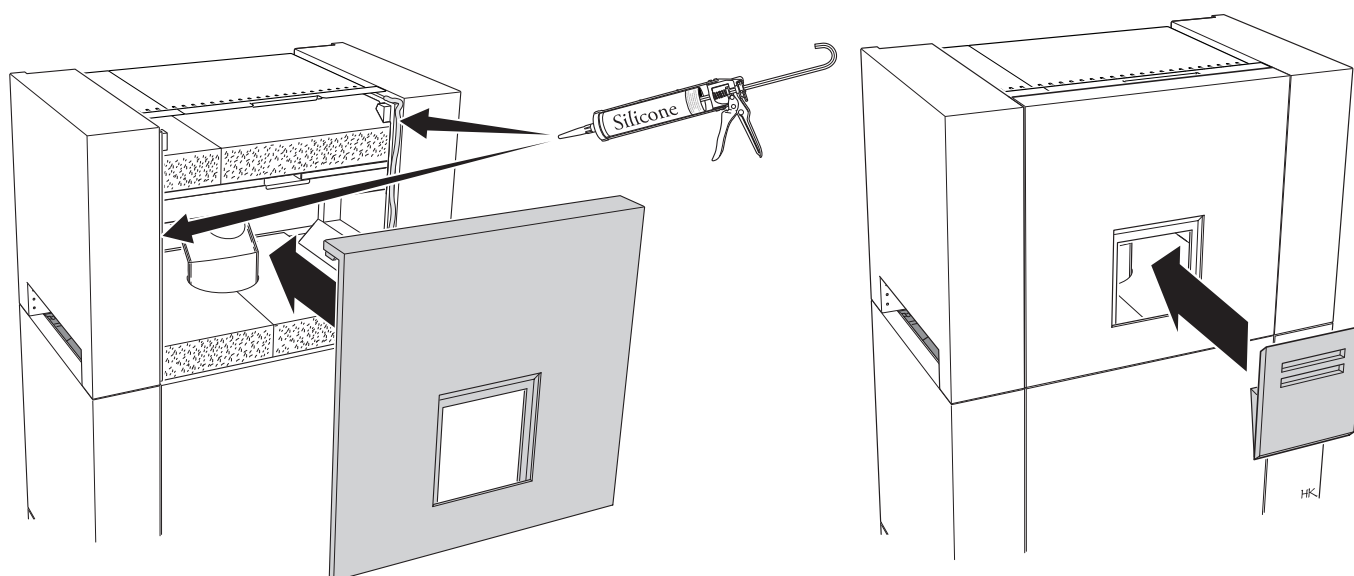

Concrete variant

Apply silicone along the front edge of the sides and bond the front in position. Position the soot hatch loosely without silicone to make it possible to sweep through the front.

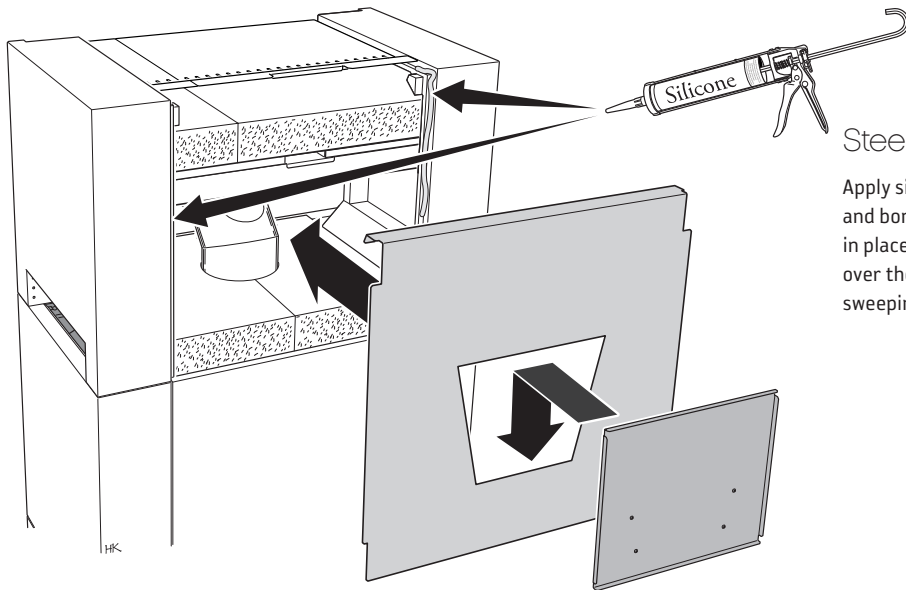

Steel variant

Apply silicone beads along the front edge of the sides and bond the inner front panel. Hang the soot hatch in place. The normal front panel then hangs loosely over the inner front panel and can be removed when sweeping.

The surround can now be joined and painted according to page 57, after which the grilles can be put in place.

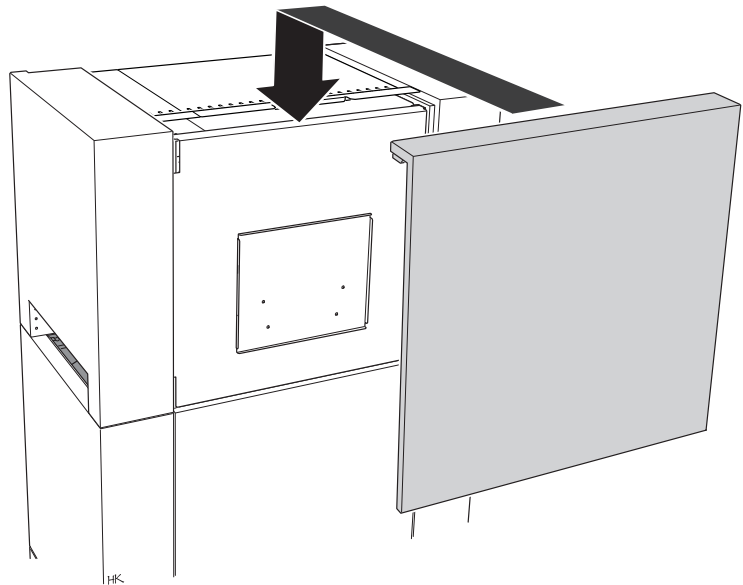

Final inspection of the installation

Before the stove is used, it must be inspected by an authorised chimney sweep. Read the "Instructions for Lighting the CI 10 / CI 20 series" before lighting the fire for the first time.



Installing the woodbox

The woodbox consists of four pieces that are bonded to each other and the surround using silicone. First bond the base plate and then the back, sides and upper section. The woodbox can be turned both ways for positioning on either the left or right side.

If the surround has been raised using shims, the log box must also be raised to align with the surround.

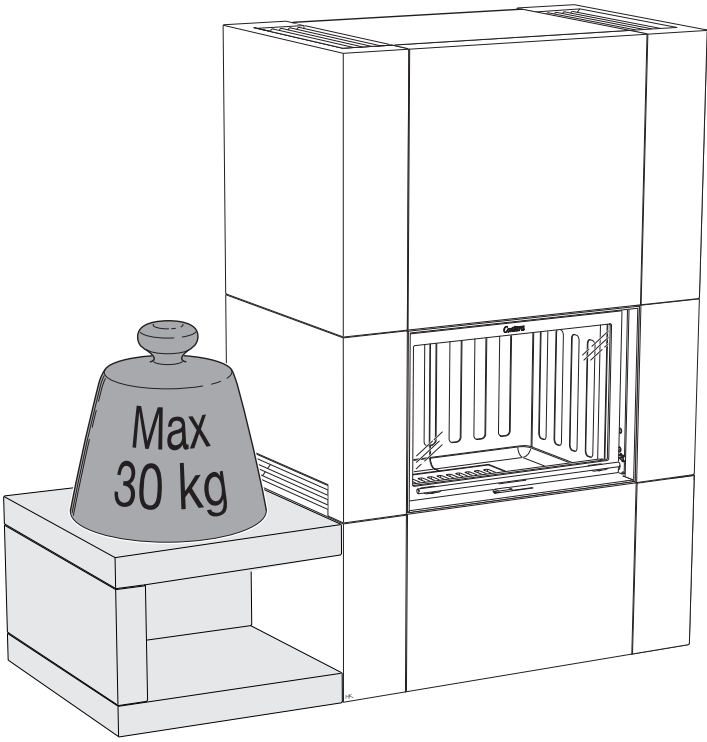
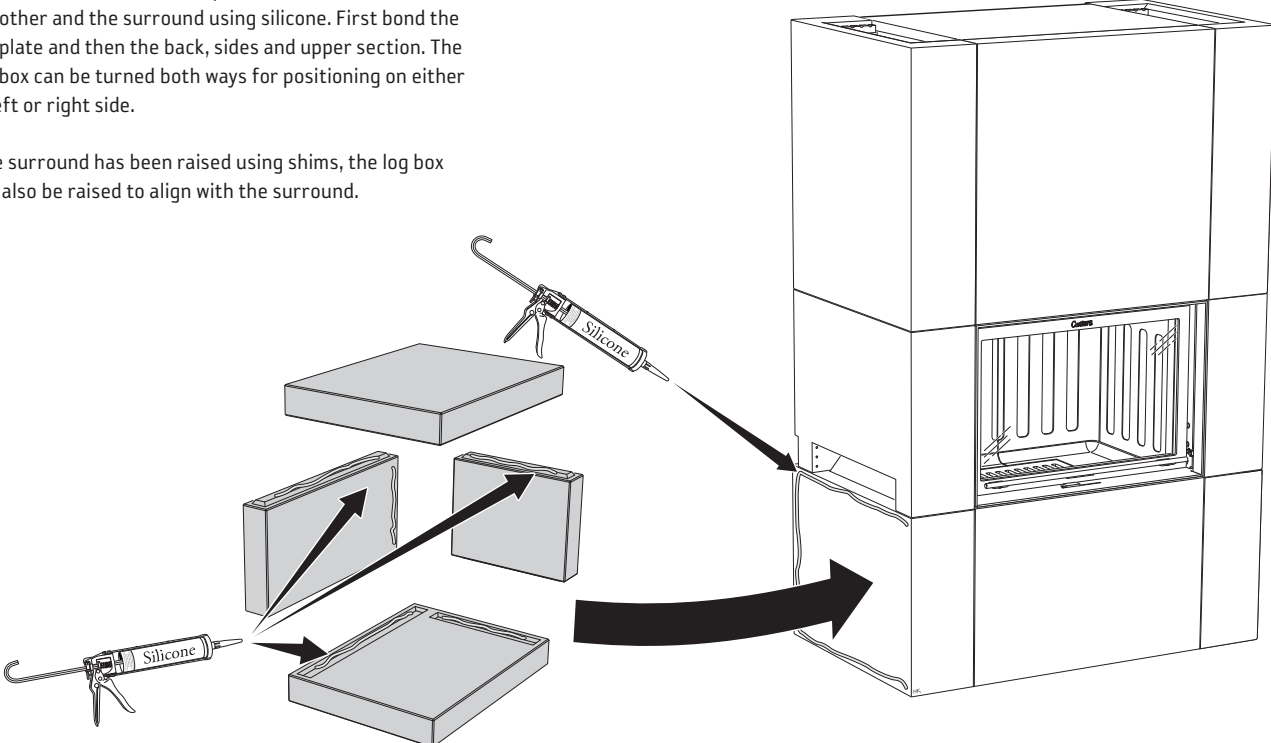

Contura

NIBE AB · Box 134 · 285 23 Markaryd · Sweden
www.contura.eu

Contura reserves the right to change dimensions and procedures described in these instructions at any time without special notice. The current edition can be downloaded from www.contura.eu

811041 IAV SE-EX C11/C21- 8
2014-11-04