

Contura

i7
i7G

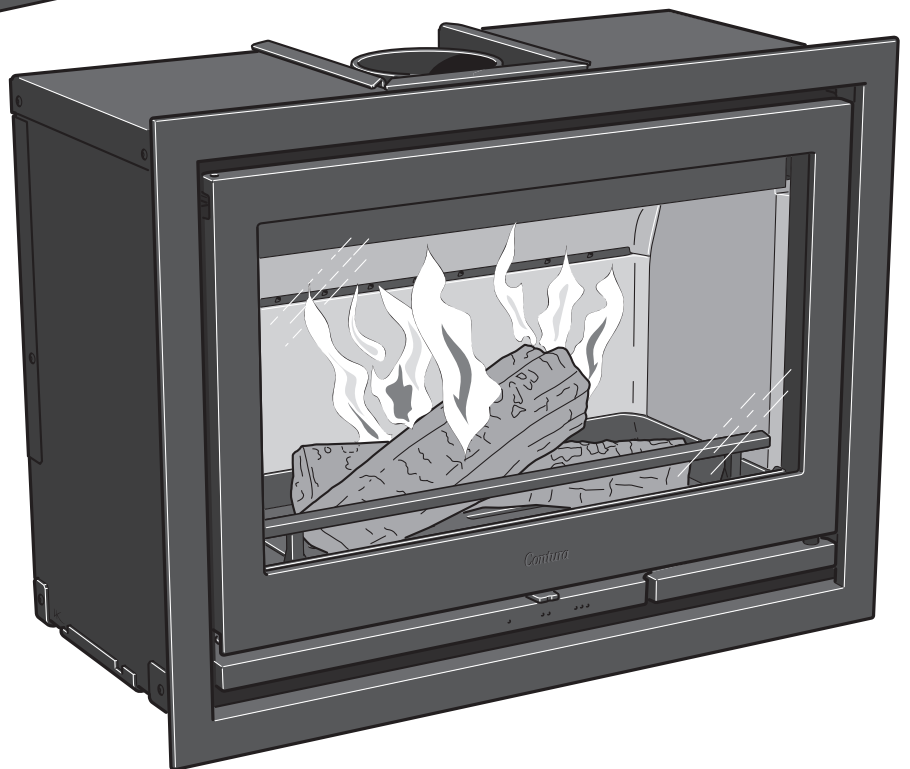

Facts

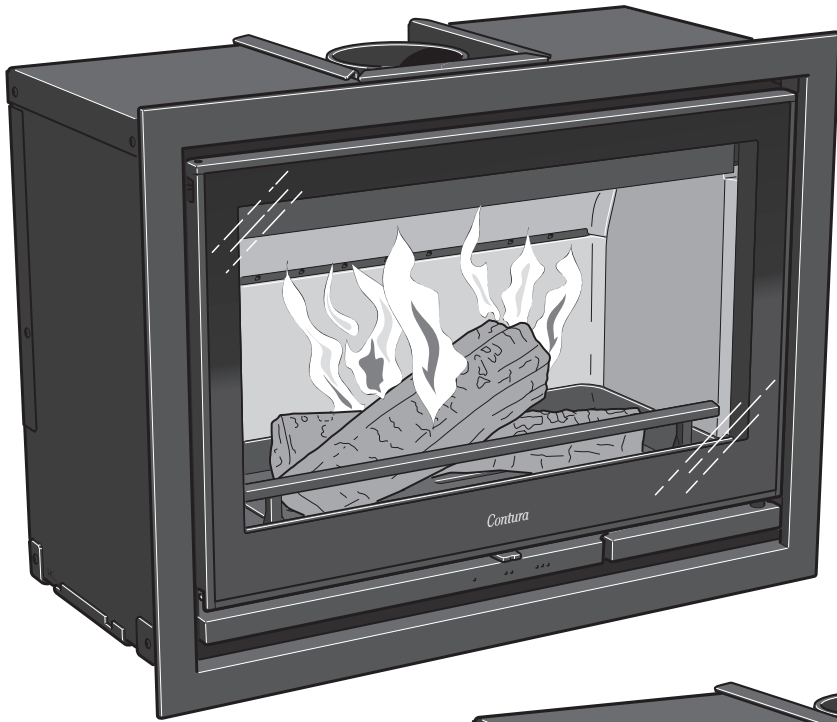

5-9 kW



585 mm



775 mm

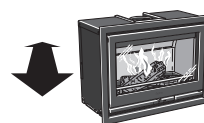

367 mm



100 kg

Nominal output
Efficiency

7 kW
77%

Meets requirements of:
European standard EN-13229
NS 3058/3059 (Norway)
DEFRA, Smoke control areas (UK)



The insert becomes very hot

Parts of the insert become very hot when it is in use and can cause burns if touched. You should also be careful of the heat that transfers through the door glass. Combustible materials must be kept at the stated safe distance to prevent the risk of fire. A smouldering fire emits gases that can suddenly ignite and cause material damage and personal injury.

Installation by a licensed professional

This manual contains instructions on how to assemble and install the insert. We recommend the insert be installed by a qualified tradesperson to ensure it functions safely and properly. Contact one of our dealers who can recommend professional installers.

Planning permission

You must apply for planning permission from your local authority before installing a stove or erecting a chimney. We recommend you contact your local authority for advice and information on planning permission.

Structural support

Check that the floor joists are strong enough to bear the weight of the insert, chimney and construction parts.

Hearth plate

A hearth plate must be installed to protect a combustible floor from the risk of falling embers. It must extend 300 mm in front of the hearth and can be made of natural stone, concrete, metal or glass.

Final inspection of the installation

When it has been installed, the insert must be inspected by a licensed chimney sweep before it can be used. You should also read the "Lighting instructions" before lighting the stove for the first time.

Connection to chimney

- The insert must be connected to a chimney designed to withstand flue gas temperatures of up to 400°C.
- The external diameter of the connection sleeve is 150 mm.
- In normal operating mode, draft in the chimney should be 20-25 Pa close to the connection sleeve. The draft is affected primarily by the length and area of the chimney and also by how well sealed it is. The recommended minimum flue length is 3.5 m and its diameter should be Ø125 to Ø150 mm.
- Sharp bends and horizontal lengths in a flue pipe reduce the draft in the chimney. The maximum horizontal length of flue pipe allowed is 1 m, provided the flue pipe rises vertically for at least 5 m.
- It must be possible to sweep the full length of the flue, and the soot doors must be easily accessible.
- Carefully check that the chimney is sealed and that there is no leakage of smoke from the soot doors or connections. See page 58.

Combustion air supply

When an insert is installed, the need for an adequate supply of air to the room increases. Air can be provided indirectly via a vent in the outer wall or via a duct from the outside that connects to the sleeve on the underside of the insert. The required volume of combustion air is about 20 m³/hour.

The outer diameter of the combustion air connection sleeve is 65 mm. If a pipe is longer than 1 m, its diameter must be increased to 100 mm and a larger wall vent will be required.

In heated spaces, the flue must be insulated to prevent condensation using 30 mm mineral wool covered with a vapour barrier. The hole in the wall (or floor) at the exit point must be properly sealed with flue jointing compound.

A 1-metre combustion-air tube insulated to prevent condensation is available as an optional extra.

Recessing the insert

When recessing the insert, adjacent walls that are not classed as fire walls or are considered unsuitable for exposure to heat must be protected by non-combustible building material in accordance with the specifications below.

All joints on the non-combustible material must be sealed using the method recommended by the manufacturer. The space between the insert and the recess must be ventilated in accordance with specifications/dimensions diagrams.

Please refer to the manufacturer's installation instructions when connecting a steel chimney to a top outlet. Observe the requirements for the safe distance from the steel chimney to combustible materials. Because of the strong heat radiating from the door, combustible materials must be placed a minimum of 1,4 m from the door.

The insert must be installed with clearance to the building material, not in direct contact with it, to allow for thermal expansion of the insert.

Material requirements

The building material must not be combustible.

The thermal conductivity coefficient λ must be maximum 0.14 W/mK.

The building material must always be at least 100 mm thick.

Where the insulation properties of building material are given as a U-value, it must be maximum 1.4 W/ m²K.

List of suitable materials:

Aerated concrete: $\lambda = 0.12-0.14$

Vermiculite: $\lambda = 0.12-0.14$

Calcium silicate: $\lambda = 0.09$

Sealing

The recess must not go all the way up to the ceiling, leave an air gap of at least 20 mm closest to the ceiling. The recess must be sealed off above the convection exhaust. The seal must be 100 mm above the convection exhaust's upper edge and must be made of 100 mm non-flammable material according to the material requirements above. Use heat-resistant silicone, for example, between the seal and chimney.

Convection air

The convection air ventilates the surround, cools the insert and carries hot air out into the room. The total sum of the effective cross-section area up and down must not be less than the stated values. The air intake must be positioned somewhere between floor level and the bottom of the insert, at the front or on the sides of the recess. The air exhaust must be positioned above the highest point of the insert at the front or the sides of the recess. If the air intakes or exhausts are positioned on the sides, the areas for the left and right side respectively must be the same size to ensure that the insert is evenly cooled.

Check the minimum distance to the ceiling.

Convection air in: 200 cm²

Convection air out: 200 cm²

Floor and load-bearing base

Combustible flooring beneath the insert must be protected. The examples show the floor protected by a 50-mm calcium silicate board.

Ensure that the convection box is placed on a base strong enough to bear the weight of the stove and chimney.

The base must not block the flow of convection air in the space between the insert and recess.

Steel chimney on the insert

If the insert is to be connected to a module-based steel chimney, it must be connected via a chimney support panel (accessory). The weight of the steel chimney on the insert with the chimney support panel must be maximum 100 kg.

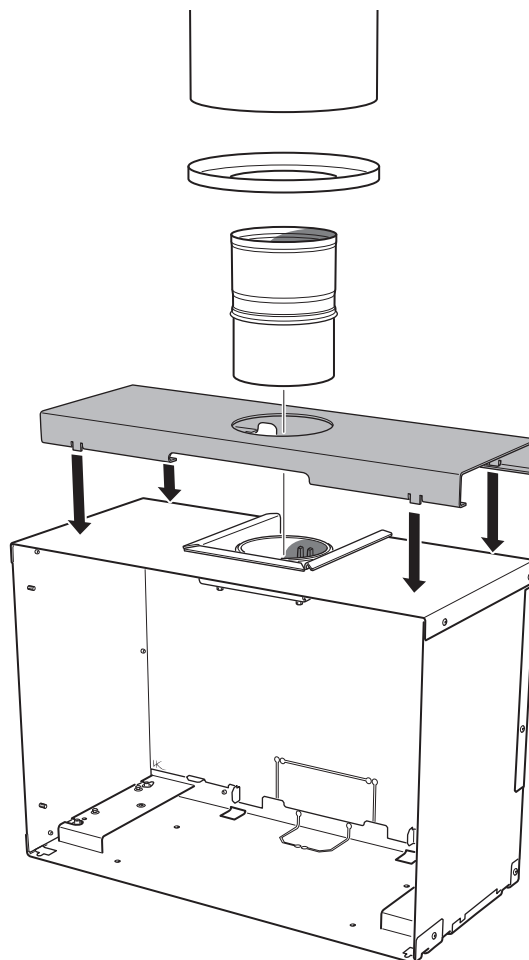

Recess example

Ci7

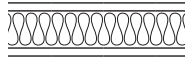

Wall made of combustible material

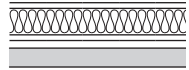

Aerated wall, comprising at least a 50 mm calcium silicate board and an air space. There must be a 20 mm air space between the building board and the combustible wall. The air space must allow air to flow freely along the lower and upper edges (see diagram to the right).

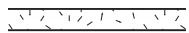

Wall made of non-combustible material that is not in contact with combustible material and therefore has no minimum thickness requirement.

 The dimensions are the minimum dimensions, unless otherwise stated.

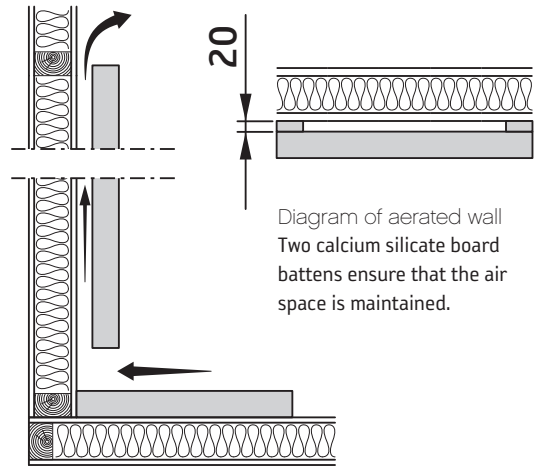
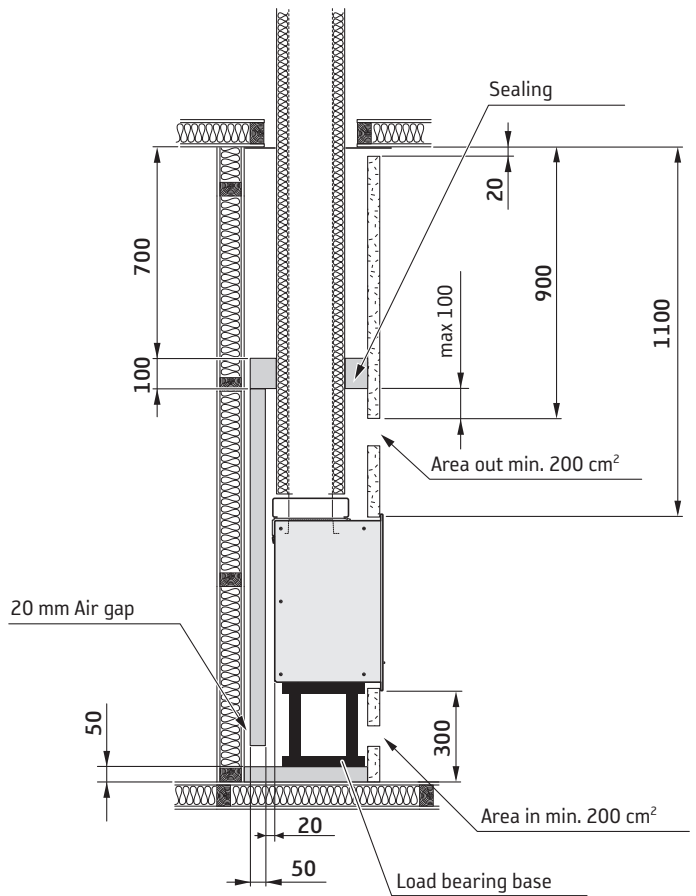
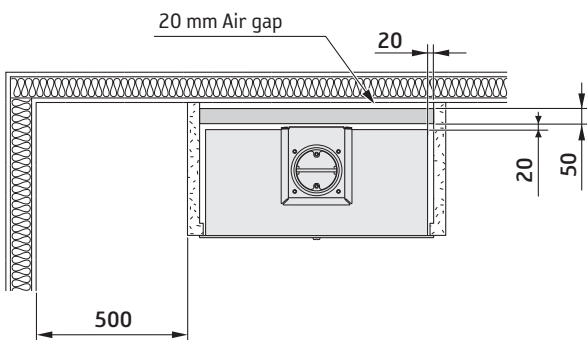
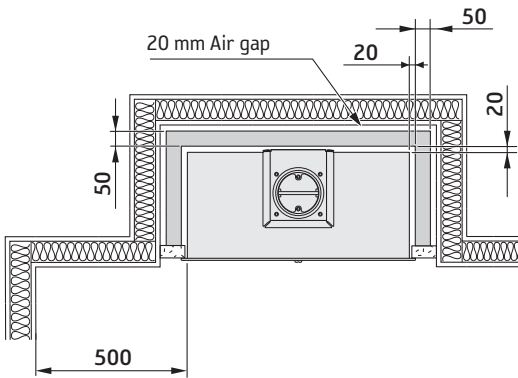

Diagram of aerated wall
Two calcium silicate board battens ensure that the air space is maintained.



Dimensions diagram

Ci7

Furnishings and combustible building elements must be at least 1,4 metre from the front of the insert door.

When connecting to a steel chimney, the requirements for safe distance to the chimney must also be observed. A clearance of at least 300 mm must be allowed as a safe distance between an uninsulated flue pipe and combustible building elements.

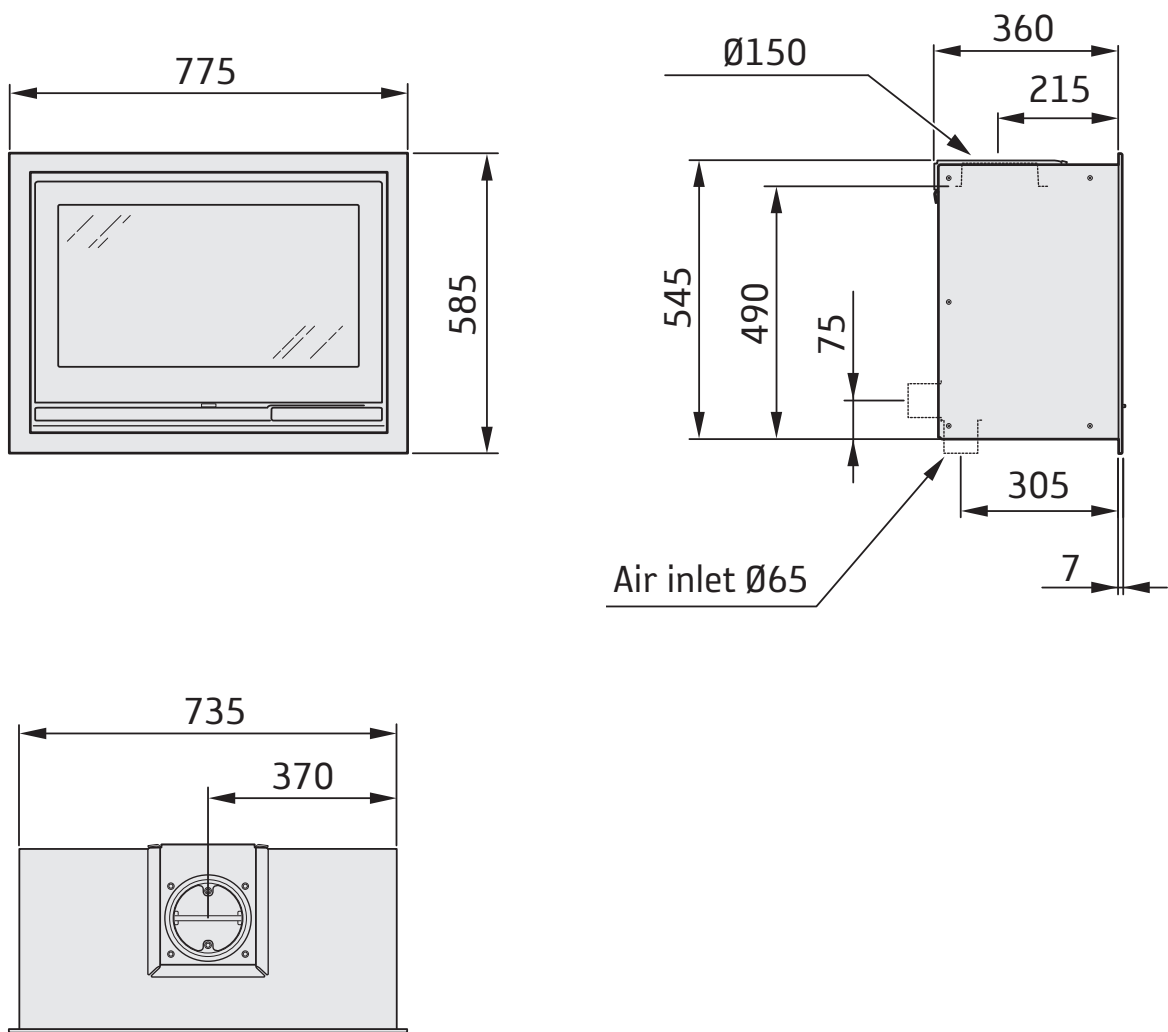

Declaration of performance according to Regulation (EU) 305/2011

No. Ci7-CPR-220901

Contura

PRODUCT

Type Wood burning insert
Trade name Contura i7
Intended area of use Heating of rooms in residential buildings
Fuel Wood

MANUFACTURER

Name NIBE AB / Contura
Address Box 134, Skulptörvägen 10
SE-285 23 Markaryd, Sweden

VERIFICATION

According to AVCP System 3
European standard EN 13229:2001 / A2:2004 / AC:2007
Test institute Rein-Ruhr Feuerstätten Prüfstelle, NB 1625.

DECLARED PERFORMANCE

ESSENTIAL CHARACTERISTICS	PERFORMANCE	HARMONISED TECHNICAL SPECIFICATION
Fire safety	Pass	EN 13229:2001 / A2:2004 / AC:2007
Fire classification	A1	
Minimum distance to flammable materials	Rear: 90 mm (with heat shield) Side: 500 mm Ceiling: 1100 mm Ceiling: 900 mm (front grate) Front: 1400 mm Floor: 300 mm Corner: 90 mm	
Fire hazard due to burning fuel falling out	Pass	
Cleanability	Pass	
Emissions from combustion	CO: 1500 mg/ m ³ NOx: 200 mg/ m ³ OGC: 120 mg/ m ³ PM: 40 mg/ m ³	
Surface temperatures	Pass	
Temperature on the handle	NPD	
Mechanical resistance	Pass	
Temperature in the space for wood storage	NPD	
Nominal output	7,0 kW	
Efficiency	77,0%	
Flue gas temperature at nominal output	308°C	
Flue gas temperature in flue spigot	369°C	

The undersigned is responsible for the manufacture and conformity with the declared performance.



Niklas Gunnarsson, Business area manager NIBE STOVES
Markaryd, 1st September 2022



EU Declaration of Conformity

Manufacturer	NIBE AB / Contura
Address	Box 134, Skulptörvägen 10 285 23 Markaryd, Sweden
E-Mail	info@contura.se
Website	www.contura.eu
Telephone	+46 433 275100

Contura

THIS DECLARATION OF CONFORMITY IS ISSUED UNDER OUR SOLE RESPONSIBILITY FOR THE FOLLOWING PRODUCT:							
Trade name		Contura i7 / i8 / Cosi					
Identification of product		www.contura.eu					
THE OBJECT OF THE DECLARATION DESCRIBED ABOVE IS IN CONFORMITY WITH -							
THE RELEVANT UNION HARMONIZATION LEGISLATION:				THE RELEVANT HARMONIZED STANDARDS:			
DIR 2009/125/EC		EN 13229:2001/A2:2004/AC:2007					
REG (EU) 2015/1185		CEN/TS 15883:2010					
REG (EU) 2015/1186							
REG (EU) 2017/1369							
REG (EU) 305/2011							
TECHNICAL DOCUMENTATION							
Indirect heating functionality:		No					
Direct heat output:		7,0 kW					
Energy Efficiency Index (EEI):		101,7					
Test report		RRF 29 17 4647 / RRF 29 20 5507, NB 1625					
FUEL	PREFERRED FUEL	OTHER SUITABLE FUEL	η_s (%)	EMISSIONS AT NOMINAL HEAT OUTPUT			
				PM	OGC	CO	NO _x
mg/ Nm ³ (13% O ₂)							
Wood logs with moisture content 25%	Yes	No	67,0	40	120	1500	200
Compressed wood with moisture content <12%	No	Yes	67,0	40	120	1500	200
Other woody biomass	No	No					
Non-wood biomass	No	No					
Anthracite and dry steam coal	No	No					
Hard coke	No	No					
Low temperature coke	No	No					
Bituminous coal	No	No					
Lignite briquettes	No	No					
Peat briquettes	No	No					
Blended fossil fuel briquettes	No	No					
Other fossil fuel	No	No					
Blended biomass and fossil fuel briquettes	No	No					
Other blend of biomass and solid fuel	No	No					
CHARACTERISTICS WHEN OPERATING WITH THE PREFERRED FUEL							
ITEM	SYMBOL	VALUE	UNIT	ITEM	SYMBOL	VALUE	UNIT
HEAT OUTPUT				USEFUL EFFICIENCY, BASED ON NET CALORIFIC VALUE (NCV)			
Nominal heat output:	P_{nom}	7,0	kW	Useful efficiency at nominal heat output	$\eta_{th,nom}$	77,0	%
AUXILIARY ELECTRICITY CONSUMPTION				TYPE OF HEAT OUTPUT/ROOM TEMPERATURE CONTROL			
At nominal heat output	$e_{l,max}$	-	kW	Single stage heat output, no room temperature control			Yes
At minimum heat output	$e_{l,min}$	-	kW	Two or more manual stages, no room temperature control			No
In standby mode	$e_{l,SB}$	-	kW	With mechanic thermostat room temperature control			No
				With electronic room temperature control			No
				With electronic room temperature control plus day timer			No
				With electronic room temperature control plus week timer			No
				OTHER CONTROL OPTIONS			
				Room temperature control, with presence detection			No
				Room temperature control, with open window detection			No
				With distance control option			
Specific precautions for assembly, installation, or maintenance.		Fire protection and safety distances to combustible building materials must be observed under all circumstances. A sufficient supply of combustion air must always be guaranteed. Air suction systems can interfere with the combustion air supply.					

The undersigned is responsible for the manufacture and conformity with the declared performance.



Niklas Gunnarsson, Business area manager NIBE STOVES
Markaryd, January 1, 2022

**SE** Montering

Om insatsen behöver läggas ned för att förflyttas bör lösa delar demonteras. Demontering av eldstadsbeklädnad beskrivs i slutet av denna anvisning.

- 1 Stosavsats
- 2 Eldstadsbeklädnad (Vermiculit)
- 3 Typskylt
- 4 Brasbegränsare
- 5 Roster
- 6 Eldstadsbotten

NO Før montering

Hvis innsatsen må legges ned for å flyttes, bør løse deler demonteres. Demontering av brennplater og hvelv er beskrevet mot slutten av denne veiledningen.

- 1 Stussplate
- 2 Brennplater og hvelv (Vermikulitt)
- 3 Typeskilt
- 4 Kubbestopper
- 5 Rist
- 6 Ildstedsbunn

FR Avant de procéder au montage

Les éléments non fixés devront être déposés si l'insert doit être couché pour être déplacé. Le démontage de l'habillage du foyer est décrite à la fin de ce document.

- 1 Rebord de manchon
- 2 Habillage du foyer (Vermiculite)
- 3 Plaque signalétique
- 4 Grille de retenue
- 5 Grille
- 6 Fond du foyer

GB Prior to installation

If the insert needs to be put down to be moved, loose components should be removed. Removal of the hearth cladding is described at the end of these installation instructions.

- 1 Connector sleeve support
- 2 Fire bricks (Vermiculite)
- 3 Type plate
- 4 Fire bars
- 5 Grate
- 6 Hearth base

DK Før opstilling

Hvis indsatsen skal lægges ned for at blive flyttet, bør løse dele afmonteres. Afmontering af ovnbeklædning beskrives i slutningen af denne vejledning.

- 1 Studsaftsats
- 2 Ovnbeklædning (Vermiculite)
- 3 Typeskilt
- 4 Brændeholder
- 5 Rist
- 6 Ovnbund

FI Ennen asennusta

Jos tulipesä pitää siirtää kyljellään, irto-osat pitää irrottaa. Tulipesän verhoilun irrotus kuvataan ohjeen lopussa.

- 1 Liitinsarja
- 2 Tulipesän verho (vermikuliitti)
- 3 Tyypikilpi
- 4 Suojareunus
- 5 Arina
- 6 Palotilan pohja

IT Prima del montaggio

Se è necessario smontare l'inserto per spostarlo, rimuovere prima i componenti liberi. La procedura di smontaggio del rivestimento del focolare è descritta alla fine delle presenti istruzioni.

- 1 Adattatore per canna fumaria
- 2 Rivestimento interno del focolare (vermiculite)
- 3 Targhetta identificativa
- 4 Griglia ferma-legna
- 5 Griglia
- 6 Fondo del focolare

NL Voorafgaand aan montage

Als de inzet liggend moet worden verplaatst, moeten losse onderdelen worden gedemonteerd. De demontage van de haardbekleding wordt beschreven aan het eind van deze instructies.

- 1 Afdekking aansluitstuk
- 2 Haardbekleding (vermiculiet)
- 3 Typeplaatje
- 4 Houtvanger
- 5 Rooster
- 6 Bodem verbrandingskamer

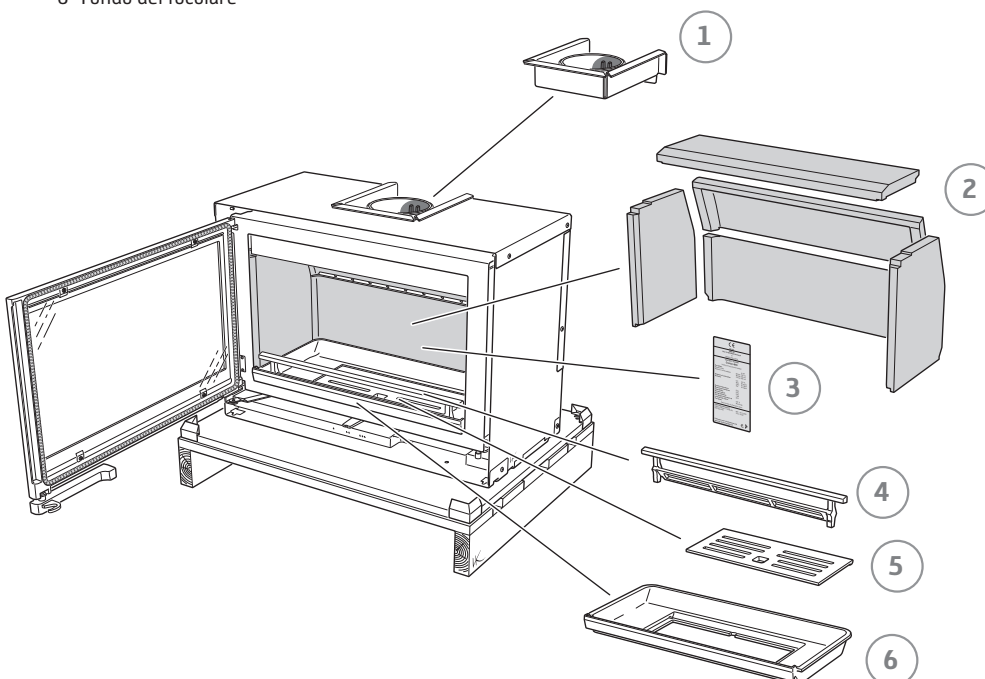

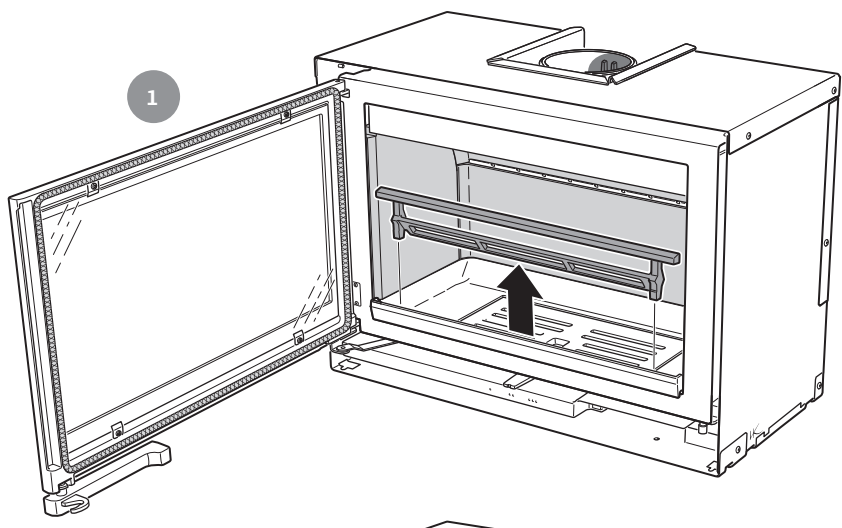

1

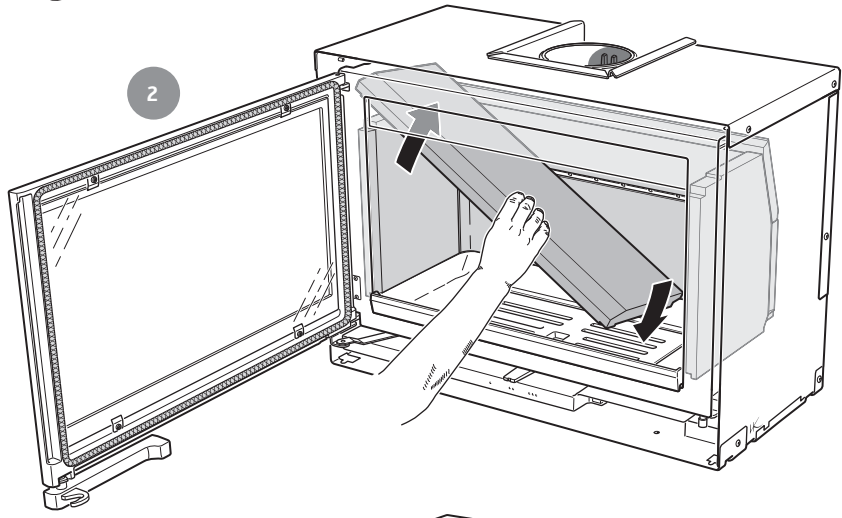

2

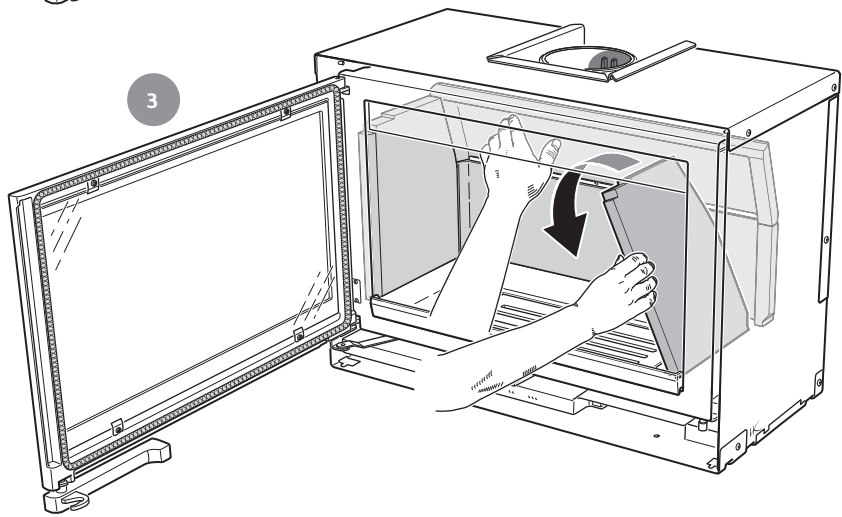

3

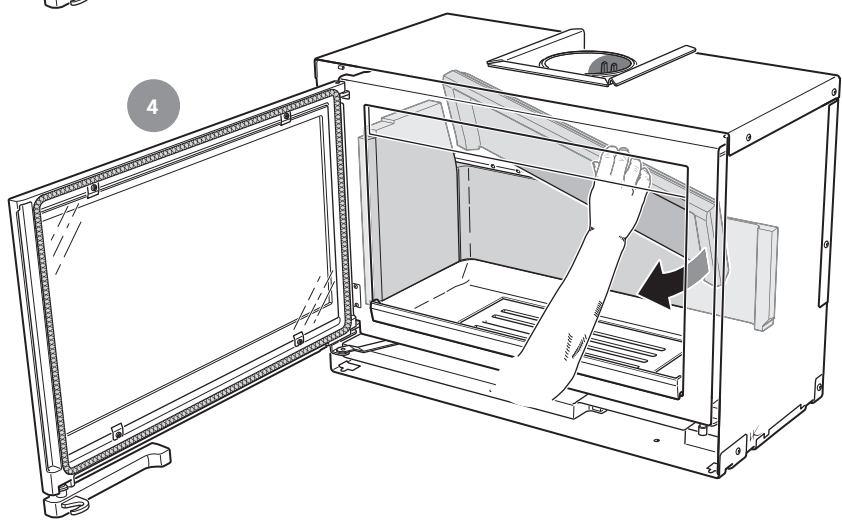

4

Handle with care!

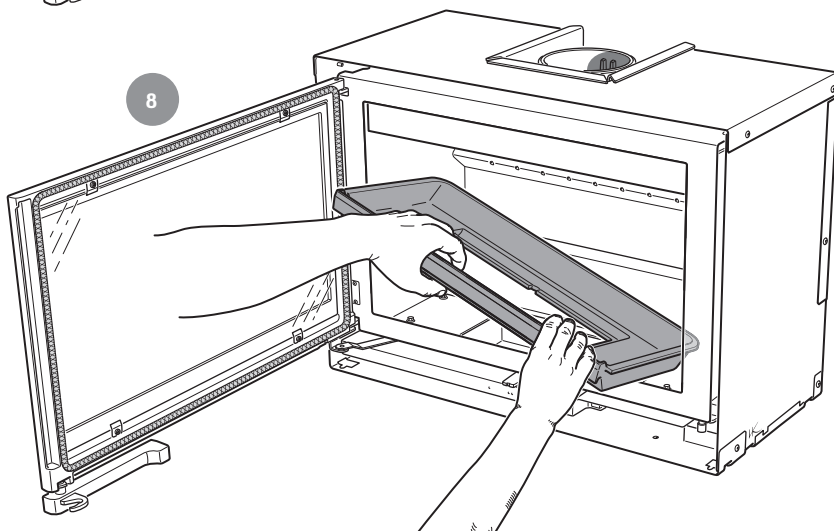
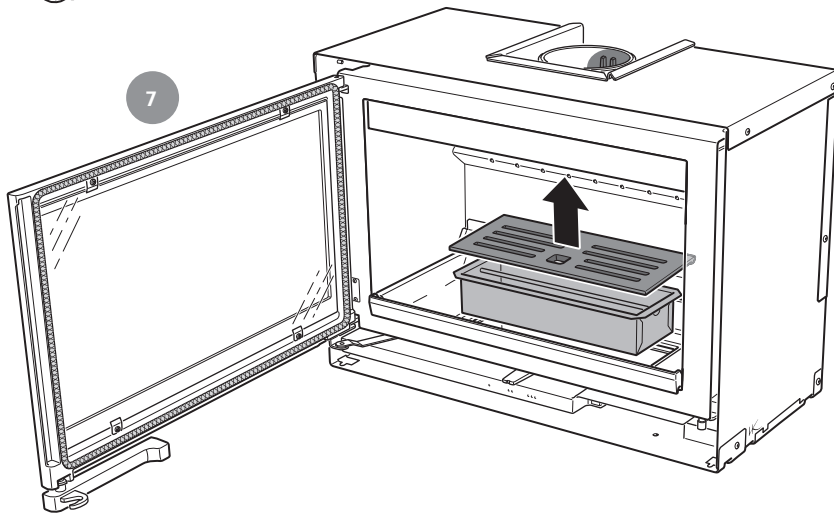
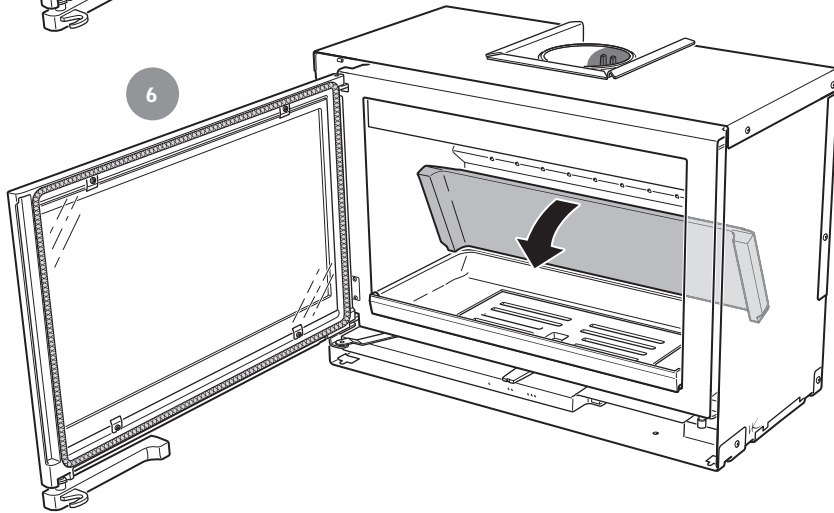
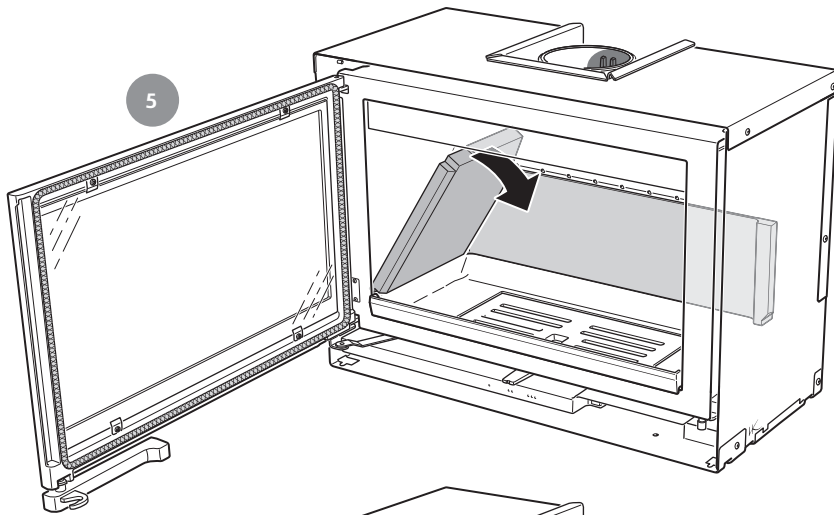



For installation in the UK and in smoke control areas

Mandatory for smoke control areas

Contura i7, 7 kW woodburning stoves has been recommended as suitable for use in smoke control areas. This when burning wood logs and operated in accordance with these instructions and when fitted with a permanent stop to prevent closure of the air control unit beyond 31% open position.

The permanent stop must be installed if the appliance is to be used in a smoke control area, this stop must not be removed in smoke control areas, otherwise an offence will be committed if the appliance is used without the permanent stop in place.

Damper Blocker for Ci7

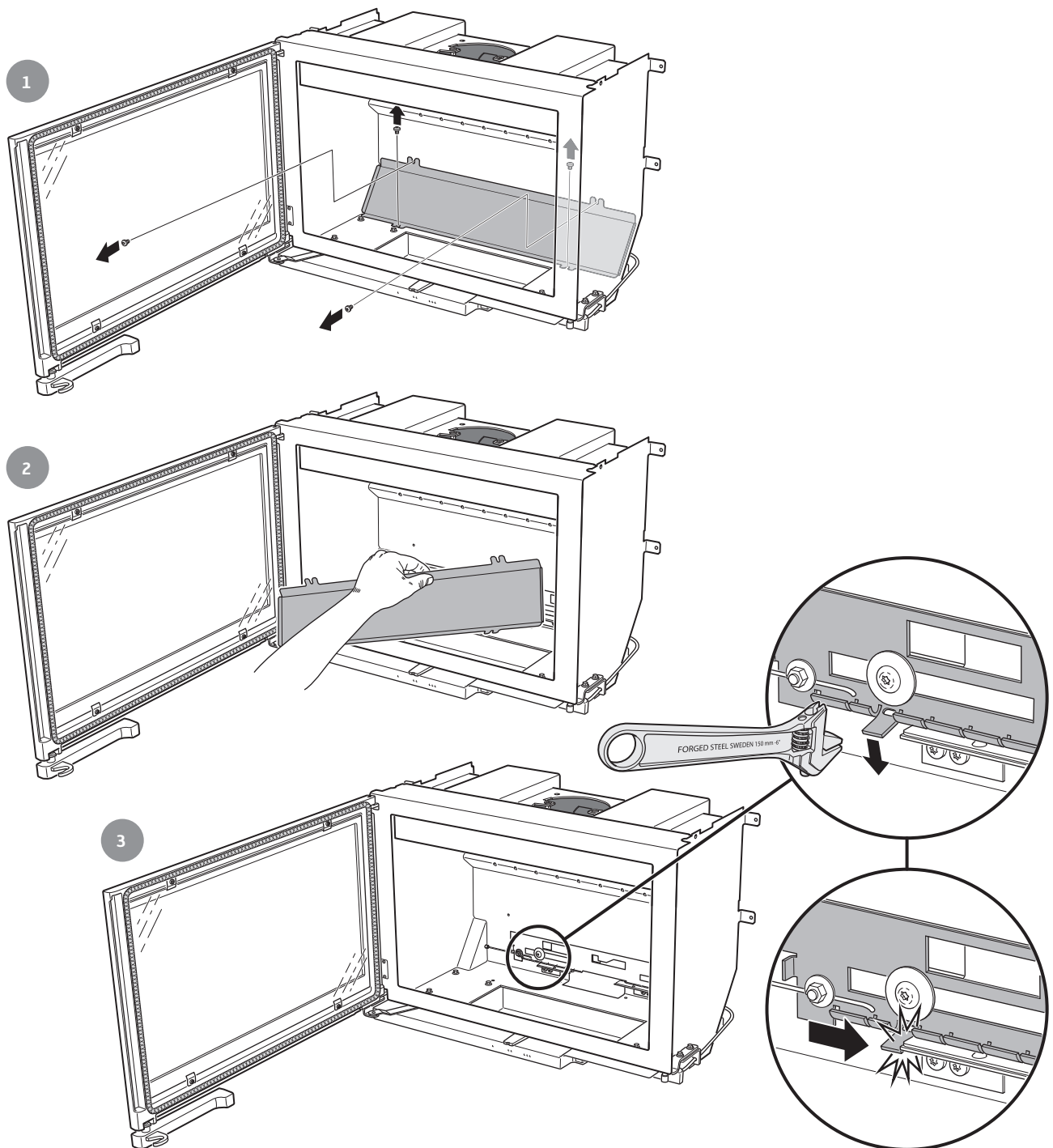

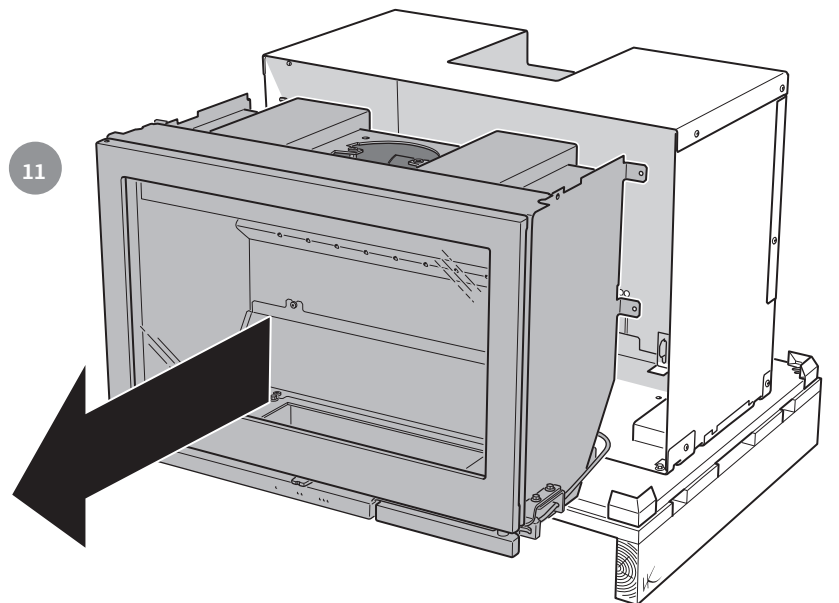
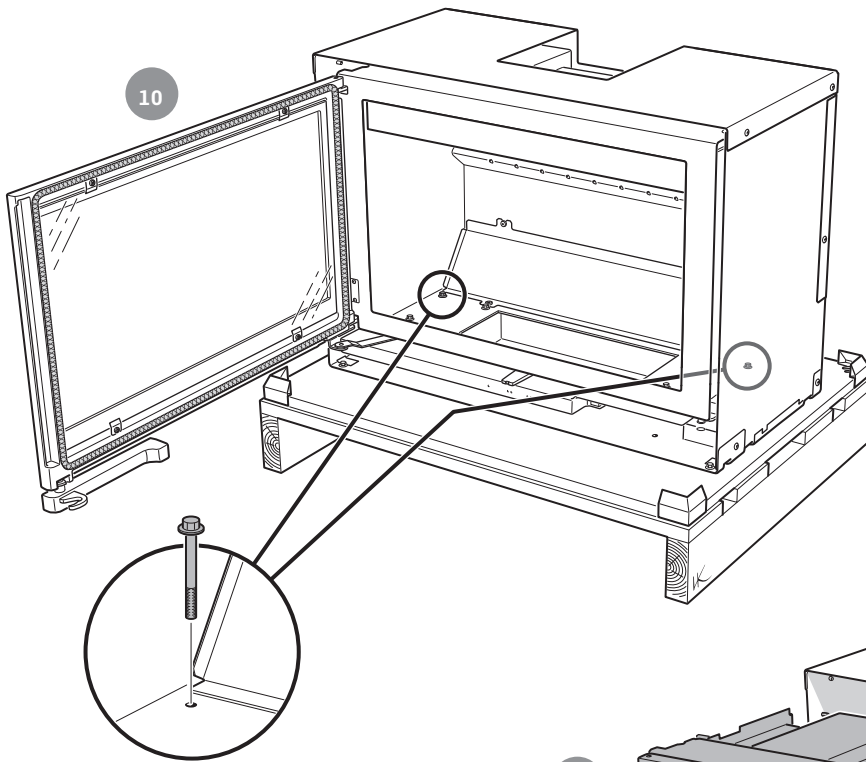
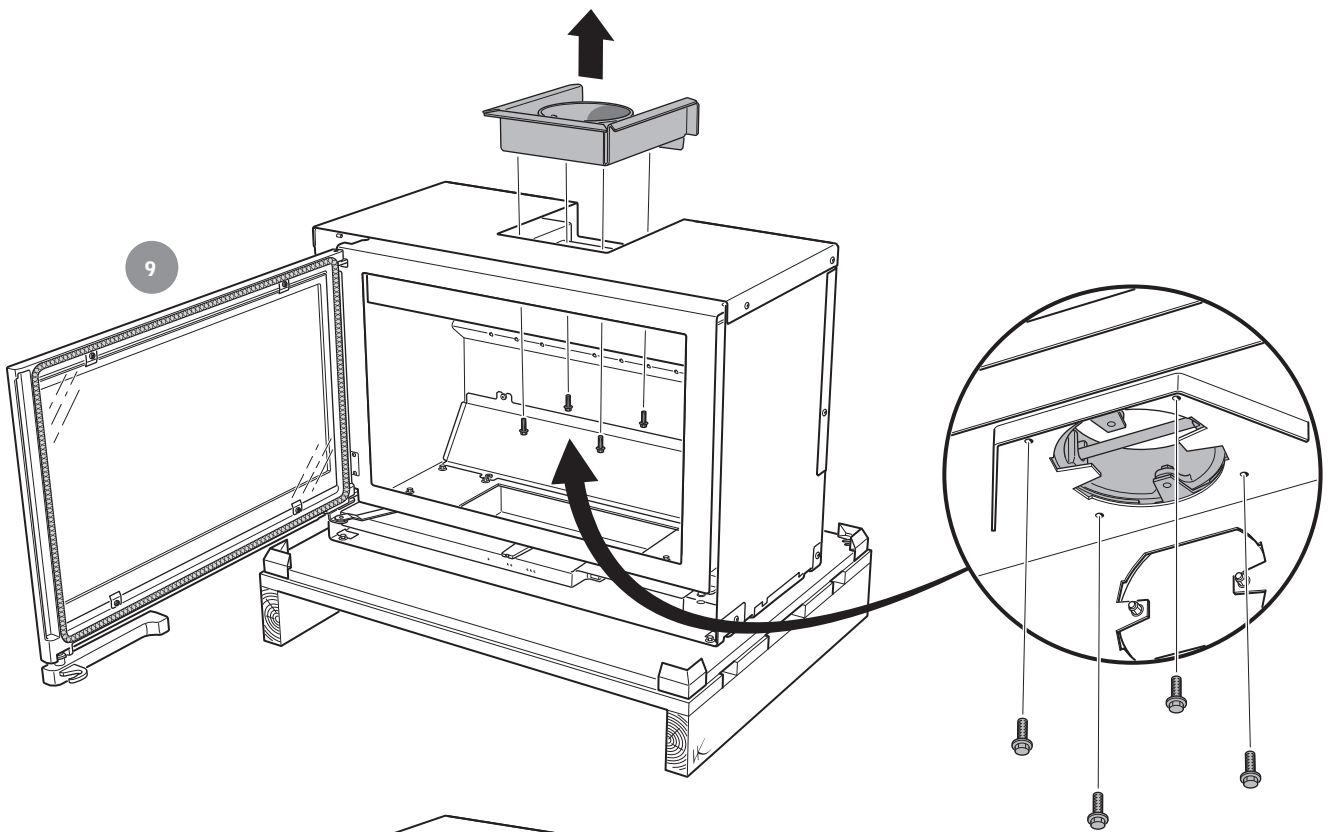

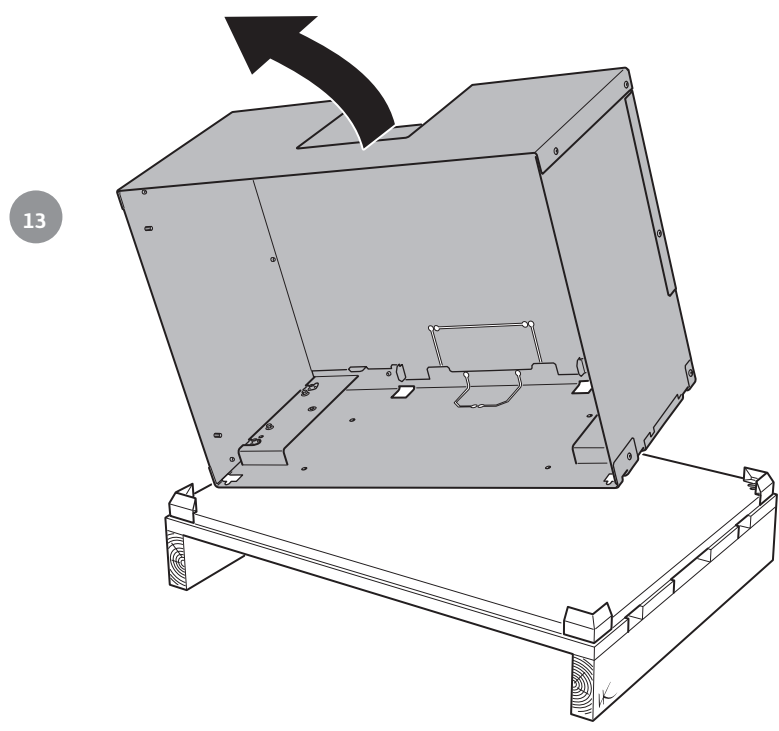
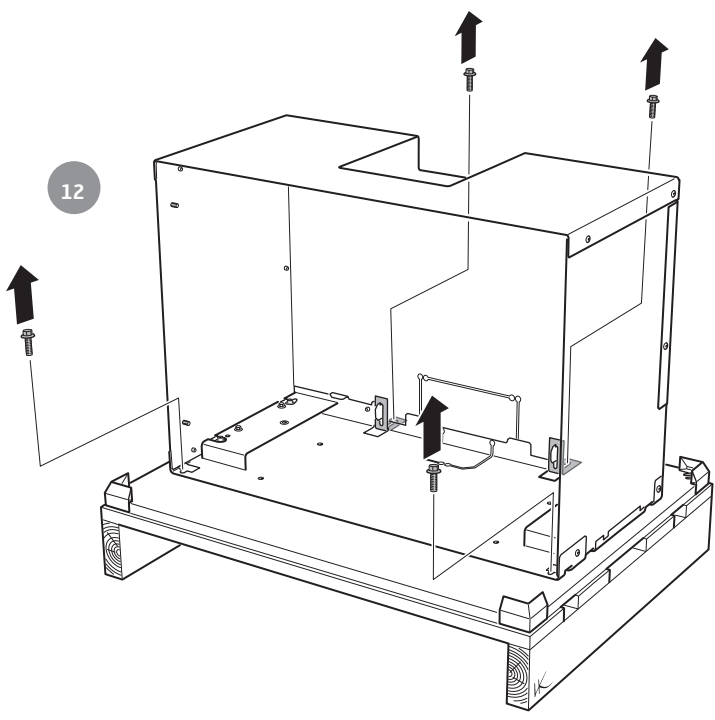

**SE** Installation i befintlig öppen eldstad

Innsatsen kan installeras som spiskassett i befintlig godkänd öppen eldstad. Runt om innsatsen skall det vara minst 10 mm luftspalt, detta pga. innsatsens värmeutvidgning.

NO Installasjon i eksisterende åpent ildsted

Innsatsen kan installeres som peiskassett i eksisterende godkjent åpent ildsted. På grunn av innsatsens varmeutvidelse skal det være en luftspalte på minst 10 mm rundt innsatsen.

FR Installation dans un foyer ouvert

L'insert peut être installé comme une cassette dans un foyer ouvert existant et homologué. Un espace d'au moins 10 mm doit être prévu autour de l'insert, pour des raisons d'expansion thermique.

GB Installation in existing open hearth

The insert is designed to be installed as a stove cassette in existing approved open hearths. There must be an 10 mm air gap around the insert, to allow for the expansion of the insert when hot.

DK Installation i eksisterende åbent ildsted

Indsatsen kan installeres som pejseindsats i et eksisterende godkendt åbent ildsted. Rundt om indsatsen skal der være en luftspalte på mindst 10 mm på grund af indsatsens varmeudvidelse.

FI Asennus olemassa olevaan avotakkaan

Takkasydän voidaan asentaa olemassa olevaan hyväksytyyn avotakkaan. Takkasydämen joka puolelle on jätävä vähintään 10 mm ilmarako takkasydämen lämpölaajenemisen vuoksi.

IT Montaggio in caminetti aperti già esistenti

L'inserto può essere installato in caminetti aperti già esistenti. Per favorire la normale dilatazione dell'inserto alle alte temperature, lasciare uno spazio libero di almeno 10 mm tutto attorno all'inserto.

NL Installatie in bestaande open haard

De inzet kan als inbouwhaard in een bestaande, goedgekeurde open haard worden geïnstalleerd. Rond de inzet moet in dat geval een luchtspleet van minimaal 10 mm worden aangehouden vanwege de expansie door warmte.

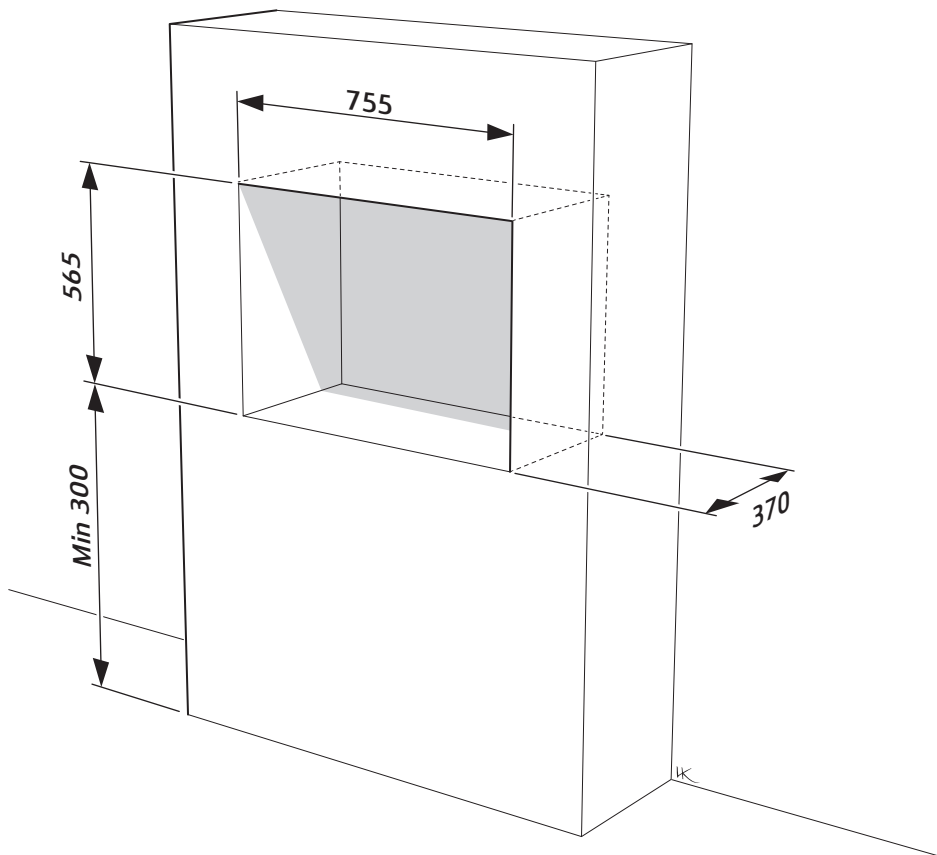

- SE** Anslutningsstos bakåt
Används då utrymme finns bakåt.
- NO** Tilkoblingsstuss bak
Brukes når det ikke er plass bak.
- FR** Manchon de raccordement vers l'arrière
Utilisé lorsqu'il y a suffisamment de place à l'arrière du foyer.
- GB** Connection kit back
Used when there is sufficient space to the rear.
- DK** Tilslutningsstuds bagud
Benyttes, når der er plads bagud.
- FI** Liitosputki taaksepäin
Käytetään kun takana on tilaa.
- IT** Raccordo sul retro
Si usa in presenza di spazio sul retro.
- NL** Aansluitstuk naar achteren
Wordt gebruikt als er ruimte aan de achterkant is.

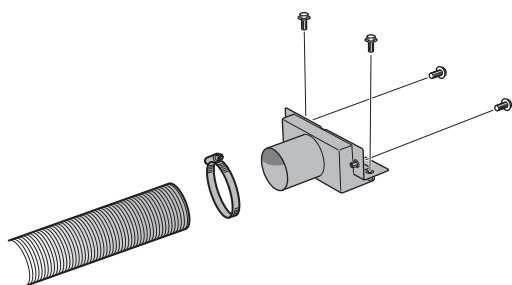

- SE** Anslutningsstos nedåt
Används då utrymme inte finns bakåt.
- NO** Tilkoblingsstuss nedover
Brukes når det ikke er plass bak.
- FR** Manchon de raccordement vers le bas
Utilisé lorsqu'il n'y a pas suffisamment de place à l'arrière du foyer.
- GB** Connector downward
Used when there is insufficient space to the rear.
- DK** Tilslutningsstuds nedad
Benyttes, når der ikke er plads bagud.
- FI** Liitosputki alaspäin
Käytetään kun takana ei ole tilaa.
- IT** Raccordo dal basso
Si usa in mancanza di spazio sul retro.
- NL** Aansluitstuk omlaag
Wordt gebruikt als ruimte aan de achterkant ontbreekt.

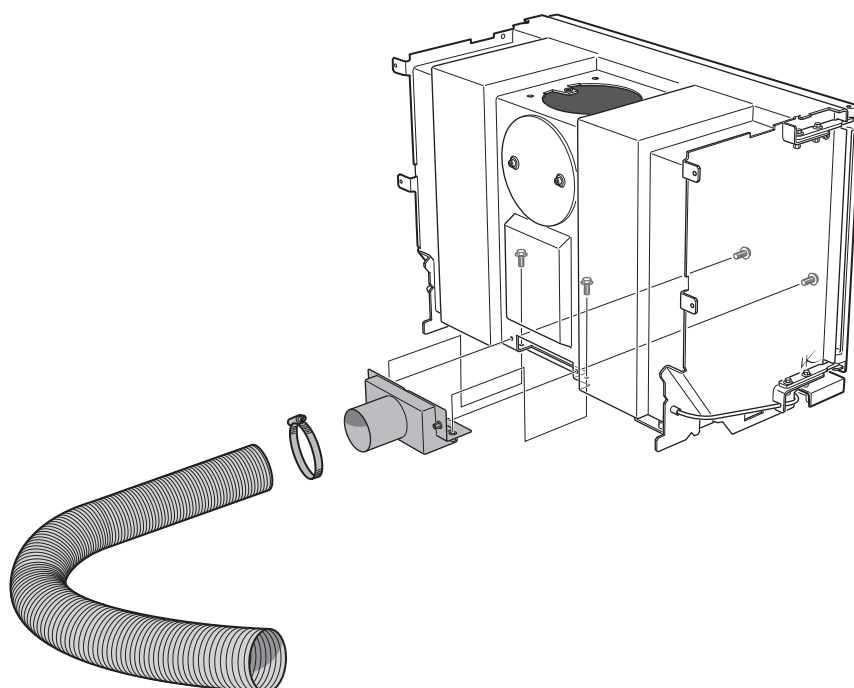
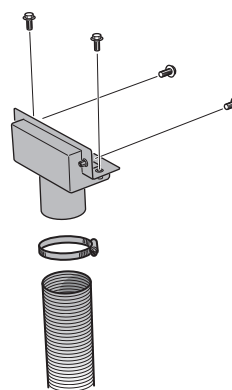



- SE** Anslutning till befintlig murad skorsten
För enklart montage rekommenderas att använda flexibel slang (säljs som tillbehör). Fäst stosen i slang. Anslut och tätta mellan slang och skorstenen enligt dess separata anvisning.
Insatsen kan även anslutas med fasta rör som förs upp i skorstenen.
- NO** Tilkobling til eksisterende murt skorstein
Det anbefales å bruke fleksibel slange for å gjøre monteringen så enkel som mulig. (selges som tilbehør). Fest stussen i slang. Koble til, og tett mellom slang og skorsteinen i henhold til separat anvisning for dette.
Innsatsen kan også kobles til med faste rør som føres opp i skorsteinen.
- FR** Raccordement à une cheminée de maçonnerie existante
Pour simplifier le montage, il est recommandé d'utiliser un tuyau flexible (proposé en option). Fixez le manchon dans le tuyau. Raccordez et scellez entre le tuyau et la cheminée selon les instructions séparées.
L'insert peut également être raccordé avec des conduits fixes dans la cheminée.
- GB** Connection to existing masonry chimney
A flexible hose is recommended for ease of installation (sold as an accessory). Secure the sleeve in the hose. Connect and seal carefully between the hose and the chimney according to the separate instruction.
The insert can also be connected with fixed pipe inserted up the chimney
- DK** Tilslutning til eksisterende muret skorsten
Det anbefales at benytte en fleksibel slange for den letteste montering (sælges som tilbehør). Sæt studsene fast i slang. Tilslut og tæt mellem slang og skorsten i henhold dennes særskilte vejledning.
Indsatsen kan også tilsluttes med faste rør, som føres op i skorstenen.
- FI** Liitäntä muurattuun savupiippuun
Asennuksen helpottamiseksi suositellaan joustavan letkun käyttöä (myydään lisävarusteena). Kiinnitä liitin letkuun. Liitä ja tiivistä letkun ja savupiipun väli erillisen ohjeen mukaan.
Takkasydämen voi liittää myös kiinteällä putkella, joka viedään ylös hormiin.
- IT** Collegamento alla canna fumaria esistente in muratura
Per la massima semplicità nel montaggio si consiglia di usare un tubo flessibile (in vendita come accessorio). Fissare il raccordo al tubo flessibile. Collegare il flessibile e sigillare lo spazio tra questo e la canna fumaria seguendo le relative istruzioni.
L'inserto può anche essere collegato con tubi rigidi da inserire nella canna fumaria.
- NL** Aansluiting op bestaande, gemetselde schoorsteen
Voor een zo eenvoudig mogelijke installatie wordt het gebruik van een flexibele slang aanbevolen (verkocht als accessoire). Zet het aansluitstuk vast in de slang. Sluit de slang op de schoorsteen aan en dicht af. Volg de aparte instructies.
De inzet kan ook met een vaste pijp worden aangesloten die in de schoorsteen wordt gestoken.



1

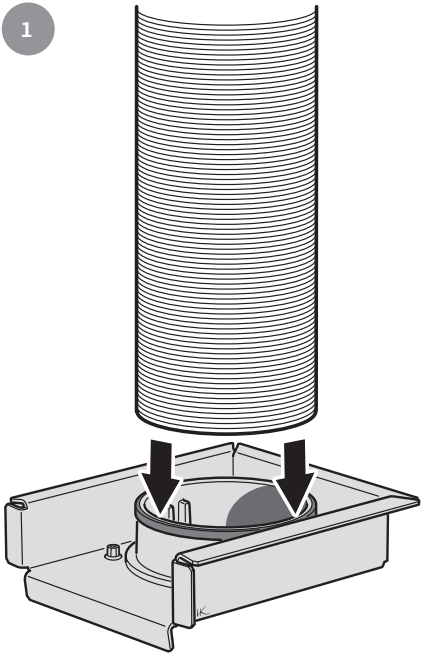

2

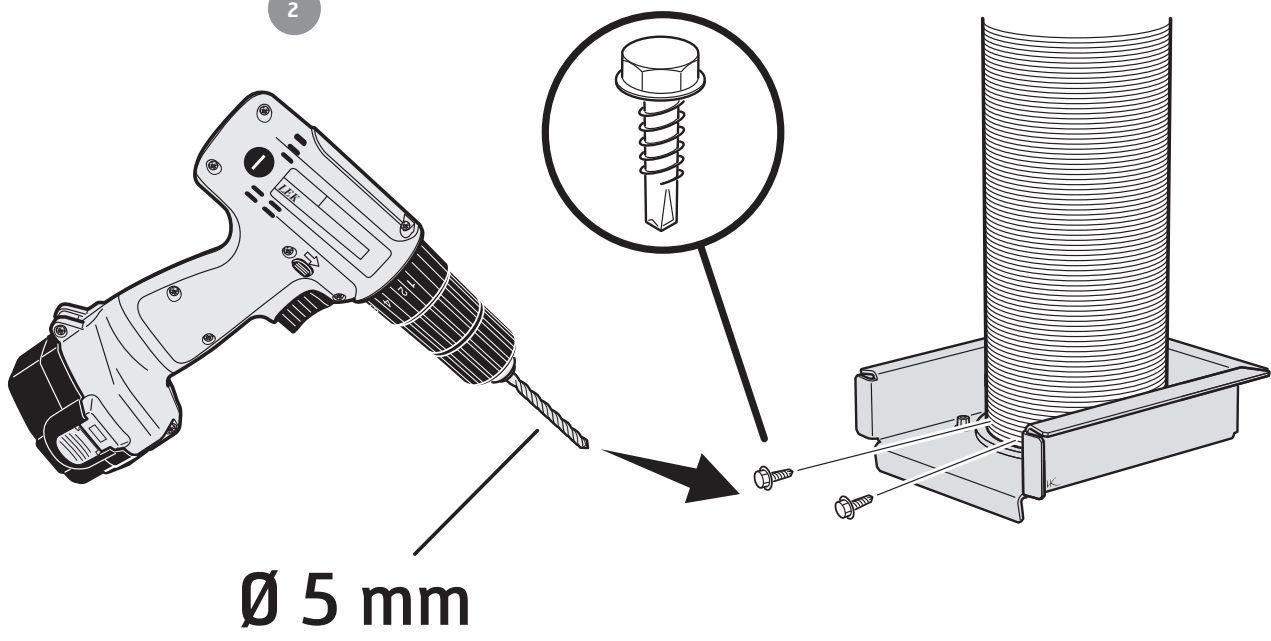



3

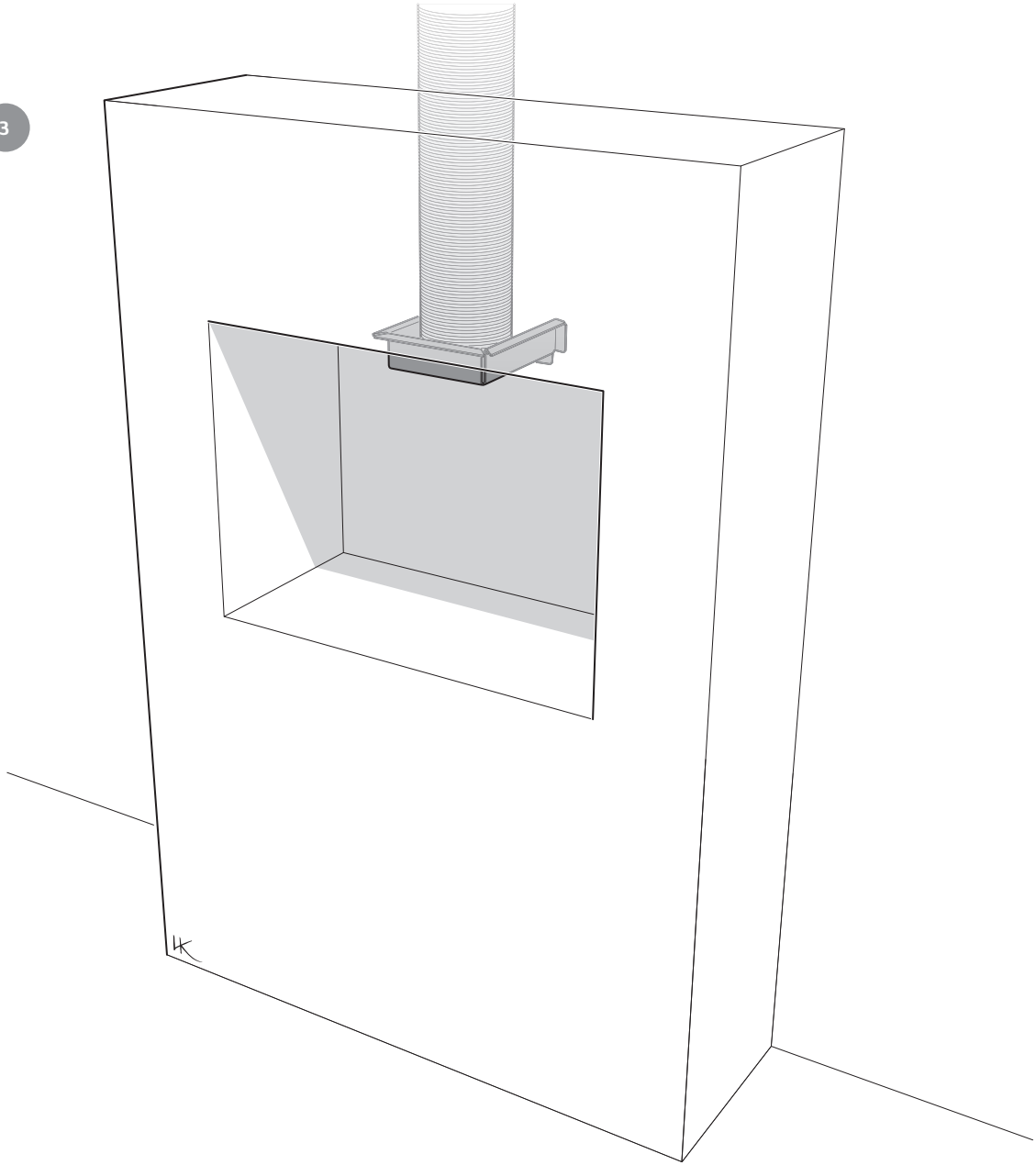

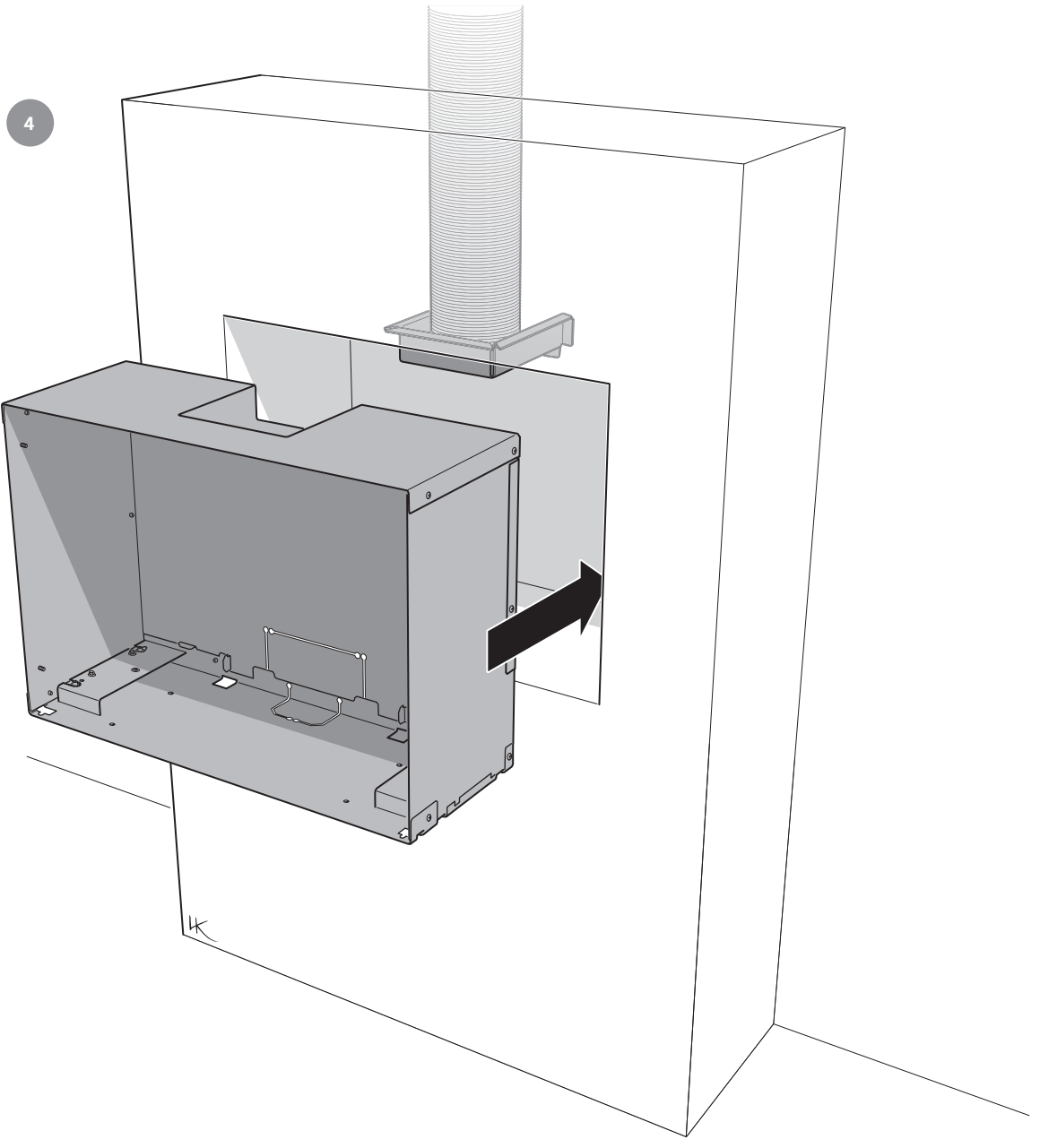



5

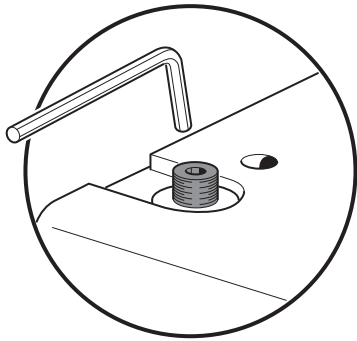

x4

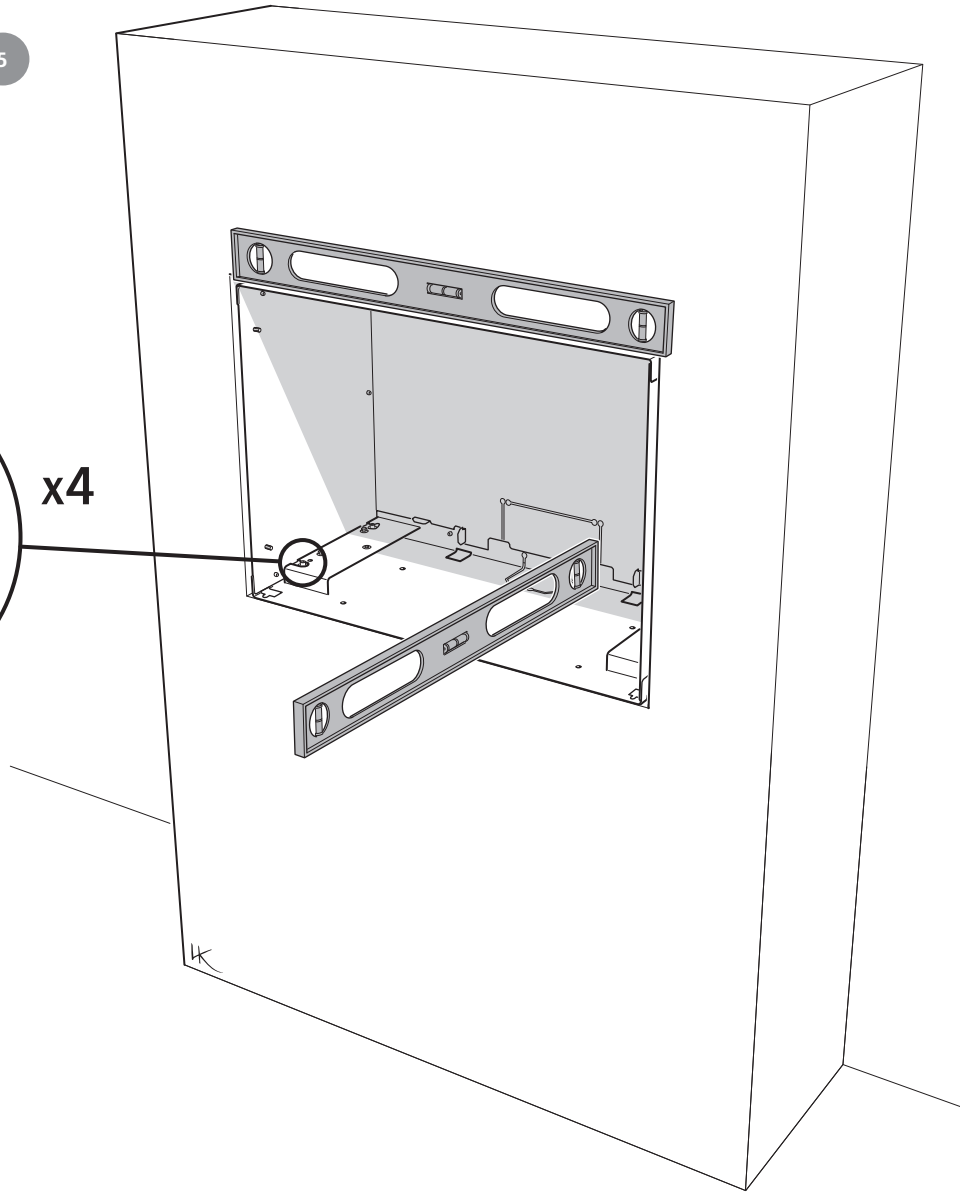



6

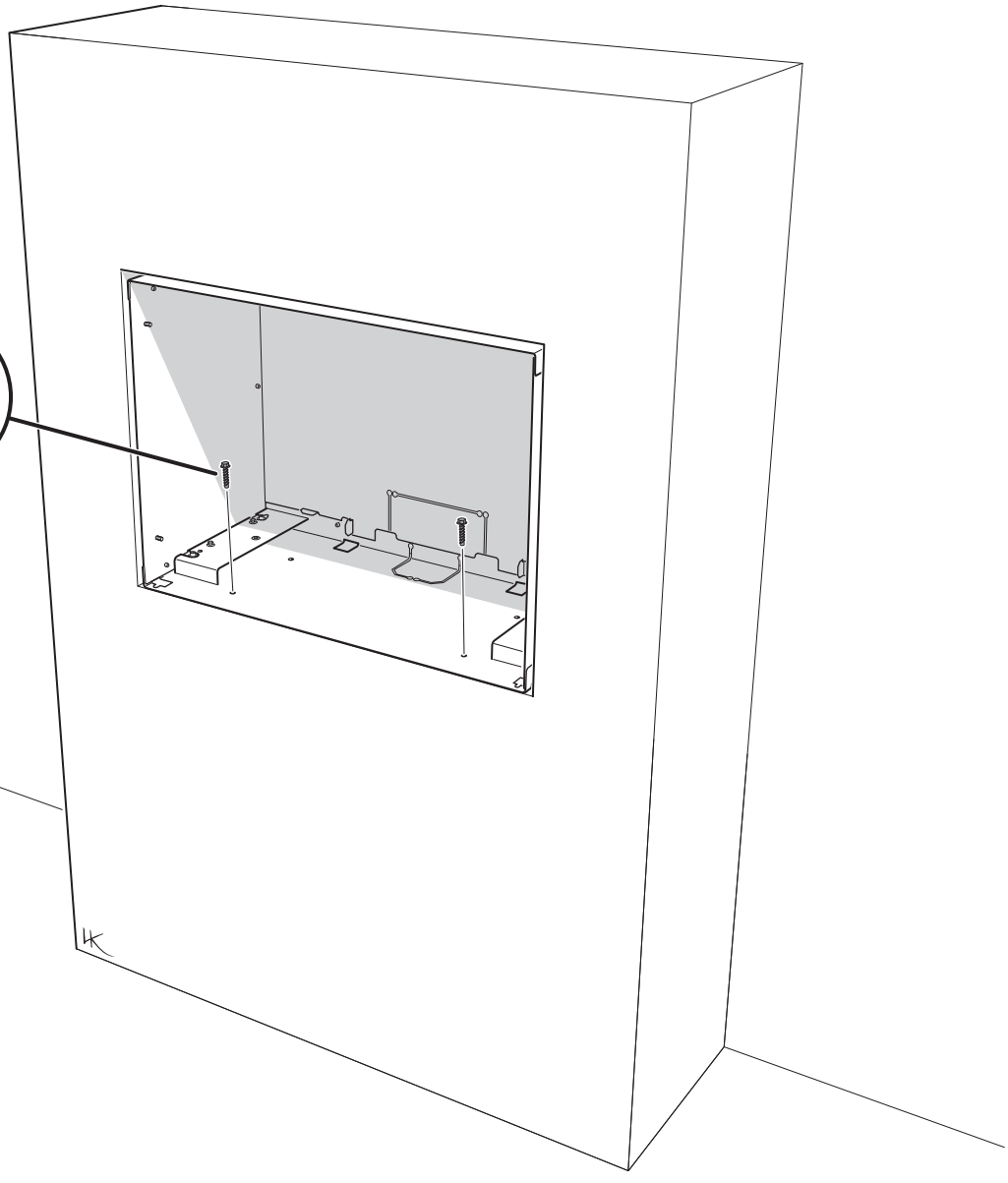
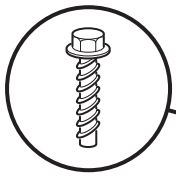



7

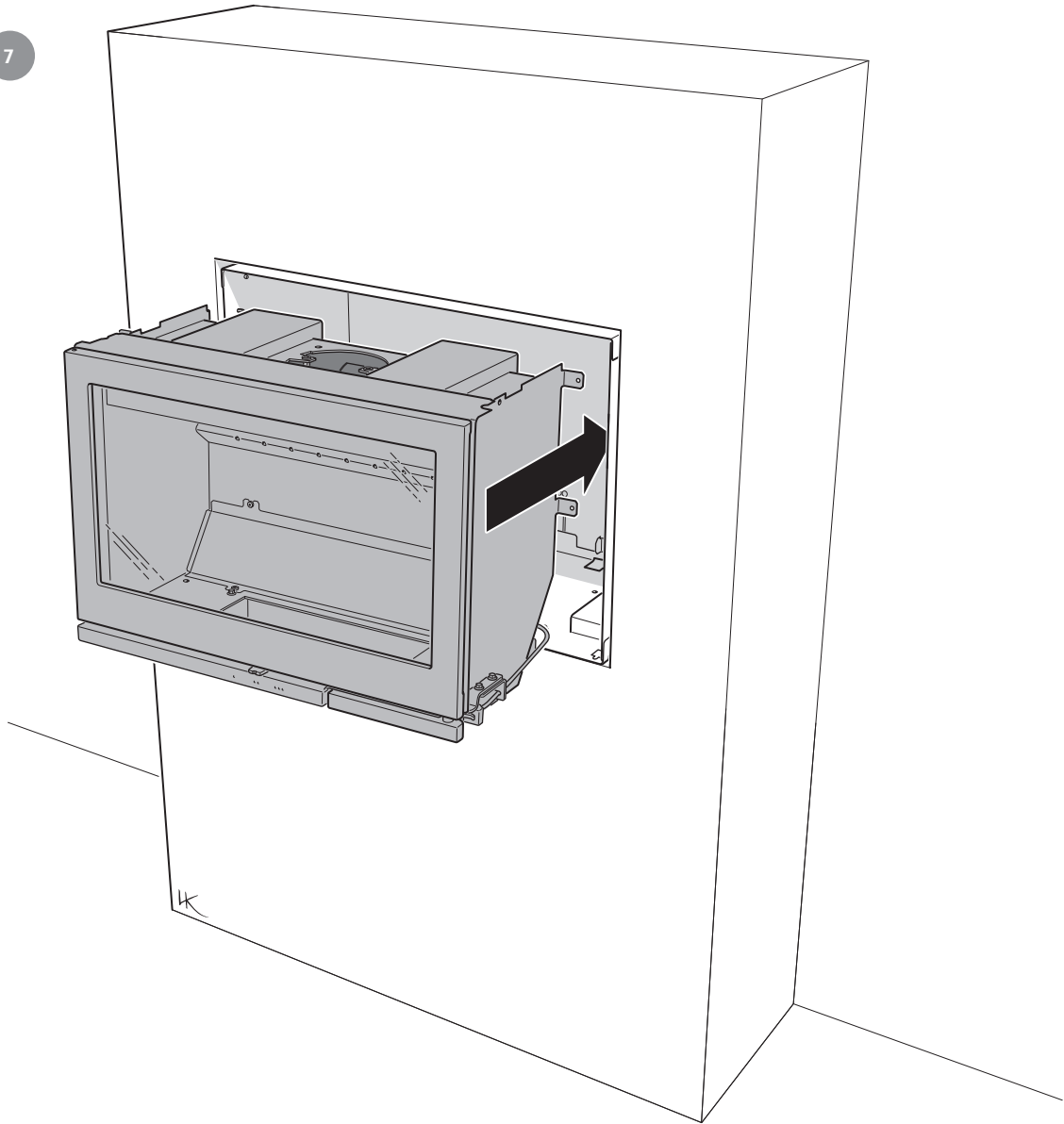



8

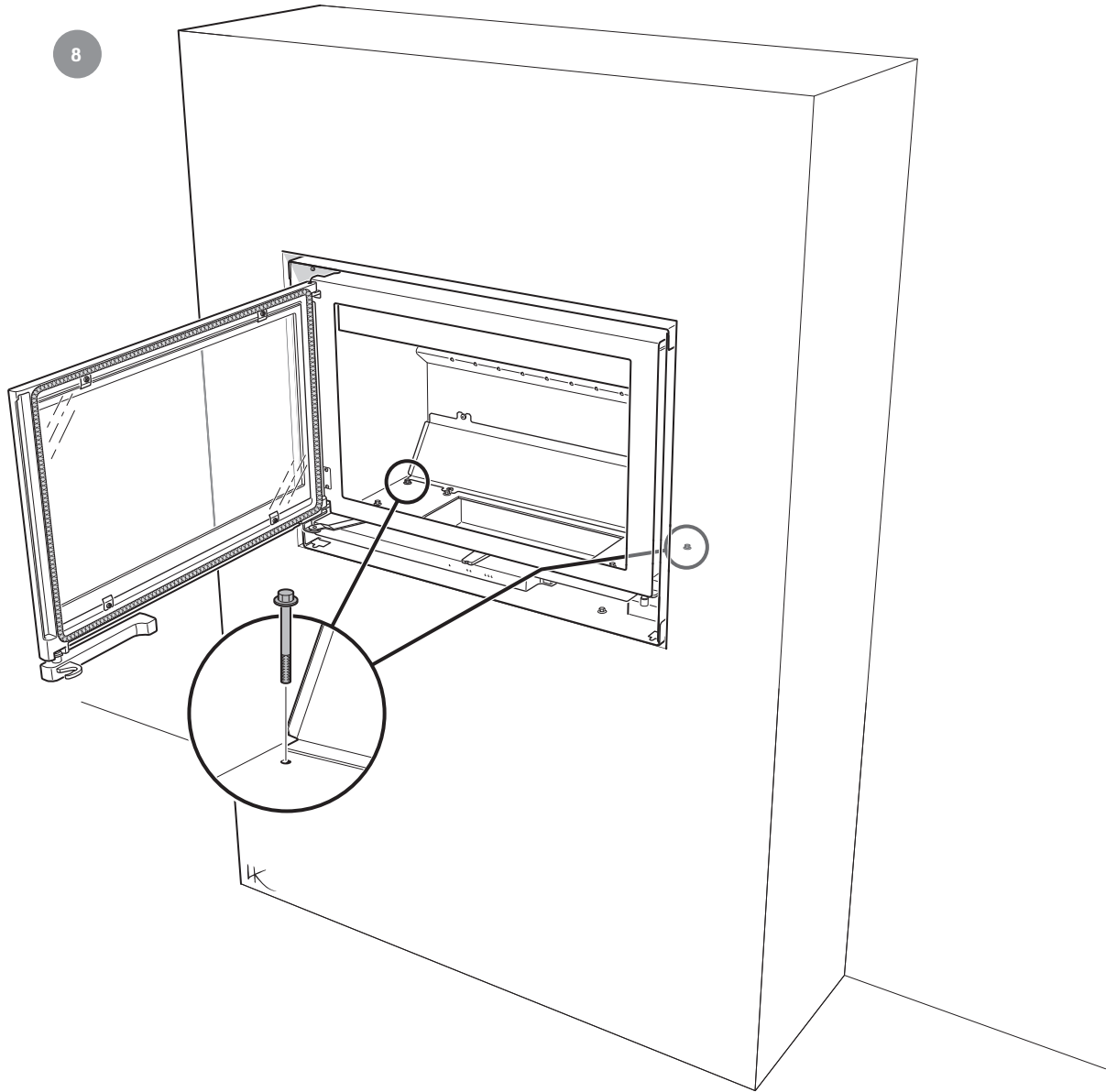

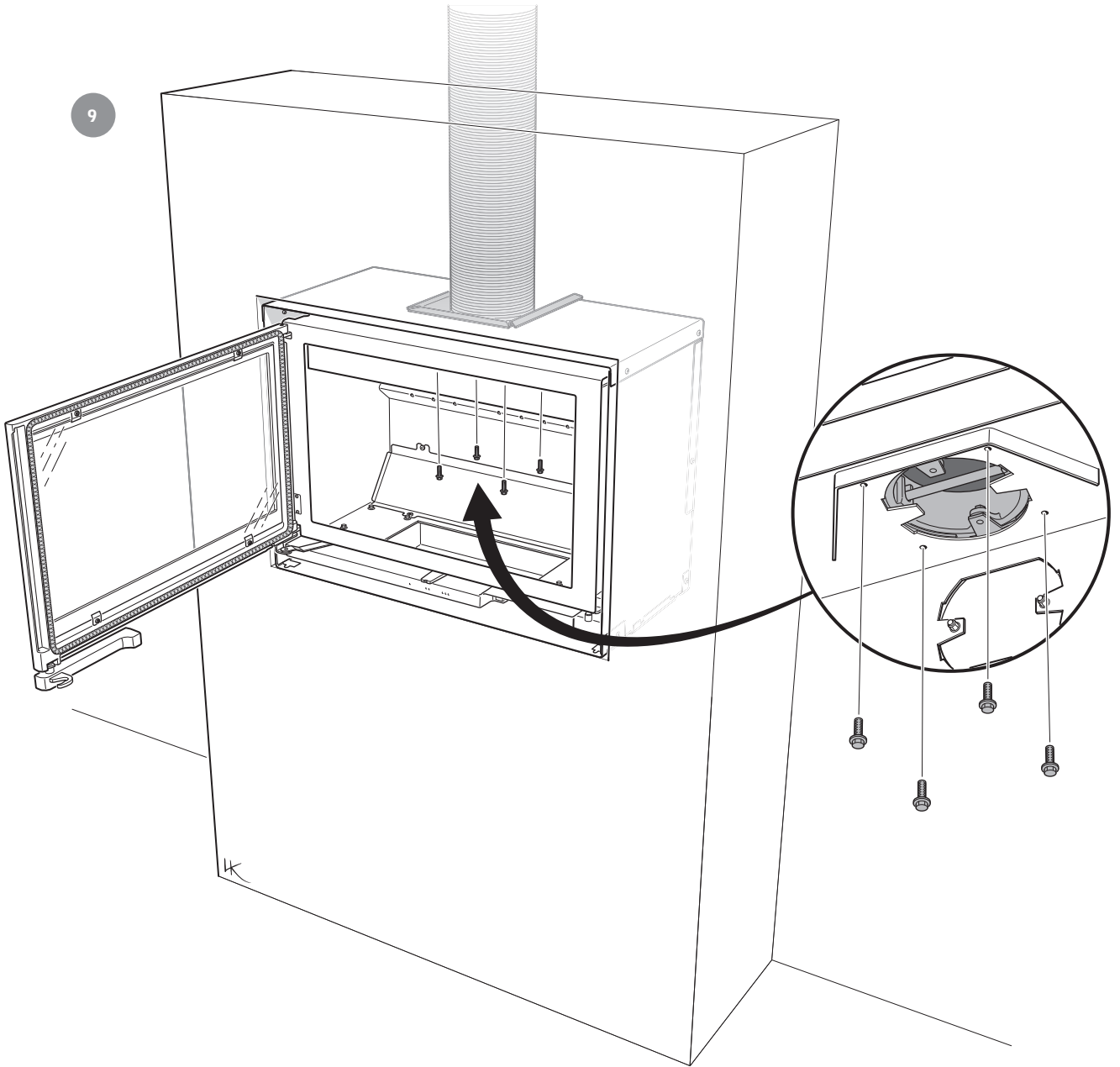



10

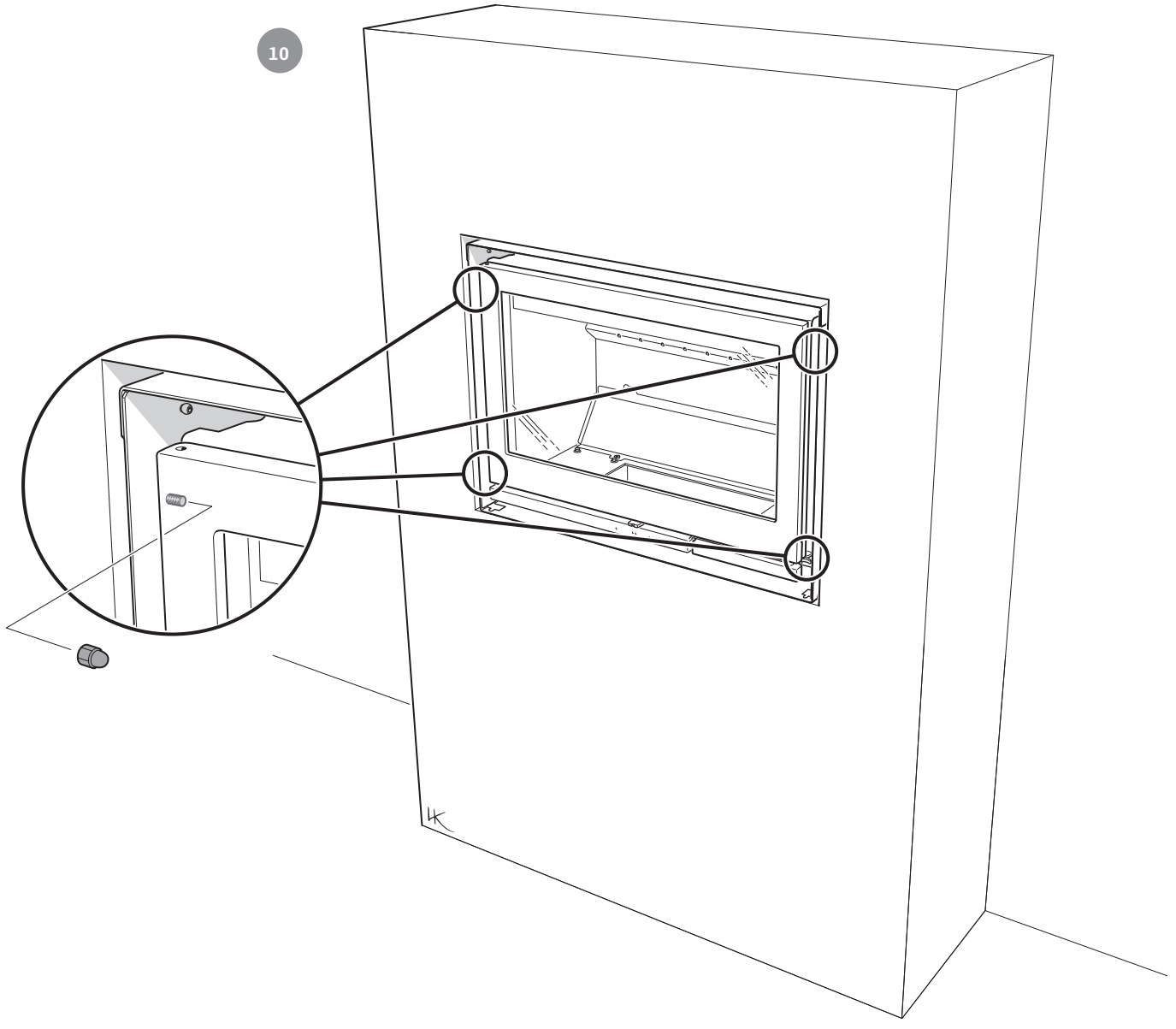



11

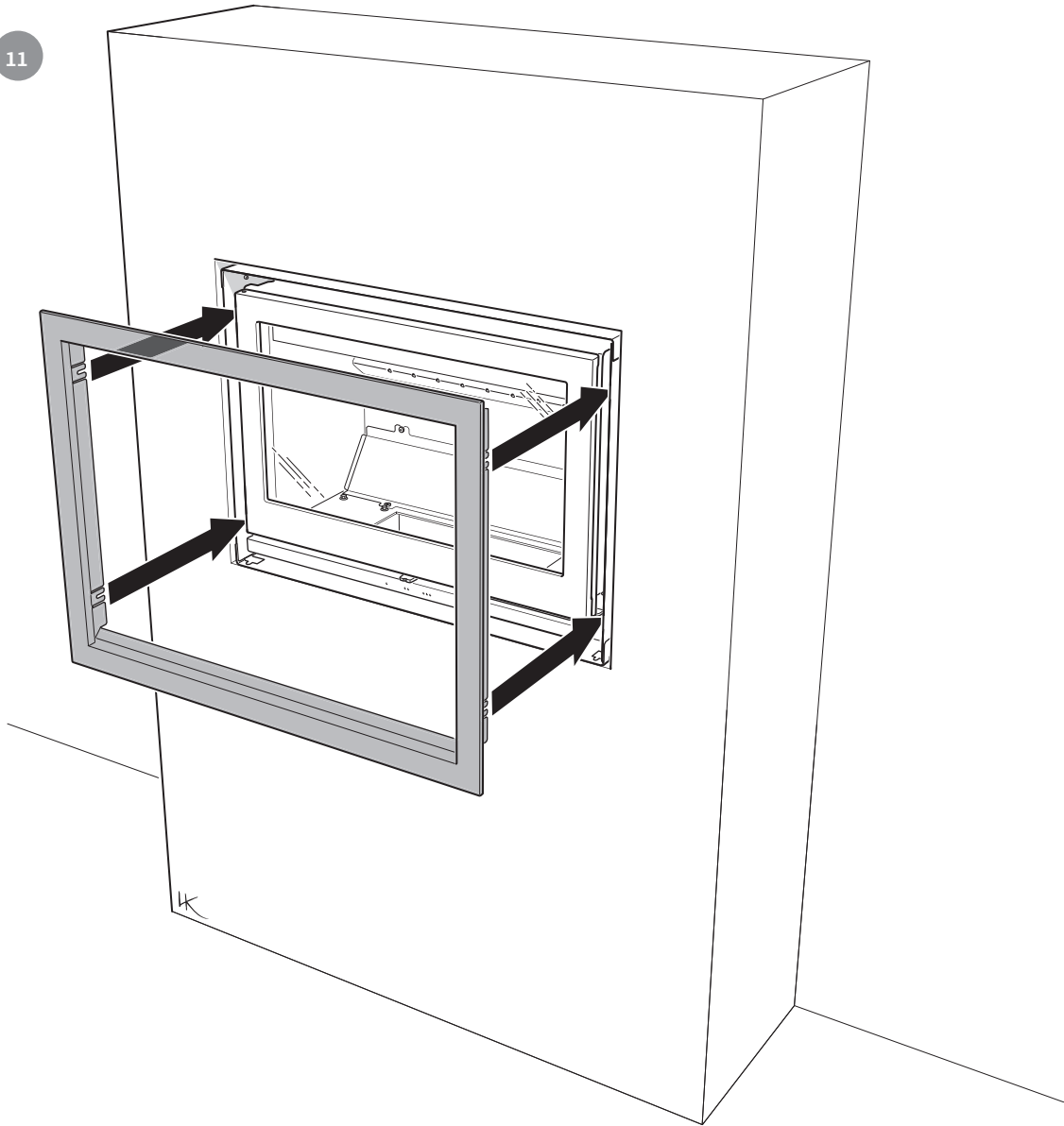



12

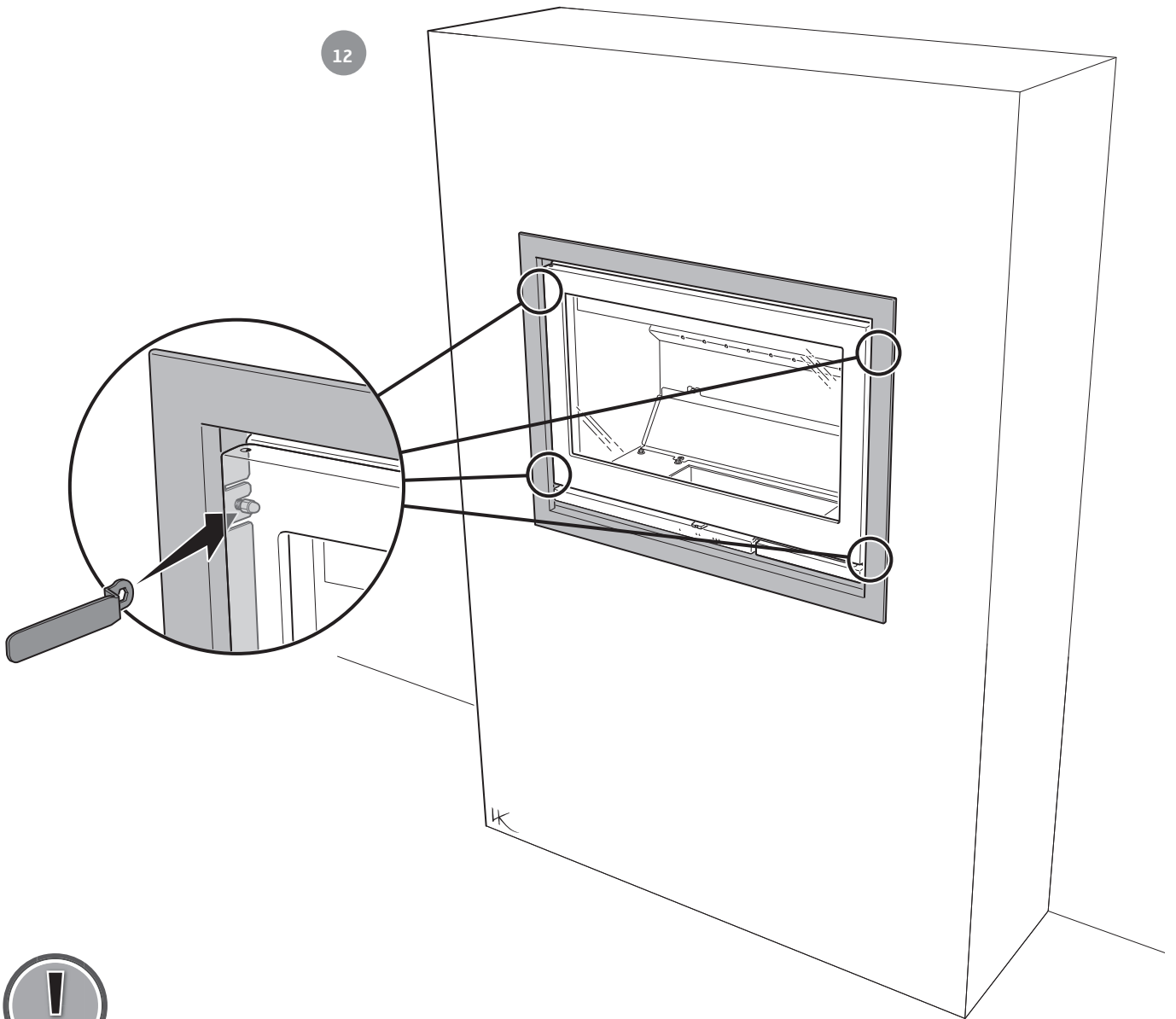

- SE** Återmontera de invändiga delarna i omvänd ordning.
- NO** Sett de innvendige delene tilbake på plass i motsatt rekkefølge.
- FR** Remontez les éléments intérieurs dans l'ordre inverse.
- GB** Reinstall the internal components in reverse order.
- DK** Monter de indvendige dele igen i omvendt rækkefølge.
- FI** Asenna sisäosat päinvastaisessa järjestyksessä.
- IT** Rimontare i componenti interni nell'ordine inverso.
- NL** Monteer de inwendige onderdelen in omgekeerde volgorde terug.

